

Heat Shrinkable Male Crimp Terminal Connectors

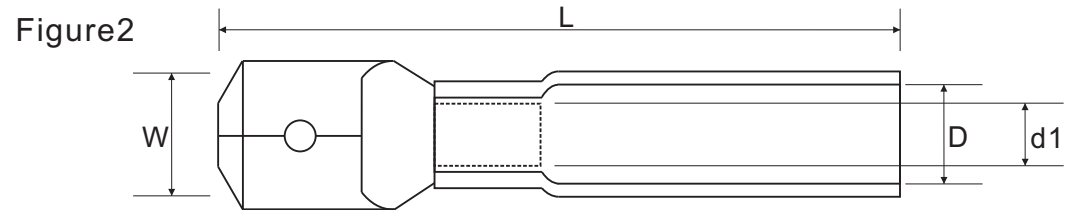
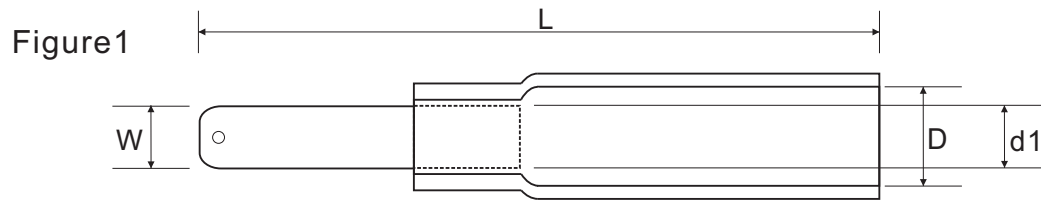

Note:
 Figure 1 - TAB: 2.8mm
 Figure 2 - TAB: 4.8mm , 6.4mm

Shrinking Temperature: $\cong 150^{\circ}\text{C}$
 Operating Temperature: $-40^{\circ}\text{C} \sim 120^{\circ}\text{C}$
 Shrinking Ratio: 3:1
 Terminal Body: Copper
 Insulation: PE
 Plating: Tin

Best.-Nr.	Typ	Wire Range mm ² /Awg	Tab Size (mm)	DIMENSION				COLOR
				W (mm)	L (mm)	D ϕ (mm)	d1 ϕ (mm)	
				± 0.05	± 0.1	± 1.0	± 0.3	
73 96 82	251028G	0.5~1.5mm ² 22-16AWG	2.8 x 0.5	2.75	27.0	4.8	1.7	RED
73 97 19	251128G		2.8 x 0.8	2.75	27.0	4.8	1.7	
73 97 48	2510475G		4.8 x 0.5	4.75	29.0	4.8	1.7	
73 98 05	2511475G		4.8 x 0.8	4.75	29.0	4.8	1.7	
73 85 23	2510635G		6.4 x 0.8	6.35	30.0	4.8	1.7	
73 99 23	2520475G	1.5~2.5mm ² 16-14AWG	4.8 x 0.5	4.75	29.0	5.8	2.3	BLUE
73 60 13	2521475G		4.8 x 0.8	4.75	29.0	5.8	2.3	
73 85 37	2520635G		6.4 x 0.8	6.35	30.0	5.8	2.3	
73 60 37	2530475G	4~6mm ² 10-12AWG	4.8 x 0.5	4.75	32.0	6.8	3.4	YELLOW
73 60 62	2531475G		4.8 x 0.8	4.75	32.0	6.8	3.4	
73 87 02	2530635G		6.4 x 0.8	6.35	35.5	6.8	3.4	