

Heat Shrinkable Female Crimp Connectors

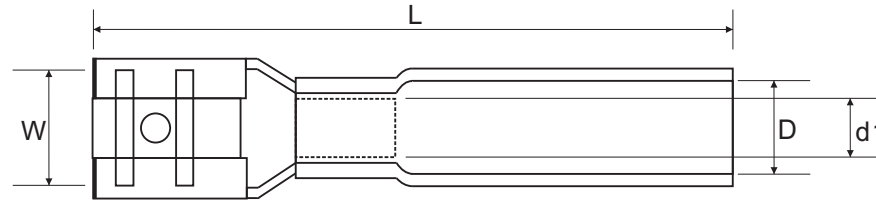

Shrinking Temperature: $\geq 150^{\circ}\text{C}$
 Operating Temperature: $-40^{\circ}\text{C} \sim 120^{\circ}\text{C}$
 Shrinking Ratio: 3:1
 Terminal Body: Copper
 Insulation: PE
 Plating: Tin

Best.-Nr.	Typ	Wire Range mm ² /Awg	Suitable connect TAB	DIMENSION				COLOR
				W (mm)	L (mm)	D ϕ (mm)	d1 ϕ (mm)	
				± 0.1	± 1.0	± 0.3	± 0.2	
73 60 87	241032M	0.5~1.5mm ² 22-16AWG	2.8 x 0.5	3.2	28.0	4.8	1.7	RED
73 61 09	241132M		2.8 x 0.8	3.2	28.0	4.8	1.7	
73 61 34	241050M		4.8 x 0.5	5.0	28.0	4.8	1.7	
73 61 59	241150M		4.8 x 0.8	5.0	28.0	4.8	1.7	
73 89 32	241066M		6.4 x 0.8	6.6	30.0	4.8	1.7	
73 61 83	242032M	1.5~2.5mm ² 16-14AWG	2.8 x 0.5	3.2	28.0	5.8	2.3	BLUE
73 62 07	242132M		2.8 x 0.8	3.2	28.0	5.8	2.3	
73 62 28	242050M		4.8 x 0.5	5.0	28.0	5.8	2.3	
73 62 51	242150M		4.8 x 0.8	5.0	28.0	5.8	2.3	
73 89 60	242066M		6.4 x 0.8	6.6	30.0	5.8	2.3	
73 62 77	242082M		8.0 x 0.8	8.2	32.0	5.8	2.3	
73 63 05	243050M	4~6mm ² 10-12AWG	4.8 x 0.5	5.0	33.0	6.8	3.4	YELLOW
73 63 32	243150M		4.8 x 0.8	5.0	33.0	6.8	3.4	
73 89 81	243066M		6.4 x 0.8	6.6	35.5	6.8	3.4	
73 63 59	243082M		9.5 x 1.2	10.0	40.0	6.8	3.4	