

Steckzungen

Masse im Steckbereich
DIN 46342, Teil 1

Languettes

Dimensions zone d'emboîtement selon
DIN 46342, partie 1

Tabs

Dimensions in the tab sector
DIN 46342, part 1

2,8 mm

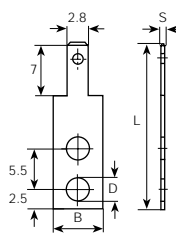
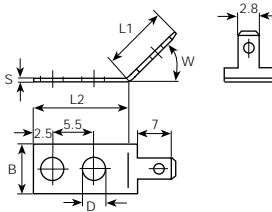
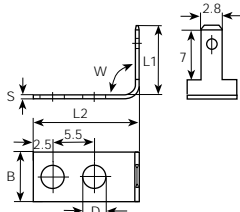
	øD mm	B mm	L mm	S mm			Werkstoff Matière Material	Stand- Packg.	Artikel-Nr. Numéro d'article Part-No.
	3	6.5	21.5	0.5			MS	1000	3778T05.6()
	3	6.5	21.5	0.8			MS	1000	3778T08.6()
	3	5	19	0.5			MS	1000	3778U05.6()
	3	5	19	0.8			MS	1000	3778U08.6()
<div style="background-color: black; color: white; padding: 2px; display: inline-block;">45°</div> 	øD mm	B mm	L1 mm	L2 mm	W	S mm	Werkstoff Matière Material	Stand- Packg.	Artikel-Nr. Numéro d'article Part-No.
	3	6.5	8.7	12.5	45°	0.5	MS	1000	3778T4505.6()
	3	6.5	8.7	12.5	45°	0.8	MS	1000	3778T4508.6()
	3	5	8.2	10.5	45°	0.5	MS	1000	3778U4505.6()
	3	5	8.2	10.5	45°	0.8	MS	1000	3778U4508.6()
<div style="background-color: black; color: white; padding: 2px; display: inline-block;">90°</div> 	øD mm	B mm	L1 mm	L2 mm	W	S mm	Werkstoff Matière Material	Stand- Packg.	Artikel-Nr. Numéro d'article Part-No.
	3	6.5	8.7	12.5	90°	0.5	MS	1000	3778T9005.6()
	3	6.5	8.7	12.5	90°	0.8	MS	1000	3778T9008.6()
	3	5	8.2	10.5	90°	0.5	MS	1000	3778U9005.6()
	3	5	8.2	10.5	90°	0.8	MS	1000	3778U9008.6()

Steckverteiler

Masse im Steckbereich
DIN 46342, Teil 1

Raccords mixtes

Dimensions zone d'emboîtement selon
DIN 46342, partie 1

Multi-connectors

Dimensions in the tab sector
DIN 46342, part 1

für Steckzungen
pour languettes - 2,8x0,5
for tabs

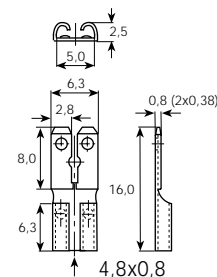
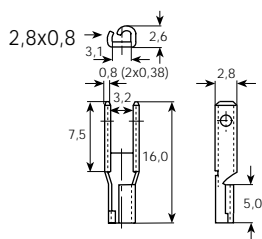
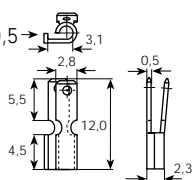

Artikel-Nr.
Numéro d'article
Part-No. → 378105.6() MS

Stand-Packg.
1000

378108.6() MS

2.8x0.8 / 2.8x0.8
1000

3829C.67 MS sn

siehe Seite
voir page
see page | 336