

**MiniDIN-Steckverbinder**, Leiterplattenmontage (180°)

**MiniDIN-connector**, PCB mounting top entry (180°)

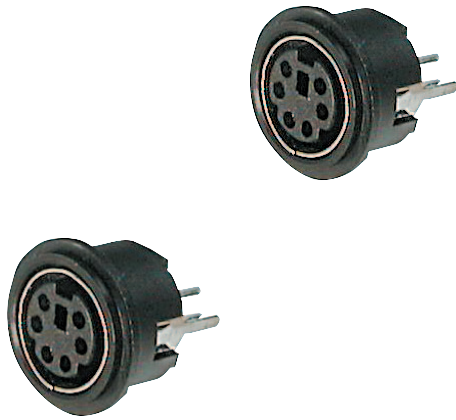

**Isolierkörper**  
PBT, 30% Glasfaser verstärkt

**Strombelastbarkeit**  
2A DC

**Nennspannung**  
12V DC

**Kontaktwiderstand**  
30mΩ max

**Durchschlagsspannung**  
500V AC / 1 Minute

**Isolationswiderstand**  
500MΩ min. bei 500V DC

**Temperaturbereich**  
-25°C - +85°C

**Insulator**  
PBT, 30% glasfiber reinforced

**Current rating**  
2A DC

**Current voltage**  
12V DC

**Contact resistance**  
30mΩ max.

**Dielectric strength**  
500V DC / 1 minute

**Insulation resisatance**  
500MΩ min. at 500V DC

**Operating temperature**  
-25°C - +85°C

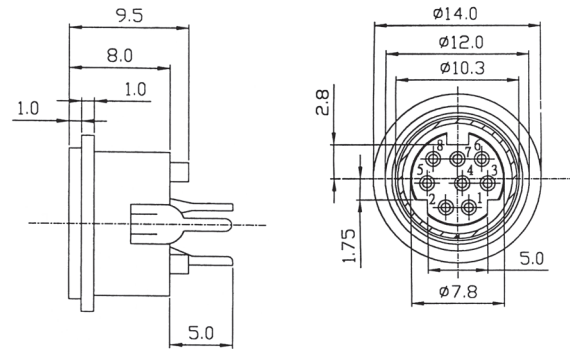

Bestellcode : **A** - **DIO** - **TOP** / **x**  
Ordercode :

Bitte „x“ durch die unten geeignete Option ersetzen  
Please replace „x“ with appropriate option listed below

1.

**1.** **No. of contacts**  
03, 04, 05, 06, 08

**Polzahl**  
03, 04, 05, 06, 08

D-Sub / Hoods  
Centronics

Multiflex

Modular

USB

Switches

Powercords  
Powersockets

MiniDIN

DIN4161x  
Hardmetric

Sockets + Strips  
Jumper