

A

B

C

D

E

F

G

H

1

2

3

4

5

6

Maximum Electric Rating: 600V
 Maximum Electric Current
 22-16AWG/0.5-1.5mm²: 19A
 16-14AWG/1.5-2.5mm²: 27A
 12-10AWG/4-6mm²: 48A
 Shrinking Temperature: $\geq 150^{\circ}\text{C}$
 Operating Temperature: $-40^{\circ}\text{C} \sim 120^{\circ}\text{C}$
 Shrinking Ratio: 3:1
 Terminal Body: Copper
 Insulation: PE
 Plating: Tin

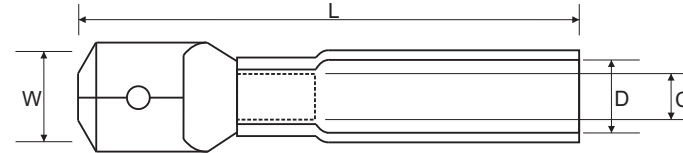

Wire Range mm ² /Awg	Item No.	Tab Size mm	Dimension (mm)				Insulation Color
			W	L	D	C	
0.5~1.5mm ² 22-16AWG	631638SEL	6.3 x 0.8	6.3	30	4.5	1.7	Red
1.5~2.5mm ² 16-14AWG	635638SEL	6.3 x 0.8	6.3	31.8	5.5	2.5	Blue
4~6mm ² 10-12AWG	633638SEL	6.3 x 0.8	6.3	35.7	6.7	3.4	Yellow

Heat Shrink Male Disconnect Terminal