

A B C D E F G H

Maximum Electric Rating: 600V
 Maximum Electric Current
 22-16AWG/0.5-1.5mm²: 19A
 16-14AWG/1.5-2.5mm²: 27A
 12-10AWG/4-6mm²: 48A
 Shrinking Temperature: ≥150°C
 Operating Temperature: -40°C ~120°C
 Shrinking Ratio: 3:1
 Terminal Body: Copper
 Insulation: PE
 Plating: Tin

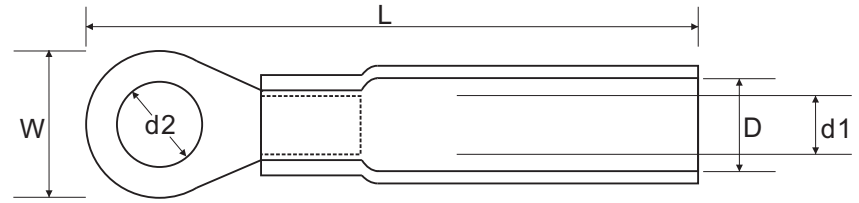

| Wire Range mm ² /Awg | Item No. | Stud Size | | Dimension (mm/inch) | | | | Insulation Color |
|------------------------------------|------------|-----------|------|---------------------|------|-----|-----|---------------------|
| | | Stud | d2 | W | L | D | d1 | |
| 0.5~1.5mm ² 22-16AWG | 311043SSEL | #8 | 4.2 | 6.6 | 27 | 4.3 | 1.7 | Red |
| | 311053SSEL | #10 | 5.2 | 8 | 29 | | | |
| | 311064SSEL | 1/4 | 6.3 | 11.6 | 35 | | | |
| | 311084SEL | 5/16 | 8.4 | 11.6 | 33.8 | | | |
| | 311010SEL | 3/8 | 10.5 | 13.6 | 39 | | | |
| 1.5~2.5mm ² 16-14AWG | 315043SSEL | #8 | 4.2 | 6.6 | 27 | 5 | 2.3 | Blue |
| | 315053SSEL | #10 | 5.2 | 8.6 | 29.3 | | | |
| | 315064SEL | 1/4 | 6.3 | 12 | 36.7 | | | |
| | 315084SEL | 5/16 | 8.3 | 12 | 34.8 | | | |
| | 315010SEL | 3/8 | 10.5 | 13.6 | 39.2 | | | |
| 4~6mm ² 10-12AWG | 313043SSEL | #8 | 4.2 | 7.2 | 34.6 | 6.7 | 3.5 | Yellow |
| | 313053SEL | #10 | 5.2 | 9.6 | 39.2 | | | |
| | 313064SSEL | 1/4 | 6.3 | 12 | 43.2 | | | |
| | 313084SEL | 5/16 | 8.2 | 15 | 44.6 | | | |
| | 313010SEL | 3/8 | 10.4 | 15 | 44 | | | |

Heat Shrinkable Ring connector Series