

THIS DRAWING IS UNPUBLISHED.

RELEASED FOR PUBLICATION

© COPYRIGHT

ALL RIGHTS RESERVED.

LOC DIST

REVISIONS

P	LTR	DESCRIPTION	DATE	DWN	APVD
		AB6 REVISED PER ECO-11-005140	01APR11	RK	HMR

CIRCUIT IDENTIFICATION

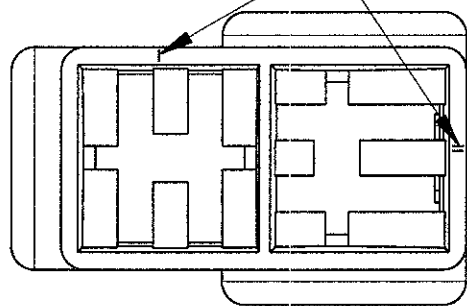

TYPICAL CAVITY FOR FASTIN-FASTON CONN. .250" SR. TAB CTC

SECTION A-A

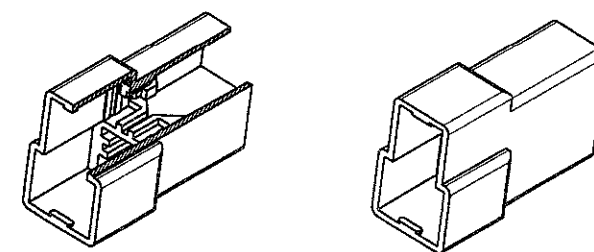
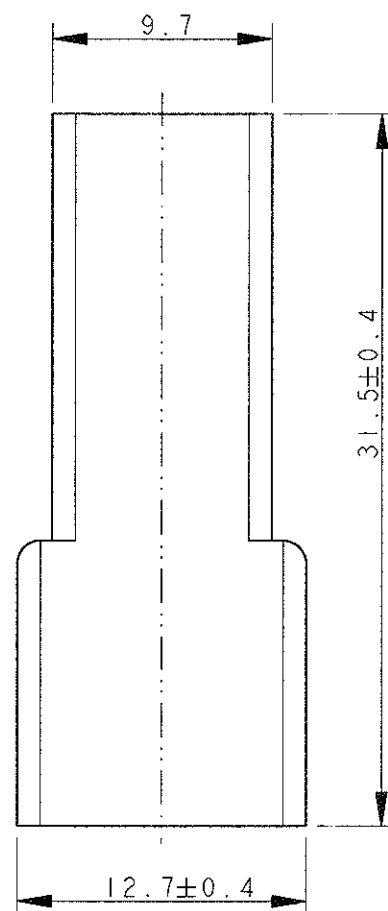
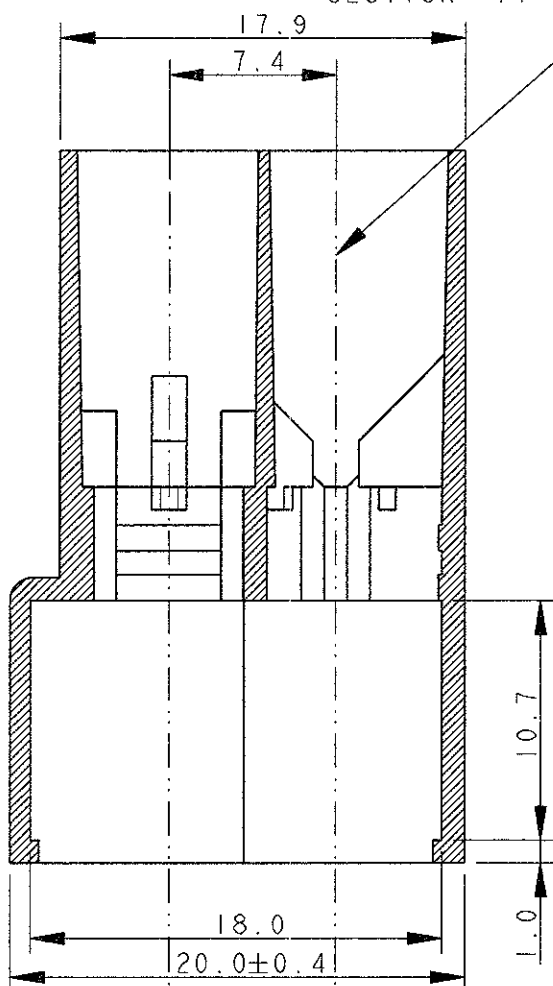

SCALE 1:1

2 OBSOLETE PARTS: OBSOLETE CIS STREAMLINING PER D.RENAUD/D.SINISI

2 OBSOLETE

OBSOLETE

NOTES	COLOUR	MATERIAL	PART NUMBER	REV
	BLACK	POLYAMIDE 6.6	0-180908-5	AB
	YELLOW		0-180908-4	AB
	BLUE		0-180908-3	AB
	GREEN		<del>0-180908-2</del>	AB
	RED		0-180908-1	AB
	NATURAL	NYLON 606 ZYTEL 101L	0-180908-0	AB
	BLACK		<del>1-180908-5</del>	O
	YELLOW		1-180908-4	AB
	GREEN		1-180908-2	AB
	NATURAL		1-180908-0	AB

1 ALTERNATIVE SHAPE : ACCEPTED ONE RETENTION RIB FOR THE TOTAL LENGTH OF THE HSG.

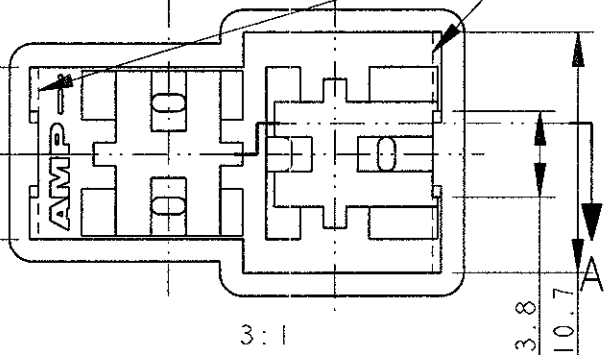

DOWNSIDE: H. YAALI 08JUL2002		TE Connectivity	
CHECKED: C. TARTARI			
APPROVED: -		NAME: FASTIN-FASTON* Connector, .250" sr. TAB HOUSING 2 WAY	
DIMENSIONS: mm		SIZE: A3	RESTRICTED TO: -
TOLERANCES UNLESS OTHERWISE SPECIFIED:		CAGE CODE: 00779	DRAWING NO: C-180908
0 PLC ±-	FINISH SEE TABLE	SCALE 3:1 SHEET 1 OF 1 REV AB6	
1 PLC ±0.3			
2 PLC ±-			
3 PLC ±-			
4 PLC ANGLES ±2°			
MATERIAL SEE TABLE	WEIGHT: 2.3 g	CUSTOMER DRAWING	