

MUM44..
MUM46..
MUM48..

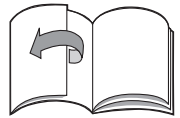

BOSCH

en Operating instructions

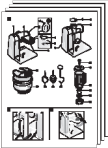

***Congratulations on the purchase of your new BOSCH appliance.
In doing so, you have opted for a modern, high-quality domestic appliance.
You can find further information about our products on our web page.***

Contents

For your safety	11
Overview	13
Operation	14
Cleaning and servicing	15
Troubleshooting	16
Application examples	16
Standard/optional accessories	17
Disposal	18
Warranty conditions	18

For your safety

Before use, read these instructions carefully in order to become familiar with important safety and operating instructions for this appliance.

If the instructions for correct use of the appliance are not observed, the manufacturer's liability for any resulting damage will be excluded. This appliance is designed for processing normal household quantities in the home or similar quantities in non-industrial applications.

Non-industrial applications include e.g. use in employee kitchens in shops, offices, agricultural and other commercial businesses, as well as use by guests in boarding houses, small hotels and similar dwellings.

Use the appliance for processing normal quantities of food for domestic use. Do not exceed permitted maximum quantities (see "Application examples").

This appliance is suitable for mixing, kneading and beating food. It must not be used for processing other objects or substances. Other applications are possible if the accessories approved by the manufacturer are used.

Use the appliance with original accessories only. When using the accessories, follow the enclosed operating instructions.

Please keep the operating instructions in a safe place. If passing on the appliance to a third party, always include the operating instructions.

General safety instructions

Electric shock risk

The appliance must not be used by children.

The appliance and its power cord must be kept away from children.

Appliances can be used by persons with reduced physical, sensory or mental capabilities or lack of experience and knowledge if they have been given supervision or instruction concerning use of the appliance in a safe way and if they understand the hazards involved.

Children shall not play with the appliance.

Connect and operate the appliance only in accordance with the specifications on the rating plate. Do not use the appliance if the power cord and/or appliance are damaged.

Always disconnect the appliance from the supply if it is left unattended and before assembling, disassembling or cleaning.

Do not place the power cord over sharp edges or hot surfaces.

To prevent injury, a damaged power cord must be replaced by the manufacturer or his customer service or a similarly qualified person. Only our customer service may repair the appliance.

Safety instructions for this appliance

Risk of injury

Risk of electric shock!

Do not insert mains plug until all preparations for working with the appliance are complete. Never immerse the base unit in liquid or hold under running water. Do not use a steam cleaner.

Do not adjust the swivel arm while the appliance is switched on.

Wait until the drive has come to a standstill.

Do not change tool/accessory until the drive is at a standstill – when the appliance is switched off, the drive continues running briefly.

Use only the rotary switch to switch the appliance on or off.

When the appliance is not in use, pull out the mains plug.

Before eliminating a fault, pull out the mains plug.

The appliance restarts following a power interruption.

Risk of injury from the rotating tools!

Keep hands clear of rotating parts. While the appliance is operating, keep fingers clear of the mixing bowl.

Do not change tools until the drive has come to a standstill – when the appliance is switched off, the drive continues running briefly.

The appliance may only be operated when the unused drives have been safeguarded with the drive covers (4, 7).

Risk of injury from sharp blades/rotating drive!

Never place fingers in the attached blender!

Never assemble blender on the base unit. Do not remove/attach the blender until the drive is at a standstill!

Operate the assembled blender only and with the lid attached.

Do not touch blender blades with bare hands.

Risk of scalding!

If processing hot liquids, steam escapes through the funnel in the lid.

Add a max. 0.5 litres of hot or frothing liquid.

Important!

Use only one tool or accessory at any one time.

The operating instructions describe several models, see also overview of models (Fig. 11). The appliance requires no maintenance.

Overview

Please fold out the illustrated pages.

Fig. A

Base unit

1 Release button

2 Swivel arm

(see "Operating positions")

3 Rotary switch

0/off = Stop

Ⓜ / P = Parking circuit

Hold rotary switch until the drive stops; tool is in the swivel position. If the drive does not move, the swivel position has already been reached.

Settings 1–4 = Operating speed

Setting 1 = Minimum speed – slow

Setting 4 = Maximum speed – fast

If the power is interrupted, the appliance remains switched on and restarts when the power is restored.

4 Drive cover

To remove the drive cover, rotate until the locking feature has been released.

5 Drive for

– **continuous-feed shredder ***

– **citrus press ***

– **grain mill ***

When not in use, attach the drive cover.

6 Drive for

– **tools (stirrer, whisk, kneading hook)**

– **stirring tool of the ice-cream maker ***

– **folded down or up for mincer ***

7 Blender drive cover

8 Drive for

– **blender**

– **multi-blender**

When not in use, attach the blender drive cover.

9 Cord store (Fig. B)

MUM 44...: Stow the cord

MUM 46../48...: Stow the cord in the cord store

Bowl with accessories

10 Mixing bowl

11 Lid

Tools

12 Stirrer

13 Whisk

14 Kneading hook with dough deflector

Blender

15 Base

16 Blade insert

17 Sealing ring

18 Blender jug

19 Lid

20 Funnel

* If an accessory is not included in the product package, it can be purchased via the trade or customer service.

Operating positions

⚠ Attention!

Before operating the appliance, attach the tool/accessory to the correct drive and in the correct position and place in the operating position according to this table.

The swivel arm must be engaged in every operating position.

Setting the operating position Fig. C

- Press the Release button and move the swivel arm.
- Move the swivel arm until it engages in the required position.

Position		
1		
2		
3		
4		
5		
6		Insert/remove whisk, stirrer or kneading hook
7		Add large quantities of ingredients

Operation



Risk of injury!

Do not insert mains plug until all preparations for working with the appliance are complete.



Attention!

Do not operate the appliance without an accessory/tool in the operating position.

Do not operate the appliance empty.

Do not expose appliance or accessories to heat sources. Parts are not microwave-safe.

- Before operating the appliance and accessories for the first time, clean thoroughly; see “Cleaning and servicing”.

Preparation

- Place the base unit on a smooth, clean surface.
- Unwind/pull out the cord (**Fig. 8**).
- Insert the mains plug.

Stirrer, whisk and kneading hook

Fig. 9

Stirrer (a)

for stirring dough, e.g. cake mixture

Whisk (b)

for whisking egg whites, cream and light dough, e.g. sponge mixture

Kneading hook (c) with dough deflector (d)

for kneading heavy dough and mixing-in ingredients that ought not be cut (e.g. raisins and chocolate chips)



Risk of injury from the rotating tools!

While the appliance is operating, keep fingers clear of the mixing bowl.

Do not change tools until the drive has come to a standstill – when the appliance is switched off, the drive continues running briefly.

The appliance may only be operated when the unused drives have been safeguarded with the drive covers.

- Set rotary switch to **P** and hold in place until the drive stops.

Note:

If the drive does not move, the swivel position has already been reached.

- Press the Release button and move the swivel arm to position 6.
- Insert the bowl. The base of the mixing bowl must be inserted into the recess of the base unit.
- Depending on the processing task, insert the stirrer, whisk or kneading hook until it locks into position. If using the kneading hook, rotate the dough deflector until the kneading hook can lock into position.
- Put the ingredients to be processed into the bowl.
- Press the Release button and move the swivel arm to position 1.
- Attach the cover.
- Set the rotary switch to the desired setting.

Adding more ingredients

- Switch off the appliance with the rotary switch.
 - Set rotary switch to **P** and hold in place until the drive stops.
 - Remove lid.
 - Press the Release button and move the swivel arm to position 7.
 - Add ingredients
- or
- add more ingredients through the feed tube in the cover.

After using the appliance

- Switch off the appliance with the rotary switch.
- Set rotary switch to **P** and hold in place until the drive stops.
- Remove mains plug.
- Remove lid.
- Press the Release button and move the swivel arm to position 6.
- Take the tool out of the drive.
- Remove the bowl.
- Clean all parts, see “Cleaning and servicing”.

Blender

Fig. 



Risk of injury from sharp blades/rotating drive!

*Never place fingers in the attached blender!
Do not remove/attach the blender until the drive is at a standstill!*

Operate the assembled blender only and with the lid attached.



Risk of scalding!

If processing hot liquids, steam escapes through the funnel in the lid.

Add a max. 0.5 litres of hot or frothing liquid.

Warning!

Blender may be damaged.

Do not process deep-frozen ingredients (except ice cubes). Do not operate when empty.

Warning!

Processing liquids in the glass blender: maximum setting 3. Add a max. 0.5 litres of hot or frothing liquid.

- Press the Release button and move the swivel arm to position 3.
- Remove the blender drive cover.
- Attach the blender jug (mark on the base of the blender jug on the mark on the base unit) and rotate as far as possible in an anti-clockwise direction (Fig. -4/5).
- Add ingredients.
Maximum capacity of liquid for plastic blender = 1 litre, for glass blender = 0.75 litres, frothing or hot liquid maximum 0.5 litres
Optimal processing capacity – solids = 50–100 g.
- Attach lid and press firmly.
While working, always hold the lid firmly with one hand. However, do not place hand over the refill opening!
- Set the rotary switch to the desired setting.

Adding more ingredients Fig.

- Switch off the appliance with the rotary switch.
- Remove the cover and add ingredients
or
- remove the funnel and gradually add solid ingredients through the feed tube
or
- pour liquid through the funnel.

After using the appliance

- Switch off the appliance with the rotary switch.
- Remove mains plug.
- Rotate the blender in a clockwise direction and remove.

Tip: It is recommended to clean the blender immediately after use.

Cleaning and servicing

Attention!

*Do NOT use abrasive cleaning agents.
Surfaces may be damaged.*

Cleaning the base unit



Risk of electric shock!

Never immerse the base unit in water or place under running water.

- Remove mains plug.
- Wipe the base unit with a damp cloth.
- If required, use a little detergent.
- Then dry the base unit.

Cleaning the bowl and accessories

All parts are dishwasher-safe.

Do not wedge plastic parts in the dishwasher as they could warp.

Cleaning the blender



Risk of injury from sharp blades!

*Do not touch blender blades with bare hands.
The blender can be disassembled for cleaning.*

Warning!

Do NOT use abrasive cleaning agents.

The blade insert is not dishwasher-safe.

Clean the blade insert under running water only.

Tip: After processing liquids, it is often sufficient to clean the blender without disassembling it. Pour a little water and washing-up liquid into the attached blender. Switch on the blender for several seconds (if the appliance features quick-action operation, select setting M). Pour out the water and rinse out the blender with clear water.

Taking the blender apart

Fig. 14

- Rotate the base of the blender jug in a clockwise direction and remove.
- Upon the flanks, rotate the blade insert in an anti-clockwise direction. The blade insert is released.
- Take blade insert out and remove sealing ring.

Putting the blender together

Fig. 15

**Risk of injury!**

Never assemble blender on the base unit.

- Apply sealing ring on blade insert.
- Insert blade insert from below into blender jug.
- Tighten the blade insert with the aid of the blender jug base.
- Tighten the base of the blender jug in an anti-clockwise direction.

Troubleshooting

If the appliance malfunctions, please consult our customer service.

Application examples**Whipped cream**

100 g–600 g

- Whip cream with the whisk for 1½ to 4 minutes at setting 4 (depending on the quantity and properties of the cream).

**Egg white**

1 to 8 egg whites

- Beat egg white with the whisk for 4 to 6 minutes at setting 4.

**Sponge mixture***Basic recipe*

2 eggs

2–3 tbs. hot water

100 g sugar

1 packet of vanilla sugar

70 g flour

70 g cornflour baking powder (if required)

- Beat the ingredients (except flour and cornflour) with the whisk for approx. 4–6 minutes at setting 4 until frothy.
- Rotate switch to setting 2 and spoon in the sifted flour and cornflour within approx. ½ to 1 minute.

**Maximum quantity:** 2 x basic recipe**Cake mixture***Basic recipe*

3–4 eggs

200–250 g sugar

1 pinch of salt

1 packet of vanilla sugar or peel from ½ lemon

200–250 g butter (room temperature)

500 g flour

1 packet of baking powder

1/8 l milk

- Mix all ingredients with the stirrer for approx. ½ minute at setting 1, then for approx. 3–4 minutes at setting 3.

Maximum quantity: 1.5–2 x basic recipe**Short pastry***Basic recipe*

125 g butter (room temperature)

100–125 g sugar

1 egg

1 pinch of salt

A little lemon peel or vanilla sugar

250 g flour

Baking powder if required

- Process all ingredients for approx. ½ minute at setting 1, then for approx. 2–3 minutes with the stirrer (setting 3) or kneading hook (setting 2).

Maximum quantity: 2 x basic recipe**Yeast dough***Basic recipe*

500 g flour

1 egg

80 g fat (room temperature)

80 g sugar

200–250 ml lukewarm milk

25 g fresh yeast or 1 packet of dried yeast

Peel of ½ lemon

1 pinch of salt

- Mix all ingredients with the kneading hook for approx. ½ minute at setting 1, then for approx. 3–6 minutes at setting 2.

Maximum quantity: 1.5 x basic recipe**Mayonnaise**

2 eggs

2 tsp. mustard

¼ l oil

2 tbs. lemon juice or vinegar

1 pinch of salt

1 pinch of sugar

Ingredients must be at the same temperature.



- Process the ingredients (except the oil) in the blender for several seconds at setting 2.
- Switch the blender to setting 4 and slowly pour the oil through the funnel and mix until the mayonnaise emulsifies.

Standard/optional accessories

Other accessories enclosed with the packaging (see enclosed overview of models, **Fig. II**) are described in the separate operating instructions. Enclosed accessories/optional accessories can also be purchased separately.

The accessories for the MUM 45.. appliance are also suitable for the MUM 44../46../48.. appliances.

Fig. II

Plastic mixing bowl (MUZ4KR3)

Up to 1 kg of flour plus ingredients can be processed in the bowl.

Stainless steel stirring bowl (MUZ4ER2)

Up to 1 kg of flour plus ingredients can be processed in the bowl.

Plastic blender attachment (MUZ4MX2)

For blending drinks, for pureeing fruit and vegetables, for preparing mayonnaise, for cutting fruit, nuts, for crushing ice cubes.

Glass blender attachment (MUZ4MX3)

For blending drinks, for pureeing fruit and vegetables, for preparing mayonnaise, for cutting fruit, nuts, for crushing ice cubes.

Mini processor (MUZ4MM3)

For chopping herbs, vegetables, apples and meat, for shredding carrots, radishes and cheese, for grating nuts and cooled chocolate.

Continuous-feed shredder (MUZ4DS3)

For slicing cucumbers, cabbage, kohlrabi, radish; for shredding carrots, apples and celery, red cabbage, cheese and nuts; for grating hard cheese, chocolate and nuts.

Chipper disc (MUZ45PS1)

For the continuous-feed shredder MUZ4DS3. For slicing raw potatoes for chips.

Asiatic vegetables disc (MUZ45AG1)

For the continuous-feed shredder MUZ4DS3. Slices fruit and vegetables into fine strips for Asian vegetable dishes.

Grating disc coarse (MUZ45RS1)

For the continuous-feed shredder MUZ4DS3. For grating raw potatoes, e.g. for potato pancakes or dumplings.

Potato fritter disc (MUZ45KP1)

For the continuous-feed shredder MUZ4DS3. For grating raw potatoes for rostis and potato fritters, for cutting fruit and vegetables into thick slices.

Citrus press (MUZ4ZP1)

For squeezing oranges, lemons and grapefruits.

Mincer (MUZ4FW3)

For cutting fresh meat for steak tartare or meat loaf.

Perforated disc set (MUZ45LS1)

For the mincer MUZ4FW3. Fine disc (3 mm) for pasties and spreads, coarse disc (6 mm) for sausages and bacon.

Viennese whirl attachment (MUZ45SV1)

For the mincer MUZ4FW3. With metal template for 4 different pastry moulds.

Grater attachment (MUZ45RV1)

For the mincer MUZ4FW3. For grating nuts, almonds, chocolate and dried bread rolls.

Juicer attachment (MUZ45FV1)

For the mincer MUZ4FW3. For pressing soft fruit, (except raspberries), tomatoes and rose hips, to a pulp. At the same time e.g. currants are automatically stemmed and pitted.

Accessories holder (MUZ4ZT1)

For the storage of accessories such as kneading hook, whisk, stirrer, slicing, shredding and grating disc.

Mill with conical grinder made of steel (MUZ4GM3)

For all grain types except maize, also oil seeds, dried mushrooms and herbs.

Ice-cream maker (MUZ4EB1)

For the preparation of up to 550 g of ice cream per cycle and container.

Disposal



This appliance has been identified in accordance with the European directive 2012/19/EG on Waste Electrical and Electronic Equipment – WEEE.

The Directive paves the way for effective EU-wide withdrawal and utilization of waste appliances.

Please ask your dealer or inquire at your local authority about current means of disposal.

Warranty conditions

The guarantee conditions for this appliance are as defined by our representative in the country in which it is sold. Details regarding these conditions can be obtained from the dealer from whom the appliance was purchased.

The bill of sale or receipt must be produced when making any claim under the terms of this guarantee.

Kundendienst – Customer Service

DE Deutschland, Germany

BSH Hausgeräte Service GmbH
Zentralwerkstatt
für kleine Hausgeräte
Trautskirchener Strasse 6 – 8
90431 Nürnberg

Online Auftragsstatus, Filterbeutel-
Konfigurator und viele weitere
Infos unter: www.bosch-home.de

Reparaturservice*
(Mo-Fr: 8.00-18.00 erreichbar)
Tel.: 01801 33 53 03
[mailto:cp-servicecenter@
bshg.com](mailto:cp-servicecenter@bshg.com)

Ersatzteilbestellung*
(365 Tage rund um die Uhr erreichbar)
Tel.: 01801 33 53 04
Fax: 01801 33 53 08
<mailto:spareparts@bshg.com>
*) 3,9 Ct./Min. aus dem Festnetz,
Mobilfunk max. 0,42 €/Min.

AE United Arab Emirates, الإمارات العربية المتحدة

BSH Home Appliances FZE
Round About 13,
Plot Nr MO-0532A
Jebel Ali Free Zone – Dubai
Tel.: 04 881 4401
<mailto:service-uae@bshg.com>
www.bosch-home.com/ae

AL Republika e Shqiperise, Albania

AERTECH SH.P.K.
Rr. Sami Frasheri
Pallati i Aviacionit te vjetar
Shkalla 1, Hyrja 2
Tirana
Tel.: 067 337 4106
Fax: 071 733 222
<mailto:volina@ovi.com>

AT Österreich, Austria

BSH Hausgeräte
Gesellschaft mbH
Werkskundendienst
für Hausgeräte
Quellenstrasse 2
1100 Wien
Tel.: 0810 550 511*
Fax: 01 605 75 51 212
[mailto:vie-stoerungsannahme@
bshg.com](mailto:vie-stoerungsannahme@bshg.com)

Hotline für Espresso-Geräte:
Tel.: 0810 700 400*
www.bosch-home.at

*innerhalb Österreichs zum Regionaltarif

AU Australia

BSH Home Appliances Pty. Ltd.
7-9 Arco Lane
HEATHERTON, Victoria 3202
Tel.: 1300 368 339
<mailto:bshau-as@bshg.com>
www.bosch-home.com.au
BA Bosna i Hercegovina,
Bosnia-Herzegovina
"HIGH" d.o.o.
Gradačanka 29b
71000 Sarajewo
Info-Line: 061 100 905
Fax: 033 213 513
<mailto:delicnanda@hotmail.com>

BE Belgique, België, Belgium

BSH Home Appliances S.A.
Avenue du Laerbeek 74
Laarbeeklaan 74
1090 Bruxelles – Brussel
Tel.: 070 222 141
Fax: 024 757 291
<mailto:bru-repairs@bshg.com>
www.bosch-home.be

BG Bulgaria

BSH Domakinski Uredi
Bulgaria EOOD
115K Tsarigradsko Chausse Blvd.
European Trade Center Building,
5th floor
1784 Sofia
Tel.: 02 892 90 47
Fax: 02 878 79 72
[mailto:informacia.servis-bg@
bshg.com](mailto:informacia.servis-bg@bshg.com)
www.bosch.home.bg

BH Bahrain, البحرين

Khalaifat Est.
P.O.BOX 5111
Manama
Tel.: 01 759 2233
<mailto:service@khalaifat.com>

BY Belarus, Беларусь

ООО "БСХ Бытовая техника"
тел.: 495 737 2961
<mailto:mok-kdhl@bshg.com>

CH Schweiz, Suisse, **Svizzera, Switzerland**

BSH Hausgeräte AG
Werkskundendienst für
Hausgeräte
Fahrdwergstrasse 80
8954 Geroldswil
[mailto:ch-info.hausgeraete@
bshg.com](mailto:ch-info.hausgeraete@bshg.com)

Service Tel.: 0848 840 040
Service Fax: 0848 840 041
<mailto:ch-reparatur@bshg.com>
Ersatzteile Tel.: 0848 880 080
Ersatzteile Fax: 0848 880 081
<mailto:ch-ersatzteil@bshg.com>
www.bosch-home.com/ch

CY Cyprus, Κύπρος

BSH Ikiakes Syskeves-Service
39, Arh. Makaaniou III Str.
2407 Egomi/Nikosia (Lefkosia)
Tel.: 77 77 807
Fax: 022 658 128
[mailto:bsh.service.cyprus@
cytanet.com.cy](mailto:bsh.service.cyprus@cytanet.com.cy)

CZ Česká Republika, **Czech Republic**

BSH domácí spotřebiče s.r.o.
Firemní servis domácích
spotřebičů
Pekařská 10b
155 00 Praha 5
Tel.: 0251 095 546
Fax: 0251 095 549
www.bosch-home.com/cz

DK Danmark, Denmark

BSH Hvidevarer A/S
Telegrafvej 4
2750 Ballerup
Tel.: 44 89 89 85
Fax: 44 89 89 86
[mailto:BSH-Service.dk@
BSHG.com](mailto:BSH-Service.dk@BSHG.com)
www.bosch-home.dk

EE Eesti, Estonia

SIMSON OÜ
Raua 55
10152 Tallinn
Tel.: 0627 8730
Fax: 0627 8733
<mailto:teenindus@simson.ee>

ES España, Spain

BSH Electrodomésticos
España S.A.
Servicio Oficial del Fabricante
Parque Empresarial PLAZA,
C/ Manfredonia, 6
50016 Zaragoza
Tel.: 902 245 255
Fax: 976 578 425
<mailto:CAU-Bosch@bshg.com>
www.bosch-home.es

FI Suomi, Finland

BSH Kodinkoneet Oy
Itälahdenkatu 18 A, PL 123
00201 Helsinki
Tel.: 0207 510 700
Fax: 0207 510 780
mailto: Bosch-Service-FI@bshg.com
www.bosch-home.fi
Lankapuhelimesta 8,28 snt/puhelu
+ 7 snt/min (alv 23%)
Matkapuhelimesta 8,28 snt/puhelu
+ 17 snt/min (alv 23%)

FR France

BSH Electroménager S.A.S.
50 rue Ardoin – BP 47
93401 SAINT-OUEN cedex
Service interventions à domicile:
01 40 10 11 00
Service Consommateurs:
0 892 698 010 (0,34 € TTC/mn)
mailto:soa-bosch-conso@bshg.com
Service Pièces Détachées et
Accessoires:
0 892 698 009 (0,34 € TTC/mn)
www.bosch-home.fr

GB Great Britain

BSH Home Appliances Ltd.
Grand Union House
Old Wolverton Road
Wolverton
Milton Keynes MK12 5PT
To arrange an engineer visit, to
order spare parts and accessories
or for product advice please visit
www.bosch-home.co.uk
or call
Tel.: 0844 892 8979*

*Calls from a BT landline will be charged at
up to 3 pence per minute. A call set-up fee
of up to 6 pence may apply.

GR Greece, Ελλάς

BSH Ikiakies Siskeves A.B.E.
Central Branch Service
17 km E.O. Athinon-Lamias &
Potamou 20
14564 Kifisia
Πανελλήνιο τηλέφωνο: 181 82
(αστική χρέωση)
www.bosch-home.gr

HK Hong Kong, 香港

BSH Home Appliances Limited
Unit 1 & 2, 3rd Floor
North Block, Skyward House
3 Sham Mong Road
Tai Kok Tsui, Kowloon
Hong Kong
Tel.: 2565 6151
Fax: 2565 6681
mailto:bshhkg.service@bshg.com
www.bosch-home.cn

HR Hrvatska, Croatia

BSH kućni uređaji d.o.o.
Kneza Branimira 22
10000 Zagreb
Tel.: 01 640 36 09
Fax: 01 640 36 03
mailto:informacije.servis-hr@
bshg.com
www.bosch-home.com/hr

HU Magyarország, Hungary

BSH Háztartási Készülék
Kereskedelmi Kft.
Háztartási gépek márkaszervize
Királyhágó tér 8-9
1126 Budapest
Hibabejelentés
Tel.: 01 489 5461
Fax: 01 201 8786
mailto:hibabejelentes@bsh.hu
Alkatrészrendelés
Tel.: 01 489 5463
Fax: 01 201 8786
mailto:alkatrészrendeles@bsh.hu
www.bosch-home.com/hu

IE Republic of Ireland

BSH Home Appliances Ltd.
Unit F4, Ballymount Drive
Ballymount Industrial Estate
Walkinstown
Dublin 12
Service Requests,
Spares and Accessories
Tel.: 01450 2655
Fax: 01450 2520
www.bosch-home.co.uk

IL Israel, ישראל

C/S/B Home Appliance Ltd.
Ullei Building
2, Hamelacha St.
Industrial Park North
71293 Lod
Tel.: 08 9777 222
Fax: 08 9777 245
mailto:csb-serv@zahav.net.il
www.bosch-home.co.il

IN India, Bhārat, भारत

BSH Customer Service Front Office
Shop No.4, Everest Grande,
Opp. Shanti Nagar Bus Stop,
Mahakali Caves Road, Andheri East
Mumbai 400093

IS Iceland

Smith & Norland hf.
Noatuni 4
105 Reykjavik
Tel.: 0520 3000
Fax: 0520 3011
www.sminor.is

IT Italia, Italy

BSH Elettrodomestici S.p.A.
Via. M. Nizzoli 1
20147 Milano (MI)
Numero verde 800 829 120
mailto:mil-assistenza@bshg.com
www.bosch-home.com/it

KZ Kazakhstan, Қазақстан

IP "Batkayev Ildus A."
B. Momysh-uly Str.7
Chymkent 160018
Tel./Fax: 0252 31 00 06
mailto:evrika_kz@mail.ru

LB Lebanon, لبنان

Tehehi, Hana & Co.
Boulevard Dora 4043 Beyrouth
P.O. Box 90449
Jdeideh 1202 2040
Tel.: 01 255 211
mailto:Info@Tehehi-Hana.com

LT Lietuva, Lithuania

Senuku prekybos centras UAB
Jonavos g. 62
44192 Kaunas
Tel.: 0372 12146
Fax: 0372 12165
www.senukai.lt

LU Luxembourg

BSH électroménagers S.A.
13-15 ZI Breedeweues
1259 Senningerberg
Tel.: 26349 300
Fax: 26349 315
mailto:lux-service.electromenager@
bshg.com
www.bosch-home.lu

LV Latvija, Latvia

General Serviss Limited
Bullu street 70c
1067 Riga
Tel.: 07 42 41 37
mailto:bt@olimpeks.lv

Elkor Serviss
Brivibas gatve 201
1039 Riga
Tel.: 067 0705 20; -36
Fax: 067 0705 24
mailto:domoservice@elkor.lv
www.servisacentrs.lv

MD Moldova

S.R.L. "Rialto-Studio"
ул. Щусева 98
2012 Кишинев
тел./факс: 022 23 81 80
mailto:bosch-md@mail.ru

ME Crna Gora, Montenegro

Elektronika komerc
Ul. Slobode 17
84000 Bijelo Polje
Tel./Fax: 050 432 575
Mobil: 069 324 812
mailto:ekobosch.servis@
t-com.me

MK Macedonia, Македонија

GORENEC
Jane Sandanski 69 lok.3
1000 Skopje
Tel.: 022 454 600
Mobil: 070 697 463
mailto:gorenece@yahoo.com

MT Malta

Oxford House Ltd.
Notabile Road
Mriehel BKR 14
Tel.: 021 442 334
Fax: 021 488 656
www.oxfordhouse.com.mt

**MV Raajjeyge Jumhooriyyaa,
Maledives**

Lintel Investments
Ma. Maadheli, Majeedhee Magu
Malé
Tel.: 0331 0742
mailto:mohamed.zuhuree@
intel.com.mv

NL Nederland, Netherlands

BSH Huishoudapparaten B.V.
Taurusavenue 36
2132 LS Hoofddorp

Storingsmelding:
Tel.: 088 424 4010
Fax: 088 424 4845
mailto:bosch-contactcenter@
bshg.com

Onderdelenverkoop:
Tel.: 088 424 4010
Fax: 088 424 4801
mailto:bosch-onderdelen@bshg.com
www.bosch-home.nl

NO Norge, Norway

BSH Husholdningsapparater A/S
Grensevingen 9
0661 Oslo
Tel.: 22 66 06 00
Fax: 22 66 05 50
mailto:bosch-Service-NO@
bshg.com
www.bosch-home.no

NZ New Zealand

BSH Home Appliances Ltd.
Unit F 2, 4 Orbit Drive
Mairangi Bay
Auckland 0632
Tel.: 09 477 0492
Fax: 09 477 2647
mailto:bshnz-cs@bshg.com
www.bosch-home.co.nz

PL Polska, Poland

BSH Sprzęt Gospodarstwa
Domowego sp. z o.o.
Al. Jerozolimskie 183
02-222 Warszawa
Centrala Serwisu
Tel.: 801 191 534
Fax: 022 572 7709
mailto:Serwis.Fabryczny@bshg.com
www.bosch-home.pl

PT Portugal

BSHP Electrodomésticos Lda.
Rua Alto do Montijo, nº 15
2790-012 Carnaxide
Tel.: 707 500 545
Fax: 214 250 701
mailto:bosch.electrodomesticos.pt@
bshg.com
www.bosch-home.pt

RO România, Romania

BSH Electrocasnice srl.
Sos. Bucuresti-Ploiesti,
nr. 19-21, sect.1
13682 Bucuresti
Tel.: 021 203 9748
Fax: 021 203 9733
mailto:service.romania@bshg.com
www.bosch-home.ro

RU Russia, Россия

ООО "БСХ Бытовая техника"
Сервис от производителя
Малая Калужская 19/1
119071 Москва
тел.: 495 737 2961
mailto:mok-kdhl@bshg.com
www.bosch-home.com

SA Saudi Arabia, المملكة العربية السعودية

BSH Home Appliances
Saudi Arabia L.L.C.
Bin Hamran Commercial Centr.
6th Floor 603B
Jeddah 21481
Tel.: 800 124 1247
mailto:service.ksa@bshg.com
www.bosch-home.com/sa

SE Sverige, Sweden

BSH Hushållsapparater AB
Landsvägen 32
169 29 Solna
Tel.: 0771 11 22 77
mailto:Bosch-Service-SE@
bshg.com
www.bosch-home.se

SG Singapore, 新加坡

BSH Home Appliances Pte. Ltd.
37 Jalan Pemimpin
Union Industrial Building
Block A, #01-03
577177 Singapore
Tel.: 6751 5000
Fax: 6751 5005
mailto:bshsgp.service@bshg.com
www.bosch-home.com.sg

SI Slovenija, Slovenia

BSH Hišni aparati d.o.o.
Litostrajska 48
1000 Ljubljana
Tel.: 01 583 07 01
Fax: 01 583 08 89
mailto:informacije.servis@
bshg.com
www.bosch-home.com/si

SK Slovensko, Slovakia

BSH domácí spotřebiče s.r.o.
Organizačná zložka Bratislava
Galvaniho 17/C
821 04 Bratislava
Tel.: 02 44 45 20 41
mailto:opravy@bshg.com
www.bosch-home.com/sk

TR Türkiye, Turkey

BSH Ev Aletleri Sanayi
ve Ticaret A.S.
Fatih Sultan Mehmet Mahallesi
Balkan Caddesi No: 51
34771 Ümraniye, Istanbul
Tel.: 0 216 444 6333
Fax: 0 216 528 9188
mailto:careline.turkey@bshg.com
www.bosch-home.com/tr

TW Taiwan, 台灣

Achelis Taiwan Co. Ltd.
4th floor, No. 112 Sec 1
Chung Hsiao E Road
Taipei ROC 100
Tel.: 02 2321 6222
mailto:Bosch@achelis.com.tw

UA Ukraine, Україна

ТОВ "БСХ Побутова Техніка"
тел.: 044 490 2095
www.bosch-home.com.ua

XK Kosovo

NTP GAMA
Rruga Mag Prishtine-Ferizaj
70000 Ferizaj
Tel.: 0290 321 434
Tel.: 00377 44 172 309
mailto:a_service@
gama-electronics.com

XS Srbija, Serbia

BSH Kućni aparati d.o.o.
Milutina Milankovića 11^a
11070 Novi Beograd
Tel.: 011 205 23 97
Fax: 011 205 23 89
mailto:informacije.servis-sr@
bshg.com
www.bosch-home.rs

ZA South Africa

BSH Home Appliances (Pty) Ltd.
15th Road Randjespark
Private Bag X36, Randjespark
1685 Midrand – Johannesburg
Tel.: 086 002 6724
Fax: 086 617 1780
mailto:applianceserviceza@
bshg.com
www.bosch-home.com/za

Garantiebedingungen

DEUTSCHLAND (DE)

Bosch-Infoteam

(Mo-Fr: 8.00-18.00 Uhr erreichbar)

Für Produktinformationen sowie Anwendungs- und Bedienungsfragen **zu kleinen Hausgeräten:**

Tel.: 0911 70 440 040 oder unter
bosch-infoteam@bshg.com

Für dieses Gerät leisten wir Garantie gemäß nachstehenden Bedingungen:

Nur für Deutschland gültig!

1. Wir beheben unentgeltlich nach Maßgabe der folgenden Bedingungen (Nr. 2 - 6) Mängel am Gerät, die nachweislich auf einem Material- und/ oder Herstellungsfehler beruhen, wenn sie uns unverzüglich nach Feststellung und innerhalb von 24 Monaten nach Lieferung an den Erstendabnehmer gemeldet werden. Zeigt sich der Mangel innerhalb von 6 Monaten ab Lieferung, wird vermutet, dass es sich um einen Material- oder Herstellungsfehler handelt.

2. Die Garantie erstreckt sich nicht auf leicht zerbrechliche Teile wie z. B. Glas oder Kunststoff bzw. Glühlampen.

Eine Garantiepflicht wird nicht ausgelöst durch geringfügige Abweichungen von der Soll-Beschaffenheit, die für Wert und Gebrauchstauglichkeit des Gerätes unerheblich sind, oder durch Schäden aus chemischen und elektrochemischen Einwirkungen von Wasser, sowie allgemein aus anomalen Umweltbedingungen oder sachfremden Betriebsbedingungen oder wenn das Gerät sonst mit ungeeigneten Stoffen in Berührung gekommen ist. Ebenso kann keine Garantie übernommen werden, wenn die Mängel am Gerät auf Transportschäden, die nicht von uns zu vertreten sind, nicht fachgerechte Installation und Montage, Fehlgebrauch, eine nicht haushaltsübliche Nutzung, mangelnde Pflege oder Nichtbeachtung von Bedienungs- oder Montagehinweisen zurückzuführen sind.

Der Garantieanspruch erlischt, wenn Reparaturen oder Eingriffe von Personen vorgenommen werden, die hierzu von uns nicht ermächtigt sind, oder wenn unsere Geräte mit Ersatzteilen, Ergänzungs- oder Zubehörteilen versehen werden, die keine Originalteile sind und dadurch ein Defekt verursacht wird.

3. Die Garantieleistung erfolgt in der Weise, dass mangelhafte Teile nach unserer Wahl unentgeltlich instandgesetzt oder durch einwandfreie Teile ersetzt werden.

Geräte, die zumutbar (z. B. im PKW) transportiert werden können, und für die unter Bezugnahme auf diese Garantie eine Garantieleistung beansprucht wird, sind unserer nächstgelegenen Kundendienststelle oder unserem Vertragskundendienst zu übergeben oder zuzusenden. Instandsetzungen am Aufstellungsort können nur für stationär betriebene (feststehende) Geräte verlangt werden.

Es ist jeweils der Kaufbeleg mit Kauf- und/oder Lieferdatum vorzulegen. Ersetzte Teile gehen in unser Eigentum über.

4. Sofern die Nachbesserung von uns abgelehnt wird oder fehlschlägt, wird innerhalb der oben genannten Garantiezeit auf Wunsch des Endabnehmers kostenfrei gleichwertiger Ersatz geliefert.

5. Garantieleistungen bewirken weder eine Verlängerung der Garantiefrist, noch setzen sie eine neue Garantiefrist in Lauf. Die Garantiefrist für eingebaute Ersatzteile endet mit der Garantiefrist für das ganze Gerät.

6. Weitergehende oder andere Ansprüche, insbesondere solche auf Ersatz außerhalb des Gerätes entstandener Schäden sind – soweit eine Haftung nicht zwingend gesetzlich angeordnet ist – ausgeschlossen.

Diese Garantiebedingungen gelten für in Deutschland gekaufte Geräte. Werden Geräte ins Ausland verbracht, die die technischen Voraussetzungen (z. B. Spannung, Frequenz, Gasarten, etc.) für das entsprechende Land aufweisen und die für die jeweiligen Klima- und Umweltbedingungen geeignet sind, gelten diese Garantiebedingungen auch, soweit wir in dem entsprechenden Land ein Kundendienstnetz haben. Für im Ausland gekaufte Geräte gelten die von unserer jeweils zuständigen Landesvertretung herausgegebenen Garantiebedingungen. Diese können Sie über Ihren Fachhändler, bei dem Sie das Gerät gekauft haben, oder direkt bei unserer Landesvertretung anfordern.

Beachten Sie unser weiteres Kundendienst-Angebot:

Auch nach Ablauf der Garantie stehen Ihnen unser Werkskundendienst und unsere Servicepartner zur Verfügung.

Robert Bosch Hausgeräte GmbH
Carl-Wery-Str. 34 / 81739 München // Germany

9000949370/11.2013
de, en, fr, it, nl, da, no, sv, fi,
es, pt, el, tr, pl, hu, uk, ru, ar

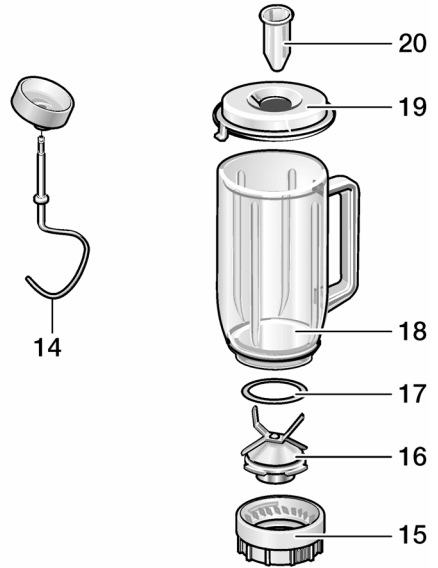
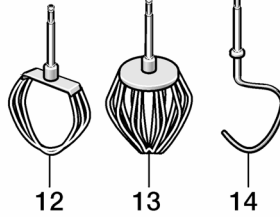
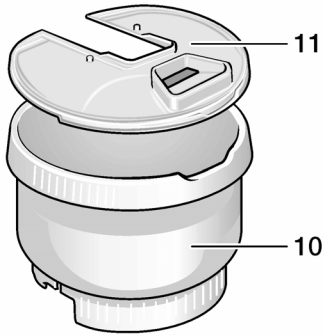
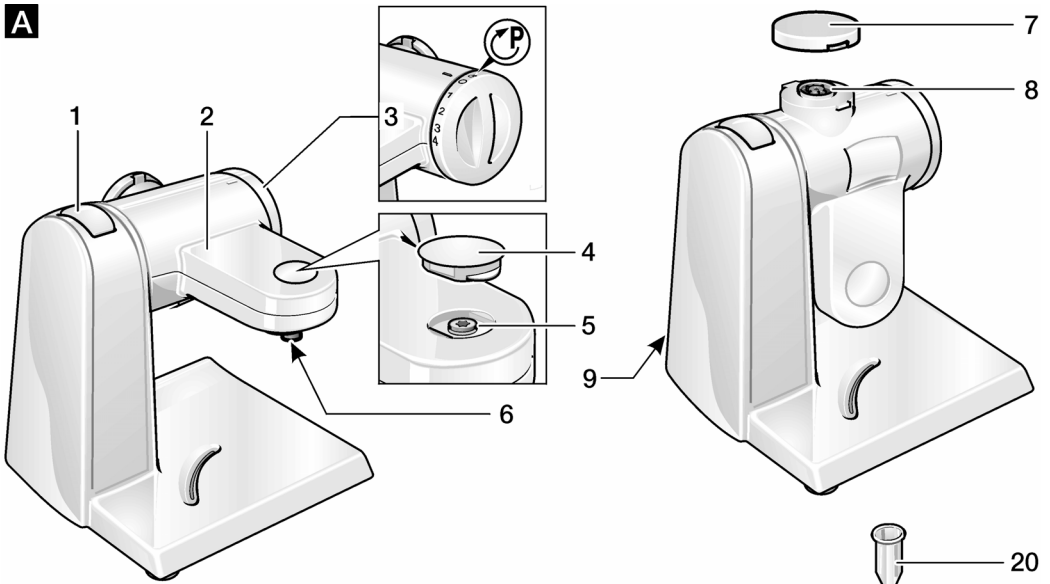
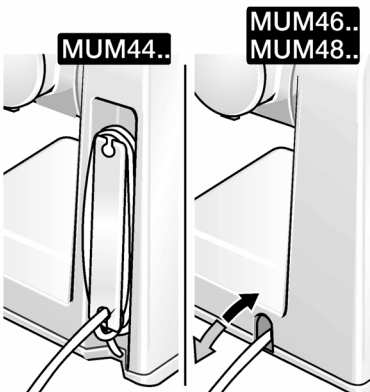
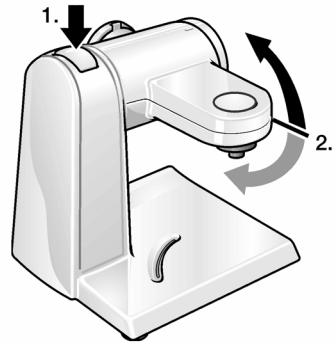
A**B****C**

D

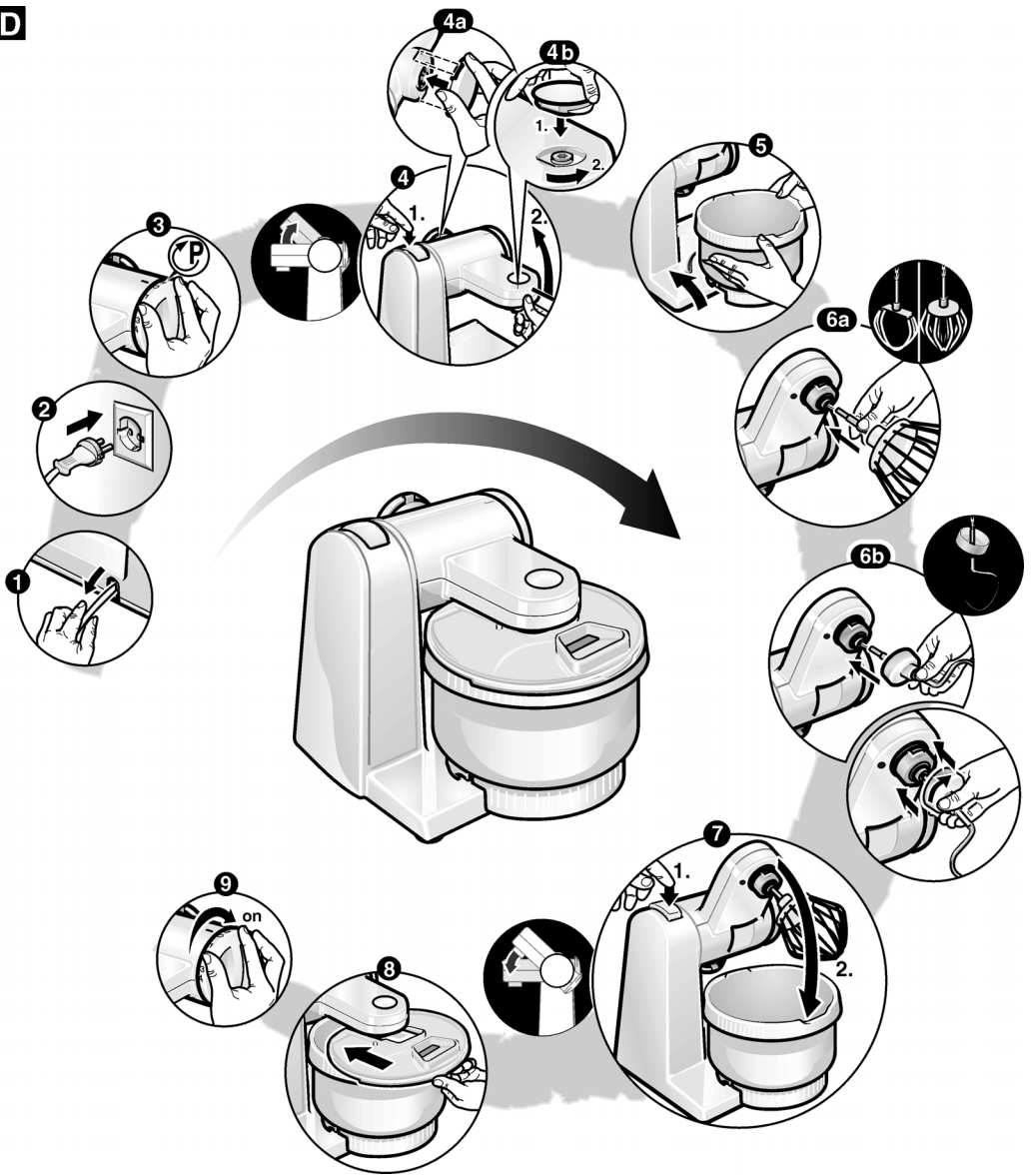

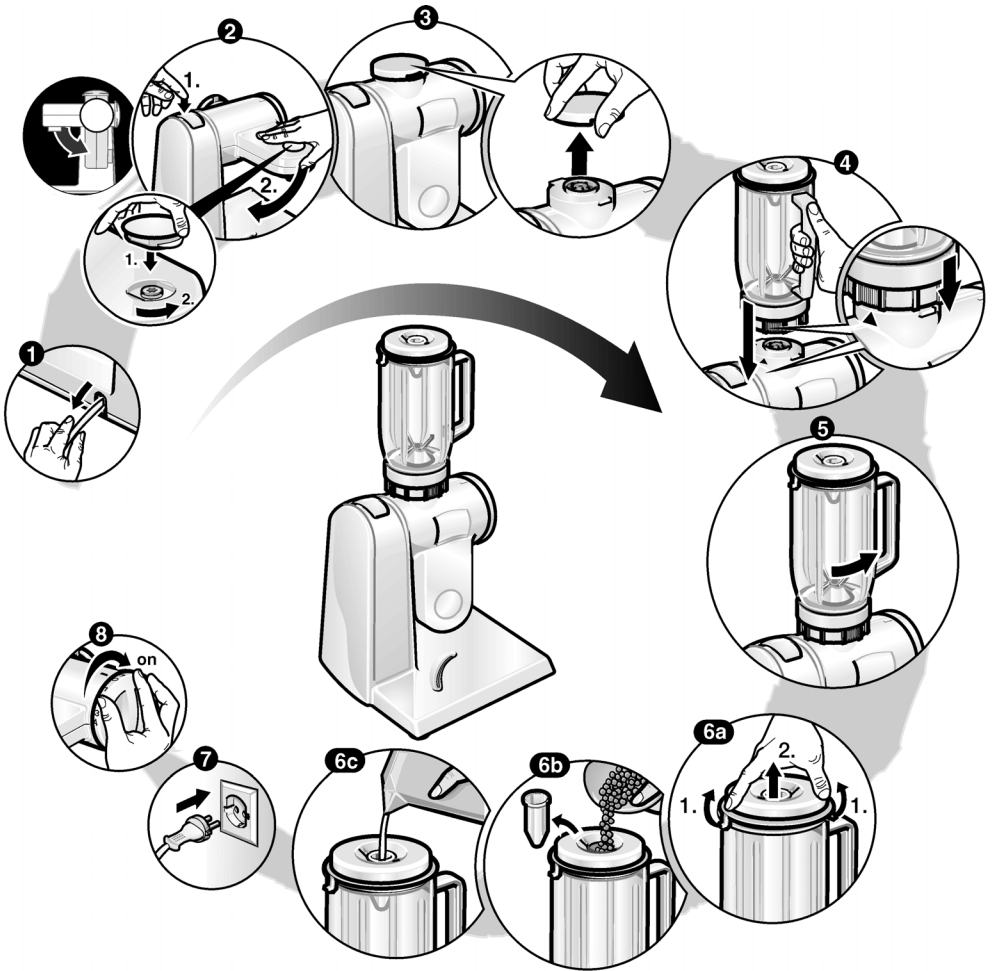
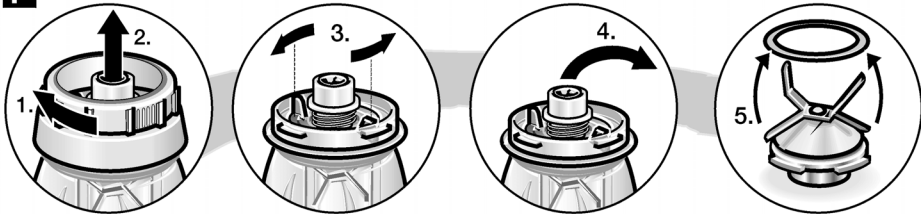
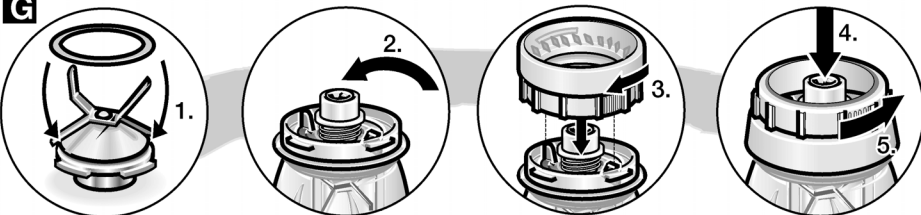
E**F****G**

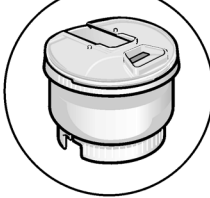
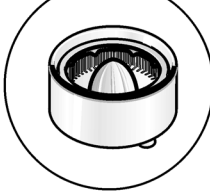
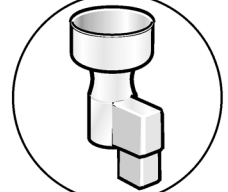
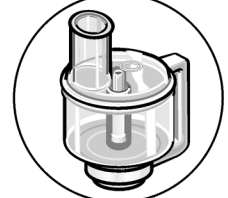
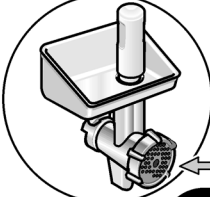
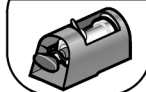
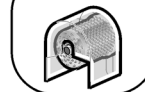
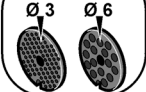
H**MUZ4ZT1****MUZ4KR3****MUZ4ER2****MUZ4EB1****MUZ4ZP1****MUZ4DS3****MUZ4GM3****MUZ45RS1****MUZ45PS1****MUZ45AG1****MUZ45KP1****MUZ4MX2****MUZ4MX3****MUZ4MM3****MUZ4FW3****MUZ45SV1****MUZ45FV1****MUZ45RV1****MUZ45LS1**

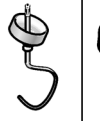
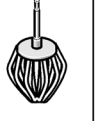

MUM4405



MUM4406



MUM4407



MUM4409



MUM4426



MUM4427



MUM4428



MUM44R1



MUM4600



MUM4655EU



MUM4657



MUM46A1GB



MUM4825



MUM4830



MUM4832



MUM4835



MUM4855



MUM4856EU



MUM4875EU



MUM4880



MUM48A1



MUM48R1



MUM48W1



MUM48CR1



MUM48CR2



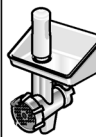

MUM4405

MUM4406

MUM4407

MUM4409

MUM4426

MUM4427

MUM4428

MUM44R1

MUM4600

MUM4655EU

MUM4657

MUM46A1GB

MUM4825

MUM4830

MUM4832

MUM4835

MUM4855

MUM4856EU

MUM4875EU

MUM4880

MUM48A1

MUM48R1

MUM48W1

MUM48CR1

MUM48CR2

✓

✓

✓

✓

✓

✓

✓

✓

✓

✓

✓

✓

✓

✓

✓

✓

✓

✓

✓

✓

✓

✓

✓

✓

✓

✓

✓

✓

✓

✓

✓

✓

✓

✓

✓

✓

✓

✓

✓

✓

✓

✓

✓

✓

✓

✓

✓

✓

✓

✓

✓

✓

✓

✓

✓

✓

✓

✓

✓