

# HAIR AND BEARD CLIPPER MC 3140

ENGLISH



FOR A GOOD REASON

**GRUNDIG**





## SAFETY

---

Please note the following instructions when using the appliance:

- The appliance is designed for domestic use only.
- This appliance is designed solely for trimming human hair and beards. Any other use is expressly prohibited.
- Never use or charge the appliance in the bath or shower or over a washbasin filled with water and never operate the appliance with wet hands.



- Never use the appliance if it, the cutting head or the power adapter shows any signs of damage.
- Only use the appliance with the parts and power adapter supplied.
- Caution! Always keep the power adapter dry.

- When the appliance is being charged, on no account should it come into contact with water or any other liquid.
- Do not completely immerse the appliance in water.
- After charging, always unplug the cable from the socket and disconnect the power adapter from the wall socket.
- Do not drop the appliance.
- To avoid damaging the power cord, prevent it from being squashed, bent or from rubbing on sharp edges. Keep the power cord away from hot surfaces and open flames.
- Never place the appliance, accessories or power adapter on or near hot surfaces.
- Check that the mains voltage on the rating label corresponds to your local mains supply.

## SAFETY

---

- Keep the appliance out of the reach of children.
- The appliance may not be used by the following people, including children: those with limited physical, sensory or mental capabilities or those with a lack of experience and knowledge. This does not apply to the latter if they were instructed in the use of the appliance or if they use it under the supervision of a person responsible for their safety. Children should always be supervised to ensure that they do not play with the appliance.
- Do not open the appliance under any circumstances. No warranty claims are accepted for damage caused by improper handling.

Dear Customer,

Congratulations on the purchase of your MC 3140 hair and beard clipper.

Please read the following user notes carefully to ensure you can enjoy your quality GRUNDIG product for many years to come.

## A responsible approach!



GRUNDIG focusses on contractually agreed social working conditions with fair wages for both internal employees

and suppliers as well as on the efficient use of raw materials with continual waste reduction of several tonnes of plastic each year – and availability of at least 5 years for all accessories.

For a future worth living.

For a good reason. Grundig.

## Special features

Your hair and beard clipper is designed to cut or model your hair and beard with the greatest of ease and without irritation.

- Adjusts in 21 positions with 2 adjustable combs for hair lengths between 1.5 mm and 41 mm (1.5 mm without comb)
- Stainless steel blade

## Controls

See the illustrations on page 2.

- A** Cutting head - stainless steel blade set
- B** On/Off switch
- C** Charge indicator LED
- D** Rolling knob

## Accessories

- E** Adjustable comb 1
- F** Adjustable comb 2
- G** Comb notch
- H** Position indicator
- I** Power adapter
- J** Charging plug
- K** Oil
- L** Cleaning brush

## Rechargeable battery operation

When operating the appliance with the built-in Ni-MH battery, only use the power adapter supplied for charging.

Check that the voltage indicated on the rating plate of the power adapter corresponds to your local power supply.

The power adapter has an automatic 100 - 240 V~, 50/60 Hz transformer which works anywhere in the world. This allows it to adjust to all international AC voltages.

- 1 Switch off the appliance with the On/Off switch **B**.
- 2 Insert the charging plug **J** into the appliance socket and power adapter **I** into the wall socket.
  - Charge indicator LED **C** lights up red.
  - When the appliance is fully charged, the charge indicator LED **C** lights up blue.
- 3 Pull the charging plug **J** out of the appliance socket and the power adapter **I** out of the wall socket.

## Notes

- Before first use or if you have not used the appliance for a long time, charge up the batteries completely (about 24 hours). The charging time afterwards is approximately 12 hours.
- This appliance is designed to charge and operate perfectly between 15°C and 40°C.
- If you switch on the appliance while it is charging, charging will be interrupted.
- When fully charged, the appliance works for around 45 minutes. It is not advisable to charge the batteries after each use. Generally, you should only charge the batteries when they are completely discharged. This increases their service life.

### Operating with the power adapter

Check that the voltage indicated on the rating plate of the power adapter corresponds to your local power supply.

The only way to disconnect the appliance from the power supply is to unplug the power adapter.

- 1 Plug the charging plug **J** into the appliance socket and the power adapter **I** into the wall socket.
  - The appliance is now ready to operate.

### Caution

- When in the bathroom or beside a water connection, only use the appliance in battery mode; never run it from the mains.



# PREPARATION

---

## Notes

- Trimming length without comb system is 1.5 mm.
- Width of cutting head is 40 mm.

## Setting the trimming length

The adjustable comb 1 **E** and comb 2 **F** can be used to set the appliance to any of 20 different lengths:

### Adjustable comb 1 **E**

Position 1	2 mm
Position 2	4 mm
Position 3	6 mm
Position 4	8 mm
Position 5	10 mm
Position 6	12 mm
Position 7	14 mm
Position 8	16 mm
Position 9	18 mm
Position 10	21 mm

### Adjustable comb 2 **F**

Position 1	22 mm
Position 2	24 mm
Position 3	26 mm
Position 4	28 mm
Position 5	30 mm
Position 6	32 mm
Position 7	34 mm
Position 8	36 mm
Position 9	38 mm
Position 10	41 mm

## PREPARATION

---

- 1 Slide adjustable comb 1 **E** or adjustable comb 2 **F** over the cutting head **A**. Make sure that the comb notches **G** on the adjustable combs are fully inserted into the grooves on the sides of the appliance and that they click into place.

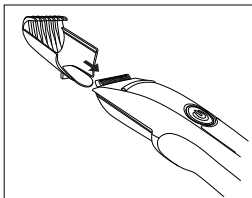

- 2 Adjust the trimming length by turning the rolling knob **D** forwards or backwards into the required position.
- Position indicator **H** shows the adjusted length position.

### Note:

- The adjustable comb is automatically locked when the appliance is switched on. It cannot be adjusted during use. This function prevents accidental changing of cutting length during use.

- 3 After use, remove the adjustable comb 1 **E** or adjustable comb 2 **F** from the appliance.

# OPERATION

---

## Hair trimming

Make sure the hair is clean and completely dry.

Place a towel around the neck and shoulders of the person whose hair you are trimming. Make sure the person is seated so that his or her head is roughly at your eye level. Before trimming, comb the hair so that it falls naturally and you can see the direction in which it grows.

- 1 Adjust the trimming length; see the "Setting the trimming length" section.
- 2 Push the On/Off switch **B** to switch on the appliance.
- 3 Place the cutting head **A** on the hair.
- 4 Move the cutting head **A** against the direction of hair growth. Apply only light pressure and cut with slow, gentle movements.
- 5 After use, switch off the appliance with the On/Off switch **B**.

## Useful tips

- As you cut, take a break at regular intervals. Once the hair has been cut you cannot make a correction.
  - Only cut a small amount the first time you use the trimmer. This is the only way to get used to the variable positions.
  - Comb the hair continuously while trimming. Look for hair which is too long and comb out clippings.
- 
- Hold the appliance with a relaxed and comfortable grip.
  - Always cut against the natural direction of the hair.

## Beard trimming

- 1 Adjust the trimming length; see the “Setting the trimming length” section.
- 2 Push the On/Off switch **B** to switch on the appliance.
- 3 Place the cutting head **A** on the beard.
- 4 Move the cutting head **A** against the direction of hair growth. Apply only light pressure and cut with slow, gentle movements.
- 5 After use, switch off the appliance with the On/Off switch **B**.

## Notes

- If the appliance becomes blocked by thick hair while you are using it, switch it off. If running it from the mains, unplug the socket. Remove the adjustable comb and clean the cutting head with the brush supplied. If the blades only move slowly or not at all, clean the appliance as described in the “Cleaning and Care” section.
- For trimming contours, remove the adjustable comb 1 **E** or adjustable comb 2 **F**. Use the appliance without the combs (cutting length is 1.5 mm).

# CLEANING AND CARE

## General information

The appliance must be cleaned regularly so that you can continue to enjoy its top performance and optimum results.

## Cleaning

- 1 Switch off the appliance with the On/Off switch **B** and unplug the power adapter if you are running it from the mains.
- 2 Remove the adjustable comb 1 **E** or adjustable comb 2 **F** from the appliance. Clean the cutting head **A** with the supplied cleaning brush **L**.
- 3 Push the blade outwards to remove the cutting head **A**. Clean the cutting head **A** and the cavity in the appliance with the supplied cleaning brush **L**.

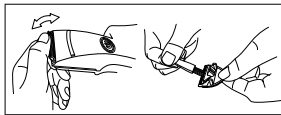

- 4 Insert the cutting head **A** by first placing the claw into the cavity and then pressing on the cutting head until it clicks into place.

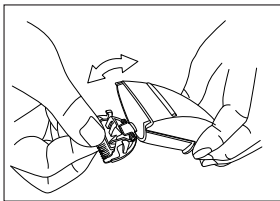

## Notes

- Never use water or any other liquids to clean the appliance. Only use the cleaning brush provided.
- You can rinse the cutting head and the two adjustable combs with water, but you must remove them from the appliance first.
- Remove any clippings after each use.
- The cutting head of your appliance does not normally need to be oiled. To maintain the cutting head in its original condition for as long as possible, oil it at regular intervals (with the oil **K** provided).

## Storage

If you do not plan to use the appliance for a long period of time, please store it carefully.

Make sure that it is unplugged and is completely dry.

Store the appliance in a cool, dry place.

Make sure that the appliance is kept out of the reach of children.

## Environmental note

This product has been manufactured from high-quality parts and materials which can be reused and recycled.



Therefore, do not dispose of the device and the built-in rechargeable batteries along with normal household waste at the end of its service

life. Take it to a collection point for the recycling of electrical and electronic equipment where the batteries are taken out of the device and disposed of separately. This is indicated by this symbol on the product, in the operating manual and on the packaging.

Contact your local authority for collection points in your area.

Help protect the environment by recycling used products.

## Technical data



This product conforms to European directives 2004/108/EC, 2006/95/EC and 2009/125/EC.

## Power adapter:

**Input:** 100 - 240 V~, 50/60 Hz

**Output:** 3.4 VDC, 1000 mA

**Batteries:** Nickel metal hydride (Ni-MH)



Design and specifications subject to change without notice.

Grundig Intermedia GmbH  
Beuthener Strasse 41  
90471 Nürnberg

[www.grundig.com](http://www.grundig.com)  
72011 907 7500 12/45

AUS GUTEM GRUND

**GRUNDIG**