

P2P Quick Installation For Iphone and Android

Introduction:

This Quick Installation is only for P2P ip camera models , it will help you to set the camera in mobile view easily. The camera uses Peer To Peer (P2P) for easy setup in mobile. You can also connect to it via traditional Internet Protocol (IP) in computer if desired. See the main Owner's Manual for more setting in computer.

Using P2P the camera is very easy to set up. You just need to plug in the power supply and network cable, and then use your smartphone or tablet to view the camera locally, or remotely via the Internet. With this booklet's help, you can get your camera working in less than a minute!

Step 1: Hardware Installation

You need to set up your camera using a network cable (wired) first before you attempt to use wireless.

1. Plug the power adaptor into the camera and into an AC outlet.
2. Plug one end of the network cable into the camera, and the other end into your router/switch.

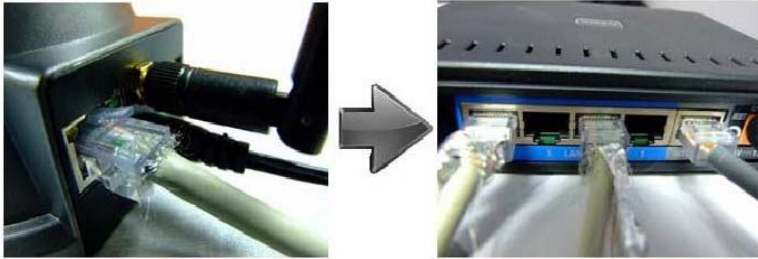

Step 2: Software Installation



Download the FREE App: "P2P IPCamera" , App from the Apple App store or Google Play Store.

Note: The iPhone/iPad App and Android® mobile device setup are similar, this manual uses the iPhone/iPad App as an example.

Step 3: Add camera:

Add camera via **QR Code**.

This method makes setup extremely fact and easy;

Run the App, Touch **Add camera** icon a the bottom of the screen.touch **QR Code**, then app to run your smartphone's camera, place your phone over the QR code on the bottom of camera; then app will add the P2P UID automatically, you only need to enter default **user :admin, password :000000**, and click **Save** to finish settings; Touch **Camera** in the bottom of app, click to view the video.

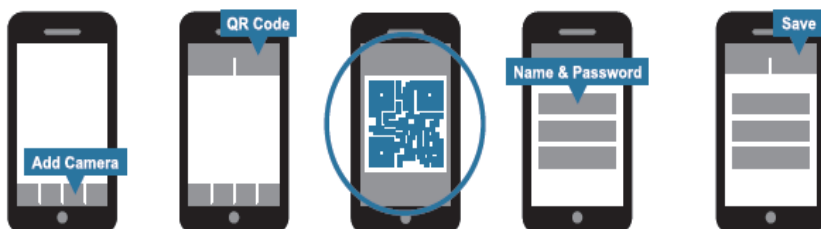

What is more, click , you can search P2P UID when your smartphone and the camera are in the same LAN network;

Or click  to add camera manually:

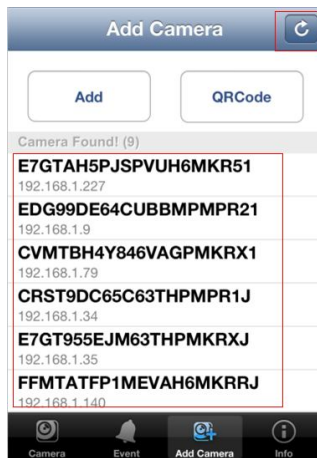

Search P2P Camera in under same network:

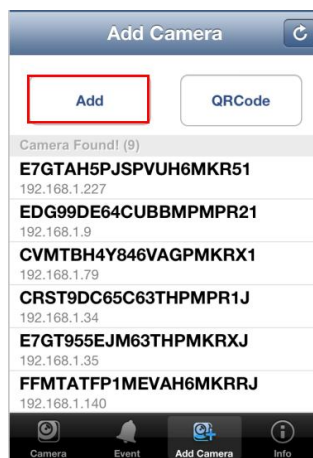

Add camera manually:



Wifi Settings:

Click  under camera”  ”in the view screen to enter **Advanced settings**;: **Advanced Settings--WIFI--Scan and receive your Wifi--Enter WIFI password**; then camera will reboot within 50 seconds, during this 50 seconds, camera will disconnect, and connect back after 50seconds; you need to keep power plugged, and install the Antenna, unplug the network cable; After 50second, camera will be connected with WIFI. You can view the camera again under wifi connection.



More details ,please refer to the user manual on website: