

U.I. Lapp GmbH	<b>DATASHEET</b>	
	<b>EPIC® Modular 3.6 machined contacts</b>	1121070C 14.11.2013

For inserts and modules of the EPIC® rectangular connectors



**Remark**

Photographs are not to scale and do not represent detailed images of the respective products.

Product Management	Document: EPIC® Modular 3.6 machined contacts	1 / 2
--------------------	---	-------

U.I. Lapp GmbH	<b>DATASHEET</b>	 <b>LAPP GROUP</b>
	<b>EPIC® Modular 3.6 machined contacts</b>	<b>1121070C</b> <b>14.11.2013</b>

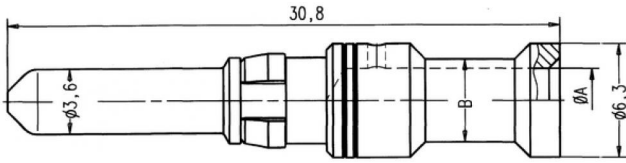

Product Management	Document: EPIC® Modular 3.6 machined contacts	2 / 2
--------------------	---	-------