

REV	DESCRIPTION OF CHANGE	DATE

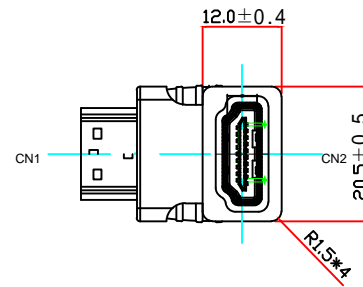
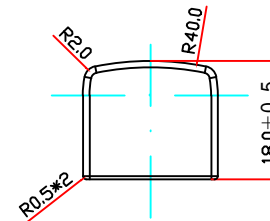
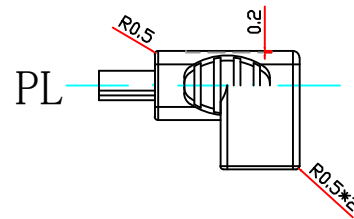
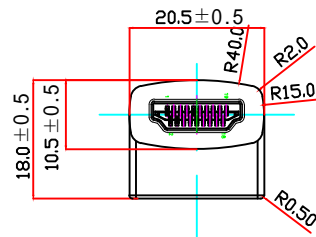
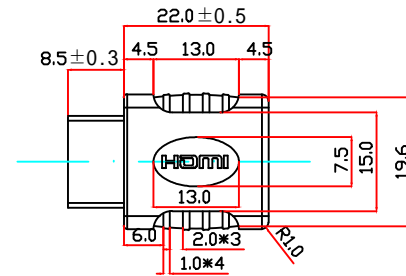

PIN OUT

CN1	—	CN2	CN1	—	CN2
01	—	01	11	—	11
02	—	02	12	—	12
03	—	03	13	—	13
04	—	04	14	—	14
05	—	05	15	—	15
06	—	06	16	—	16
07	—	07	17	—	17
08	—	08	18	—	18
09	—	09	19	—	19
10	—	10	SHELL	—	SHELL

NOTES

- 1.Electric:
Contact resistance:20M ohms max.
Dielectric withstanding voltage:
300V AC/1 min.
Insulation resistance:
100M ohms min.
- 2.Mechanical:
Mating Force:45N max
withdrawal force:10N min
Durobilty:1500cycies min
- 3.Material:
Operating Temperature:-55to+85°
- 4.HDMI-19P- A B C

- A:(Shell finish)
N:Nickel T:Tin
G:Gold
- B:(Pin Finish)
A: Sintver T: Tin N: Nickel
- B: Selcve plated gold 1U*(G/F)
C: Selcve plated gold 3U*(G/F)
D: Selcve plated gold 5U*(G/F)
E: Selcve plated gold 10U*(G/F)
F: Selcve plated gold 15U*(G/F)
G: Selcve plated gold 20U*(G/F)
H: Selcve plated gold 30U*(G/F)
I: Selcve plated gold 50U*(G/F)
- M: Nickel front shell tin rear shell
- C:(Housing Coler)
B: Black
W: White
5. ⊗ Part NO

SCALE 1:1 UNIT mm	DWG NO	DESIGN	Aosion	CHECKED	APPROVED	
			REV	A1	DATE	2014-01-13