

COUP

Kompaktmixer 0,8l

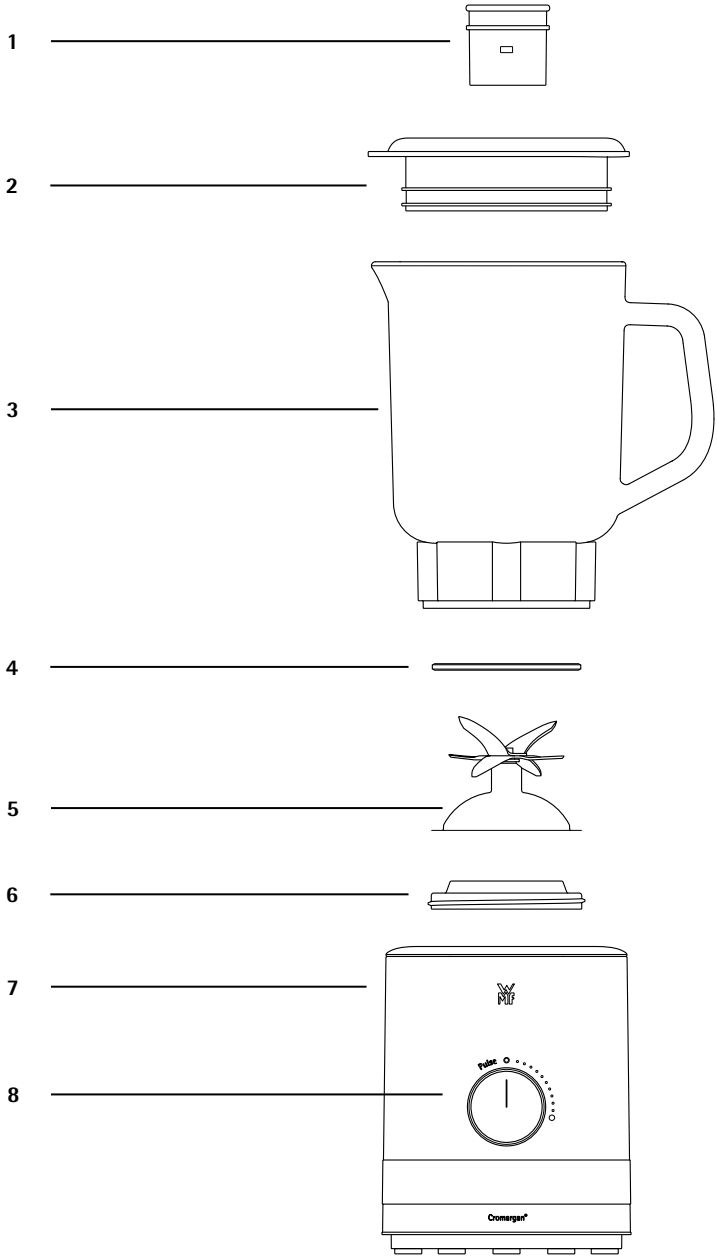



Aufbau Standmixer

- 1 Verschlusskappe
- 2 Deckel
- 3 Glaskrug mit Sockel
- 4 Dichtring
- 5 Messerbaugruppe
- 6 Verschlusschraube
- 7 Antriebseinheit
- 8 Wahlschalter

Table blender components

- 1 Cap
- 2 Lid
- 3 Glass jar with base
- 4 Sealing ring
- 5 Blade assembly
- 6 Locking screw
- 7 Drive unit
- 8 Selector switch

Montage du mixeur sur pied

- 1 Capuchon
- 2 Couvercle
- 3 Broc en verre avec socle
- 4 Joint
- 5 Bloc à couteaux
- 6 Vis de fermeture
- 7 Bloc moteur
- 8 Sélecteur

Struttura del frullatore

- 1 Cappuccio
- 2 Coperchio
- 3 Brocca di vetro con base
- 4 Guarnizione
- 5 Gruppo lame
- 6 Tappo a vite
- 7 Unità di azionamento
- 8 Interruttore nella modalità

Montaje de la batidora de pie

- 1 Capuchón
- 2 Tapa
- 3 Jarra de cristal con zócalo
- 4 Anillo de junta
- 5 Unidad de cuchillas
- 6 Tornillo-tapón
- 7 Unidad de accionamiento
- 8 Conmutador selector

Componenten van staande mixer

- 1 Afsluitkap
- 2 Deksel
- 3 Glazen kan met sokkel
- 4 Afdichtring
- 5 Messenmodule
- 6 Sluitschroef
- 7 Aandrijfunit
- 8 Keuzeschakelaar

Produktoversigt bordblender

- 1 Lukningskappe
- 2 Låg
- 3 Glaskande med base
- 4 Tætningsring
- 5 Knivholder
- 6 Låseskrue
- 7 Drivenhed
- 8 På omskifteren

Mixerns delar

- 1 Propp
- 2 Lock
- 3 Glaskanna med sockel
- 4 Tätningring
- 5 Knivenhet
- 6 Låsskruv
- 7 Drivenhet
- 8 Omkopplaren

Tehosekoittimen osat

- 1 Syöttöaukon korkki
- 2 Kansi
- 3 Lasikannu jalustalla
- 4 Tiivisterengas
- 5 Teräosa
- 6 Kierretulppa
- 7 Käyttöyksikkö
- 8 Valintakytkin

Mikser

- 1 Deksel
- 2 Lökk
- 3 Glassmugge med sokkel
- 4 Tetningsring
- 5 Knivinnretning
- 6 Låseskrue
- 7 Drivenhet
- 8 Bryteren

Important safety information

- Appliances may be used by persons with limited physical, sensory or mental capabilities and persons lacking experience and/or knowledge if they are supervised or have received instruction regarding safe use of the appliance and if they have understood the resulting hazards.
- This appliance must not be used by children. The appliance and its connecting cable must be kept out of the reach of children.
- Children must not play with the appliance.
- The appliance must always be disconnected from the mains by means of pulling out the mains plug when there is no supervision present, if a fault occurs during operation and prior to any assembly, disassembly or cleaning work.
- If the appliance's supply cable is damaged, it must be replaced by the manufacturer, his customer service representative or a similarly qualified person to avoid hazards.
- Exercise caution when handling the sharp cutting blades, emptying the jug and performing cleaning work.
- Clean the glass jug after each use.
- Exercise caution when pouring hot liquids into a compact kitchen appliance or blender. The liquid could be expelled from the appliance again in the form of sudden flash steam.
- This appliance is intended for use in household environments and for similar applications, such as:
 - in kitchens – for employees in shops, offices and other commercial areas;
 - on agricultural property;
 - by customers in hotels, motels and other residential facilities;
 - in bed-and-breakfast establishments;The appliance is not intended for purely commercial use.

Before use

The blender may only be used for its intended purpose according to this operating manual, so read it carefully before performing any start-up work. It contains instructions for using, cleaning and caring for the appliance. We accept no liability for any damages caused if this manual is not observed. Keep the operating manual in a safe place and pass it on to any subsequent user together with the appliance. Please also note the warranty information at the end. The appliance is not intended for commercial use, but only for the preparation of household quantities of food. Observe the safety information during use.

Technical data

Rated voltage:	220 – 240 V~ 50-60 Hz
Power consumption:	400 W
Protection class:	II

Additional safety information

- Only connect the appliance to earthed wall sockets that have been installed pursuant to regulations. The supply cable and plug must be dry.
- Do not pull or clamp the connecting cable over sharp edges. Do not leave it dangling and protect it from heat and oil.
- Do not place the appliance on hot surfaces, such as on hotplates or similar areas, and do not operate near naked flames.
- Never pull the mains plug out of the socket by the supply cable or with wet hands.
- Do not switch on the appliance when the glass jug is empty.
- **Always operate the appliance with the lid closed. Always wait for the blades to come to a standstill before removing the lid and/or the glass jug.**
- Never handle objects in the glass jug while the appliance is running.
- **Do not reach into the jug before the mains plug has been unplugged.**
- Always move the selector switch into the Off position  before removing the glass jug.
- **Attention!** There is a risk of scalding when processing hot food. In extreme cases, the glass jug could be damaged. Only food with a maximum temperature of 60°C may be processed. In this case, do not fill the jug more than halfway and firmly press the lid onto the jug by hand during operation.
- The appliance must be switched off and disconnected from the mains before accessories or additional parts that move during operation are replaced.
- Stop using the appliance and/or pull out the mains plug immediately if:
 - the appliance or mains cable is damaged.
 - you suspect that there is a defect after the appliance has fallen or suffered a similar incident. In cases such as these, send the appliance to be repaired.
- Do not immerse the drive unit in water.
- We accept no liability for any damages caused in cases of misuse, incorrect operation or improper repairs. Claims under warranty are likewise excluded in such cases.

Use

The WMF COUP table blender is a space-saving and energy-efficient kitchen appliance. You can use the appliance to prepare smoothies, shakes, soups, etc. Thanks to the appliance's compact design and powerful motor, you can also process only small quantities. Easy and intuitive operation and the high-quality workmanship / materials guarantee convenient preparation.



38 % Space savings*

49 % Resource savings*

42 % Energy savings*

100 % Performance

* Compared to WMF LINEO table blender.

Confirmed by technikzuhausa.de. Resource savings refer to material usage and transportation volume. Energy savings refer to the maximum power process consumption at maximum filling capacity.

Start-up

- Clean the glass jug (3), lid (2) and closing cap (1) before starting up the appliance for the first time. Ensure that you do not injure yourself on the sharp blade.
- Place the appliance on an even surface and position the glass jug (3) on the drive unit (8).
- Add the ingredients to the jug (3) and close it with the lid (2) and the closing cap (1).

Additional ingredients may be added by removing the closing cap (1), even while the motor is running.

Note: Ensure that you do not exceed the maximum filling quantity of 0.8 l. If you are using hot, very liquid or slightly foaming food (e.g. milk), we advise using 0.5 l as the maximum filling quantity.

Note: Never operate the appliance empty.

- Start the appliance by turning the selector switch (8) to the right. Start at a low speed and increase it if necessary.
To use the **Pulse** function, hold the selector switch (8) to the left on the **Pulse** level. The motor will operate at maximum speed for as long as you keep the selector switch (8) on the **Pulse** level.
- As soon as the desired result has been achieved, switch the selector switch (8) to the Off position . Only then should you remove the jug (3).
Attention! Risk of injury! Always wait for the blade (2) to come to a standstill before removing the lid. Do not reach into the appliance before the mains plug has been unplugged. Completely empty the glass jug (3) following use. Do not leave any liquid in the jug (3).

Examples	Speed	Maximum time	Maximum filling quantity
Instant drinks, cocktails	Low (min.)	40 – 60 s	500 ml
Soft fruits (e.g. bananas, apricots)	Low (min.)	40 – 60 s	250 g
Milkshakes / smoothies with soft fruits	Low (min.)	1 – 2 mins.	250 g of fruit + 150 ml of milk / juice
Soups, sauces	Medium	1.5 – 2 mins.	500 ml
Milkshakes / smoothies with harder fruits	Medium	1.5 – 2 mins.	250 g of fruit + 150 ml of milk / juice
Vegetables	Medium	1.5 – 2 mins.	250 g
Frappés	Medium	1.5 – 2 mins.	250 ml of coffee + 4 ice cubes
Milkshakes / smoothies with frozen fruits, green smoothies	High (max.)	40 – 60 s	250 g of fruit + 150 ml of milk / juice

Crushing ice cubes

Add a maximum of 6 ice cubes and close the glass jug (3) with the lid (2) and closing cap (1). Move the selector switch (8) to the **Pulse** level for a few seconds and then back to the Off position **O**. As soon as the ice cubes have fallen back to the bottom of the glass jug (8), you can switch to the **Pulse** level again for a few seconds. Repeat the process until the crushed ice has the desired consistency.

Note: For a more homogeneous result, add some water to the ice cubes.

Glass jug

Lid with closing cap

The closing cap (1) in the lid (2) can be removed and used as a measure (10 / 20 / 30 ml) by turning it anti-clockwise.

The lid (2) reliably and tightly seals the glass jug. The lid (2) has a tab which you can use to make it easier to remove the lid.

You can add more ingredients through the opening, even during operation.

Disassembling the glass jug

The glass jug (3) can be disassembled, especially for cleaning.

Remove the lid (2) and the closing cap (1). Place the glass jug (3) on the table with the opening face-down and turn the locking screw (6) on the blade unit (5) clockwise (see the figure). You can now remove the blade unit (5) and the sealing ring (4).

To assemble the glass jug, the sealing ring (4) is first of all attached to the blade unit (5). When doing so, ensure that the sealing ring (4) is correctly positioned on the blade unit (5). Then insert the blade unit (5) into the glass jug (3) and firmly turn the locking screw (6) anti-clockwise.

Note: To ensure the tightness of the glass jug (3), the blade unit (5) must be screwed on tightly. The blade unit (5) is easier to tighten if you apply a few drops of cooking oil on the sealing side of the glass jug (see the figure).

Cleaning and maintenance

Remove the mains plug after use. Under no circumstances should you immerse the drive unit (8) in water. Simply wipe the outside with a damp cloth. Do not use any abrasive cleaning agents. Ensure that you do not injure yourself on the sharp blade when cleaning the glass jug (3). Immediately after blending, fill the jug with warm rinsing water and allow the motor to run for a few seconds. Then remove the glass jug (3) and clean with a washing-up brush. For thorough cleaning, you can disassemble the glass jug as described in the section entitled "Disassembling the glass jug".

For quick and easy cleaning, you can place all loose parts in the dishwasher.

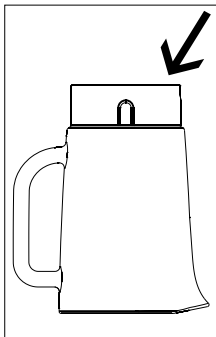

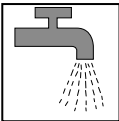
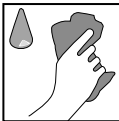
	 Dishwasher safe	 Can be rinsed under running water	 Wipe with a damp cloth
Closing cap (1)	✓	✓	✓
Lid (2)	✓	✓	✓
Glass jug with base (3)	✓	✓	✓
Sealing ring (4)	✓	✓	✓
Blade unit (5)	✓	✓	✓
Locking screw (6)	✓	✓	✓
Drive unit (7)	—	—	✓

For UK use only

- This product is supplied with a 13 A plug conforming to BS 1363 fitted to the mains lead. If the plug is unsuitable for your socket outlets or needs to be replaced, please note the following. If the plug is a non-rewireable one, cut it from the mains lead and immediately dispose of it. Never insert it into a socket outlet as there is a very great risk of an electric shock.
- The replacement of the plug at the mains lead has to be done according to the following instructions:

Important: The wires in this mains lead are coloured in accordance with the following code:

blue	Neutral
brown	Live

As the colours of the wires in the mains lead of this appliance may not correspond with the coloured markings identifying the terminals in your plug, proceed as follows:

- the wire which is coloured blue must be connected to the terminal which is marked with the letter N or coloured black,
- the wire which is coloured brown must be connected to the terminal which is marked with the letter L or coloured red.

Do not connect any wire to the terminal which is marked with the letter E or by the earth symbol , or coloured green or green and yellow.

- If a 13 A (BS 1363) plug is used it must be fitted with a 3 A fuse conforming to BS 1362 and be ASTA approved. If any other type of plug is used, the appliance must be protected by a 5 A fuse either in the plug or adapter or at the distribution board.
- If in doubt - consult a qualified electrician.
- Never use the plug without closing the fuse cover.



The device complies with the European Directives 2006/95/EG, 2004/108/EG and 2009/125/EG.



At the end of its service life, this product may not be disposed of in the normal household waste, but rather must be disposed of at a collection point for recycling electrical and electronic devices. The materials are recyclable according to their labelling. You make an important contribution to protecting our environment by reusing, recycling or utilising old devices in other ways. Please ask the municipal administration where the appropriate disposal facility is located.

Subject to change.

Kundendienst-Adresse:

wmf consumer electric GmbH
Standort Trepesch
Steinstraße 19
D-90419 Nürnberg
Germany
Tel.: +49 (0) 7331 25-8677
eMail: service-wmf@wmf-ce.de

Hersteller:

wmf consumer electric GmbH
Messerschmittstraße 4
D-89343 Jettingen-Scheppach
Germany
www.wmf-ce.de