

Pioneer

X-PM32
X-PM12

CD Receiver System



Discover the benefits of registering your product online at
<http://www.pioneer.co.uk> (or <http://www.pioneer.eu>).

Operating Instructions



CAUTION

TO PREVENT THE RISK OF ELECTRIC SHOCK, DO NOT REMOVE COVER (OR BACK). NO USER-SERVICEABLE PARTS INSIDE. REFER SERVICING TO QUALIFIED SERVICE PERSONNEL.

D3-4-2-1-1_B1_En

WARNING

This equipment is not waterproof. To prevent a fire or shock hazard, do not place any container filled with liquid near this equipment (such as a vase or flower pot) or expose it to dripping, splashing, rain or moisture.

D3-4-2-1-3_A1_En

WARNING

To prevent a fire hazard, do not place any naked flame sources (such as a lighted candle) on the equipment.

D3-4-2-1-7a_A1_En

VENTILATION CAUTION

When installing this unit, make sure to leave space around the unit for ventilation to improve heat radiation (at least 10 cm at top, 10 cm at rear, and 10 cm at each side).

WARNING

Slots and openings in the cabinet are provided for ventilation to ensure reliable operation of the product, and to protect it from overheating. To prevent fire hazard, the openings should never be blocked or covered with items (such as newspapers, table-cloths, curtains) or by operating the equipment on thick carpet or a bed.

D3-4-2-1-7b*_A1_En

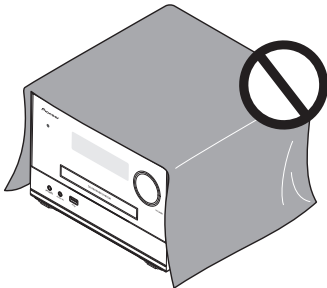

Operating Environment

Operating environment temperature and humidity:
+5 °C to +35 °C (+41 °F to +95 °F); less than 85 %RH
(cooling vents not blocked)

Do not install this unit in a poorly ventilated area, or in locations exposed to high humidity or direct sunlight (or strong artificial light)

D3-4-2-1-7c*_A1_En

CAUTION

The **STANDBY/ON** switch on this unit will not completely shut off all power from the AC outlet. Since the power cord serves as the main disconnect device for the unit, you will need to unplug it from the AC outlet to shut down all power. Therefore, make sure the unit has been installed so that the power cord can be easily unplugged from the AC outlet in case of an accident. To avoid fire hazard, the power cord should also be unplugged from the AC outlet when left unused for a long period of time (for example, when on vacation).

D3-4-2-2-2a*_A1_En

CAUTION

This product is a class 1 laser product classified under the Safety of laser products, IEC 60825-1:2007.

CLASS 1 LASER PRODUCT

D58-5-2-2a_A1_En

This product is for general household purposes. Any failure due to use for other than household purposes (such as long-term use for business purposes in a restaurant or use in a car or ship) and which requires repair will be charged for even during the warranty period.

K041_A1_En

WARNING

Store small parts out of the reach of children and infants. If accidentally swallowed, contact a doctor immediately.

POWER-CORD CAUTION

Handle the power cord by the plug. Do not pull out the plug by tugging the cord and never touch the power cord when your hands are wet as this could cause a short circuit or electric shock. Do not place the unit, a piece of furniture, etc., on the power cord, or pinch the cord. Never make a knot in the cord or tie it with other cords. The power cords should be routed such that they are not likely to be stepped on. A damaged power cord can cause a fire or give you an electrical shock. Check the power cord once in a while. When you find it damaged, ask your nearest PIONEER authorized service center or your dealer for a replacement.

S002*_A1_En

Condensation

If the unit is moved suddenly from a cold place into a warm room (in winter, for example) or if the temperature in the room in which the player is installed rises suddenly due to a heater, etc., water droplets (condensation) may form inside (on operating parts and the lens). When condensation is present, the player will not operate properly and playback is not possible. Let the player stand at room temperature for 1 or 2 hours with the power turned on (the time depends on the extent of condensation). The water droplets will dissipate and playback will become possible. Condensation can also occur in the summer if the player is exposed to the direct wind from an air-conditioner. If this happens, move the player to a different place.

5005_A1_En

Radio wave caution

This unit uses a 2.4 GHz radio wave frequency, which is a band used by other wireless systems (Microwave ovens and Cordless phones, etc.). In this event noise appears in your television image, there is the possibility this unit (including products supported by this unit) is causing signal interference with the antenna input connector of your television, video, satellite tuner, etc. In this event, increase the distance between the antenna input connector and this unit (including products supported by this unit).

- Pioneer is not responsible for any malfunction of the compatible Pioneer product due to communication error/malfunctions associated with your network connection and/or your connected equipment. Please contact your Internet service provider or network device manufacturer.
- A separate contract with/payment to an Internet service provider is required to use the Internet.

Information for users on collection and disposal of old equipment and used batteries

(Symbol for equipment)



(Symbol examples for batteries)



These symbols on the products, packaging, and/or accompanying documents mean that used electrical and electronic products and batteries should not be mixed with general household waste.

For proper treatment, recovery and recycling of old products and used batteries, please take them to applicable collection points in accordance with your national legislation.

By disposing of these products and batteries correctly, you will help to save valuable resources and prevent any potential negative effects on human health and the environment which could otherwise arise from inappropriate waste handling.

For more information about collection and recycling of old products and batteries, please contact your local municipality, your waste disposal service or the point of sale where you purchased the items.

These symbols are only valid in the European Union.

For countries outside the European Union:

If you wish to discard these items, please contact your local authorities or dealer and ask for the correct method of disposal.

K058a_A1_En

Thank you for buying this Pioneer product.

Please read through these operating instructions so that you will know how to operate your model properly. After you have finished reading the instructions, put them in a safe place for future reference.

Contents

01 Before you start

Introduction	5
What's in the box	5
Loading the battery in the remote control	5
Using speakers horizontally	6

02 Part names and functions

Remote control	7
Front panel	8
Top panel	9

03 Connections

Speaker connection	10
Connect the subwoofer	10
Connecting the FM antenna	11
Using external antennas	11
Plugging in	11

04 Getting started

Turning on	12
APS mode	12
Setting the clock	12
Selecting a source	12
Using Headphones	13

05 Playing

Playing a disc	14
Playing from a USB storage device	14
Controlling playback	14
Programming tracks	15
For a CD	15
For WMA/MP3 files	15
Erasing the program	15

06 Bluetooth® Audio playback

Music playback using <i>Bluetooth</i> wireless technology	16
Remote control operation	16
Pairing with the unit (Initial registration)	16
Listen to music on the unit from a <i>Bluetooth</i> capable device	17
Radio wave caution	17
Scope of operation	17
Radio wave reflections	18
Precautions regarding connections to products supported by this unit	18

07 Listening to the FM radio

Tuning to an FM radio station	19
Programming radio stations	19
Tuning to a preset radio station	19
Display RDS information	19

08 Other features

Turn on automatically	20
Setting the sleep timer	20
Routing audio from other devices	20
Through the AUDIO IN socket	20
USB 500 mA charge	20
Setting and deactivating the DEMO mode	20

09 Additional information

USB playability information	21
Supported MP3 disc formats	21
RDS program types	21
Troubleshooting	22
Cautions on use	23
When moving this unit	23
Place of installation	23
Do not place objects on this unit	23
Cleaning the product	24
Cleaning the lens	24
Handling discs	24
Storing	24
Cleaning discs	24
About specially shaped discs	24
Specifications	25

Chapter 1: Before you start

Introduction

With this system, you can:

- enjoy audio from discs, USB storage devices, and other external devices
- listen to FM radio stations
- enjoy audio from *Bluetooth* wireless technology enabled device

Playable media:

- Discs: CD-DA, CD-R, CD-RW, MP3-CD, WMA-CD
- Files: .mp3, .wma
- USB storage device
 - Compatibility: USB 1.1/2.0 (Full Speed)
 - Class support: MSC (Mass Storage Class)
 - File system: FAT12, FAT16, FAT32
 - Maximum number of albums/folders: 99
 - Maximum number of tracks/files: 999
 - Maximum level of directory: 8

What's in the box

Check and identify the contents of the package:

- Main unit
- Speaker unit x 2
- Speaker foot x 8
- Remote control
- AAA battery (R03)
- FM wire antenna
- Power cord
- Warranty card
- Operating Instructions (this document)

Loading the battery in the remote control

1 Open the rear lid and load the battery as illustrated below.

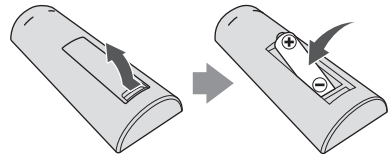

2 Close the rear lid.

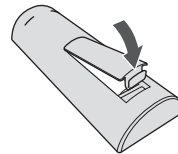

The battery included with the unit has been provided to allow you check product operation and may not last long. We recommend using an alkaline battery that has a longer life.

⚠ CAUTION

- When inserting the battery, make sure not to damage the spring on the battery's \ominus terminal. This can cause the battery to leak or overheat.



Insert the battery by aligning the \ominus pole against the remote control's \ominus terminal

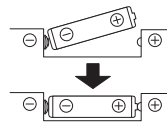

If a battery pushes and bends the \ominus terminal out of shape, there is possibility of the alkaline battery shorting out

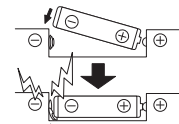

The \ominus terminal is bent out of shape

- Do not use any battery other than the one specified.
- When loading the battery into the remote control, set it in the proper direction, as indicated by the polarity marks (⊕ and ⊖).
- Do not heat the battery, disassemble it, or throw it into flames or water.
- To prevent leakage of battery fluid, remove the battery if you do not plan to use the remote control for a long period of time (1 month or more). If the fluid should leak, wipe it carefully off the inside of the case, then insert a new battery. If a battery should leak and the fluid should get on your skin, flush it off with large quantities of water.
- When disposing of a used battery, please comply with governmental regulations or environmental public institution's rules that apply in your country/area.
- **WARNING**
Do not use or store batteries in direct sunlight or other excessively hot place, such as inside a car or near a heater. This can cause batteries to leak, overheat, explode or catch fire. It can also reduce the life or performance of batteries.

Using speakers horizontally

As well as standing vertically, the speakers for this system can be placed horizontally, as shown below.



If you are going to use the speakers horizontally, attach the supplied speaker foot to the speakers as shown in the illustration below.

- Attach in 4 places to both the left and right speaker.
- Attach to the surface with the passive radiator.

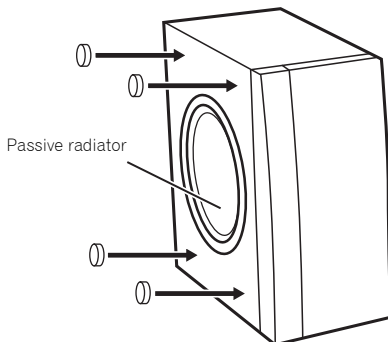

Chapter 2:

Part names and functions

Remote control

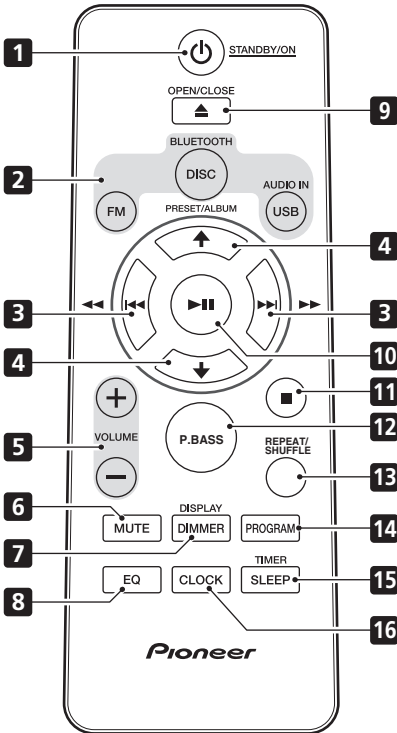

1 **⏻ STANDBY/ON**

- Switch between standby and on.

2 **Input function buttons**

- Use to select the input source (**DISC**, **BLUETOOTH**, **USB**, **AUDIO IN**, **TUNER**).

3 **⏮ ⏪ ⏩ ⏭**

- Skip to the track.
- Press and hold to play quickly within a track.
- Tune to the station.
- Press and hold to search the radio station automatically.

4 **⏮/⏭**

- Skip to the previous or next album.
- Select a preset radio station.

5 **VOLUME +/-**

- Use to set the listening volume.

6 **MUTE**

- Use to mute or restore volume.

7 **DIMMER/DISPLAY**

- Display the current status or media information.
- Display the available ID3 information of MP3 tracks.
- Press and hold to dim or brighten the display. The brightness can be controlled in three steps.
- Display the available information of an RDS radio station.

8 **EQ**

- Use to select EQ.
[FLAT] → [ROCK] → [CLASSIC] → [POP] → [JAZZ] →
 (Back to beginning)

9 **⏻ OPEN/CLOSE**

- Open or close the disc tray.

10 **▶||**

- Use to play, pause, or resume playback.
- Use to confirm actions.

11 **■**

- Use to stop playback.

12 **P.BASS**

- Switch the P.bass mode between on and off.
 When the power is first turned on, the unit will enter the P.bass mode which emphasises the bass frequencies. To cancel the P.bass mode, press the **P.BASS** on the main unit or remote control.

13 **REPEAT/SHUFFLE**

- Use to select the repeat mode or shuffle mode of each input source (page 14).

14 **PROGRAM**

- Use to program audio tracks.
- Use to program radio stations.

15 **SLEEP/TIMER**

- Set the sleep timer in the working mode.
- Set alarm timer in the standby mode.

16 **CLOCK**

- In the working mode or standby mode, press to display the clock for a while.
- In the standby mode, press and hold to set the clock.

Front panel

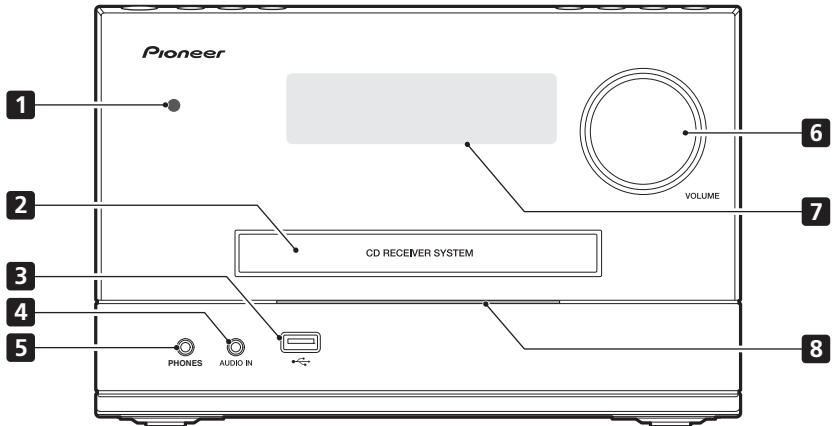

1 Remote control sensor

- Point the remote control to this, and then operate it within approximately 7 m. The product may have trouble capturing remote control signals if there is a fluorescent light nearby. If this happens, move the product away from the fluorescent light.

2 Disc tray

- Place the disc with the label side up.

3

- Connect to a USB storage device.

4 AUDIO IN

- Connect to the audio output socket (usually the headphones socket) of an external device.

5 Headphone socket

- Use to connect headphones. When the headphones are connected, there is no sound output from the speakers (page 13).

6 VOLUME

- Rotate to increase or decrease the volume level.

7 Main display

8 Indicator

- The indicator will blink blue when input is **BLUETOOTH** and white for all others.

Top panel

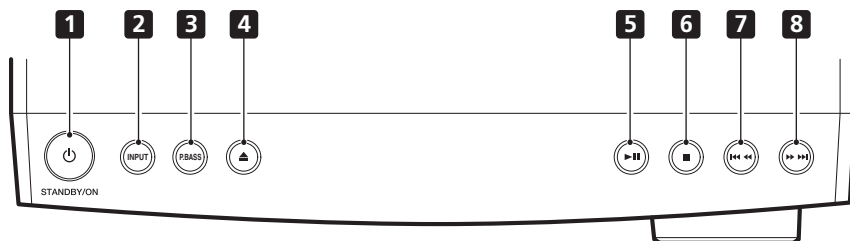

1 **STANDBY/ON**

- Switch between standby and on.

2 **INPUT**

- Press repeatedly to select the input source.

3 **P.BASS**

- Switch the P.bass mode between on and off. When the power is first turned on, the unit will enter the P.bass mode which emphasises the bass frequencies. To cancel the P.bass mode, press the **P.BASS** on the main unit or remote control.

4

- Open or close the disc tray.

5

- Use to play, pause, or resume playback.

6

- Use to stop playback.

7

- Skip to the previous track.
- Press and hold to play reverse quickly within a track.
- Tune to the previous radio station.
- Press and hold to search the previous radio station automatically.

8

- Skip to the next track.
- Press and hold to play forward quickly within a track.
- Tune to the next radio station.
- Press and hold to search the next radio station automatically.

Chapter 3:

Connections

⚠ CAUTION

- Be sure to turn off the power and unplug the power cord from the power outlet whenever making or changing connections.
- Connect the power cord after all the connections between devices have been completed.

Speaker connection

- Push open the tabs and insert exposed wire.
- Use the provided speaker wires to connect this unit with the speakers. Connect the tip of the red wire to the (+) terminal and the tip of the black wire to the (-) terminal.

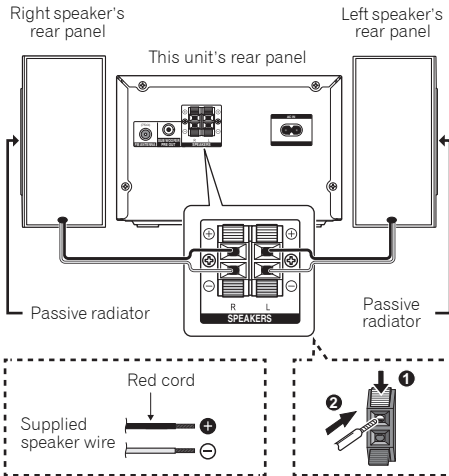
**⚠ CAUTION**

- These speaker terminals carry **HAZARDOUS LIVE voltage**. To prevent the risk of electric shock when connecting or disconnecting the speaker cables, disconnect the power cord before touching any uninsulated parts.
- Do not connect any speakers other than those supplied to this system.
- Do not connect the supplied speakers to any amplifier other than the one supplied with this system. Connection to any other amplifier may result in malfunction or fire.
- Do not attach these speakers to the wall or ceiling. They may fall off and cause injury.

- Make sure that the speaker cable cores do not become exposed and make contact with other cable cores. This may cause malfunction of the product.
- Do not allow the speaker cable core to come into contact with the receiver body.

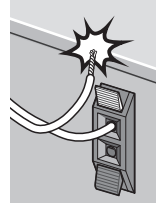

- If the speaker cable core comes into contact with any metal portion of the receiver's body, it may damage the speakers and cause smoke and fire. Insert speaker cables securely into the terminals and check that the cable does not come out of easily.

🔧 Note

- There is no difference between L and R speakers.
- The speakers can also be placed horizontally. See *Using speakers horizontally* (page 6) for details.

Connect the subwoofer

Can add and use powered subwoofer other than those for this system. Use an RCA cable to connect the subwoofer. It is not possible to connect using speaker cables.

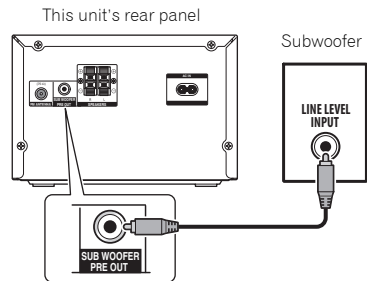
**🔧 Note**

- The subwoofer can be placed on the floor. Putting the speakers on the floor (except the subwoofer), or mounting them very high on a wall is not recommended.

Connecting the FM antenna

Connect the FM antenna plug onto the center pin of the FM antenna socket.

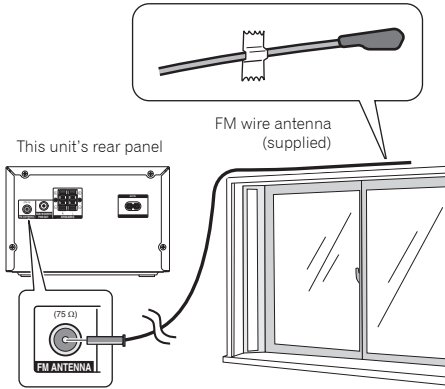

Note

- To ensure optimum reception, make sure the FM antenna is fully extended and not coiled or hanging at the rear of the unit.

Using external antennas

To improve FM reception

Use a PAL connector (not supplied) to connect an external FM antenna.

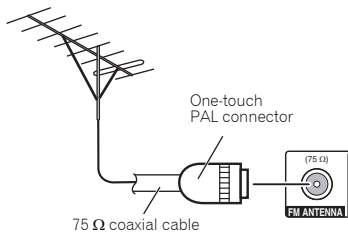

Plugging in

Before making or changing the connections, switch off the power and disconnect the power cord from the AC outlet. After you've finished making all connections, plug the unit into an AC outlet.

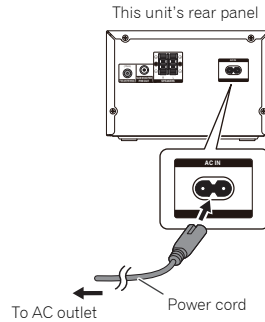

CAUTION

- Do not use any power cord other than the one supplied with this unit.
- Do not use the supplied power cord for any purpose other than that described above.

Chapter 4: Getting started

⚠ CAUTION

- Use of controls or adjustments or performance of procedures other than herein expressly specified may result in hazardous radiation exposure or other unsafe operation.

Always follow the instructions in this chapter in sequence.

Turning on

▶ Press STANDBY/ON

This product switches to the last selected source.

APS mode

- After this product is kept inactive for 15 minutes, it automatically switches to the standby mode.

Setting the clock

Note

- During setting, if no action is made within 90 seconds, the system exits clock setting without saving earlier operations.
- When power supply is restored after unit is plugged in again or after a power failure, reset the clock.

1 In the standby mode, press and hold **CLOCK** to activate clock setting.

[24H] blinks.

2 Press to select [24H] or [12H] and then press **CLOCK** to confirm.

The hour digits will blink.

3 Press to set the hour, and then press **CLOCK** to confirm.

The minute digits blink.

4 Press to set the minute, and then press **CLOCK** to confirm.

Selecting a source

Press **INPUT** repeatedly to select a source.

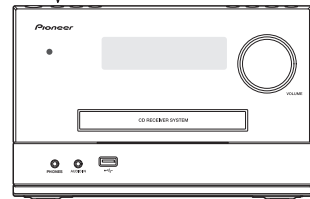
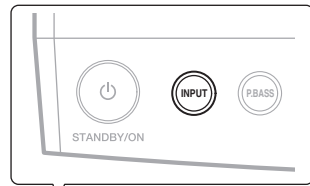

- **[DISC]**: the disc in the disc tray
- **[BLUETOOTH]**: Bluetooth capable device that is paired
- **[USB]**: .wma/.mp3 files stored on the connected USB storage device
- **[TUNER]**: the FM radio
- **[AUDIO IN]**: the audio input through the **AUDIO IN** socket

Using Headphones

Connect to the jack plug of the headphones.
When the headphones are connected, there is no sound output from the speakers.

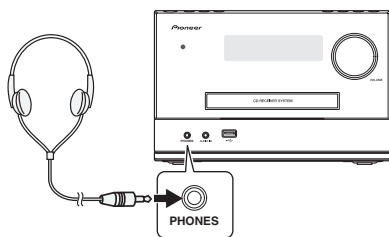

- Do not turn the volume on to full at switch on and listen to music at moderate levels. Excessive sound pressure from earphones and headphones can cause hearing loss.
- Before plugging in or unplugging the headphone, reduce the volume.
- Be sure your headphone has a 3.5 mm diameter plug and impedance between 16 Ω and 50 Ω . The recommended impedance is 32 Ω .

Chapter 5: Playing

Playing a disc

1 Press **DISC** on the remote control or **INPUT** repeatedly on the main unit to switch the source to **[DISC]**.

2 Press **▲** to eject the disc tray.

3 Load a disc with the printed side facing up.

4 Press **▲** again to close the disc tray.

Playback starts automatically after a few seconds.

- If playback does not start automatically, press **▶II** to start playback.

Playing from a USB storage device

This system can play .mp3 and .wma files that are copied onto a supported USB storage device:

- Flash drive
- Memory card reader
- HDD: hard disk drive (This product can detect only a portable HDD with USB power peak current no more than 500 mA.)

Note

- Pioneer does not guarantee compatibility with all USB storage devices.
- NTFS (New Technology File System) file system is not supported.

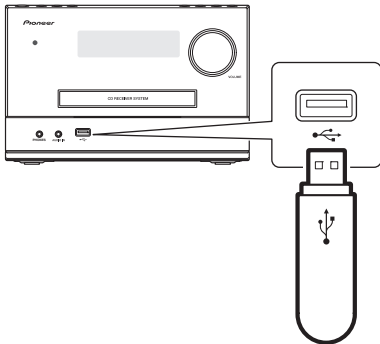

1 Connect the USB storage device to the USB socket.

2 Press **USB** on the remote control or **INPUT** repeatedly on the main unit to switch the source to **[USB]**.

Playback starts automatically.

If playback does not start automatically,

1 Press **↑/↓** to select an album.

2 Press **I◀/▶I** to select a track.

3 Press **▶II** to start playback.

Controlling playback

During playback, follow the instructions below to control playback.

Buttons	Functions
▶II	Pause or resume playback.
■	Stop playback.
I◀/▶I	Skip to the previous or next track. Press and hold to rewind a track or search forward fast within a track.
↑/↓	Skip to the previous or next album when no less than one album exists.
REPEAT/SHUFFLE	Select an available play mode. <ul style="list-style-type: none"> • Repeat 1 [REPEAT ONE]: repeat the current track • Repeat all [REPEAT ALL]: repeat all tracks • Repeat album [REPEAT ALB]: repeat the current album (only USB function)
REPEAT/SHUFFLE	Select an available play mode. <ul style="list-style-type: none"> • Shuffle [SHUFFLE]: play tracks randomly <p>Shuffle [SHUFFLE] is unavailable for programmed tracks.</p>

Programming tracks

Note

- You can program up to 99 tracks.
- During programming, if no operation is made within 90 seconds, the system returns to the stop mode without saving earlier operations.

For a CD

1 Press **■** to stop playback.

[T0], the total number of tracks, and the duration time are displayed.

2 Press **PROGRAM** to activate the programming.

[01 PR01] (the sequence number) are displayed with [01] blinking.

3 Press **◀◀/▶▶** to select a track.

4 Press **PROGRAM** again to program the selected track.

5 Repeat steps 3 and 4 to program more tracks.

6 Press **▶II** to start playback.

For WMA/MP3 files

1 Press **■** to stop playback.

[F XX] (XX indicates the total number of albums) and [XXX] (XXX indicates the total number of tracks) are displayed.

2 Press **PROGRAM** to activate the programming.

[01 PR01] are displayed with [01] blinking.

3 Press **↑/↓** repeatedly to select an album.

[F XX] (XX indicates the album number) are displayed.

4 Press **◀◀/▶▶** repeatedly to select a track.

[XXX] (XXX indicates the track number) are displayed.

5 Press **PROGRAM** again to confirm the selected track.

6 Repeat steps 3 to 5 to program more tracks.

7 Press **▶II** to start playback.

Erasing the program

▶ To erase the program,

- Switch to another source.

Chapter 6:

Bluetooth® Audio playback

Music playback using Bluetooth wireless technology

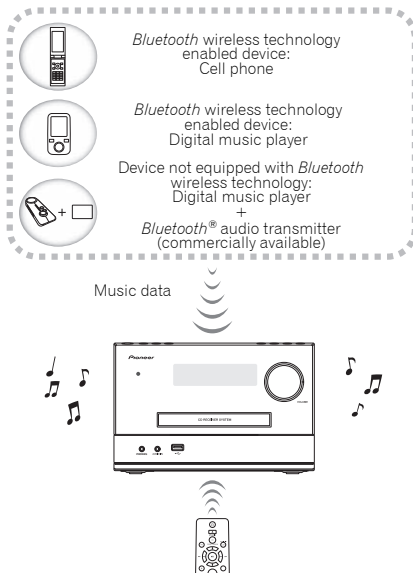

The unit is capable of playing back music stored on Bluetooth capable devices (cell phones, digital music players etc.) wirelessly. You can also use a Bluetooth audio transmitter (sold separately) to enjoy music from devices that do not have Bluetooth functionality. Please refer to the user's manual for your Bluetooth capable device for more details.

Note

- The Bluetooth® word mark and logos are registered trademarks owned by Bluetooth SIG, Inc. and any use of such marks by PIONEER CORPORATION is under license. Other trademarks and trade names are those of their respective owners.
- The Bluetooth wireless technology enabled device must support A2DP profiles.
- Pioneer does not guarantee proper connection and operation of this unit with all Bluetooth wireless technology enabled devices.

Remote control operation

The remote control supplied with this unit allows you to play and stop media, and perform other operations.

Note

- The Bluetooth wireless technology enabled device must support AVRCP profiles.
- Remote control operations cannot be guaranteed for all Bluetooth wireless technology enabled devices.

Pairing with the unit (Initial registration)

In order for the unit to playback music stored on a Bluetooth capable device, pairing must first be performed. Pairing should be performed when first using the unit with the Bluetooth capable device, or when the pairing data on the device has been erased for any reason.

Pairing is a step required to allow communication using Bluetooth wireless technology to be carried out.

- Pairing is only performed the first time that you use the unit and the Bluetooth capable device together.
- In order to allow communication using Bluetooth wireless technology to take place, pairing must be performed on both the unit and the Bluetooth capable device.

1 Press BLUETOOTH on the remote control or INPUT repeatedly on the main unit to switch the source to [BLUETOOTH].

The Bluetooth indicator blinks blue.

2 Turn on the power to the Bluetooth capable device that you wish to pair with, and perform pairing procedure on it.

Note

- This unit will be displayed as "X-PM12" or "X-PM32" on all Bluetooth capable devices that you have.

Pairing will start.

- Place the Bluetooth capable device close to the unit.
- Please refer to the user's manual for your Bluetooth capable device for details on when pairing can be performed and the procedures required for pairing.
- When PIN code entry is requested, enter "0000." (This unit does not accept any PIN code setting other than "0000.")

3 Confirm on the *Bluetooth* capable device that pairing has been completed.

- If pairing with the *Bluetooth* capable device has been completed correctly, a beep will sound, and the *Bluetooth* indicator will switch from blinking to staying lit.
- If the *Bluetooth* indicator will not switch from blinking to staying lit, the pairing was not completed correctly so please try pairing with the unit again.
- If pairing has been completed correctly, you need not repeat this procedure again.

Even devices that have already been paired with this unit will not connect during pairing mode in the following cases.

In such cases, delete pairing history from the *Bluetooth* wireless technology device and perform pairing again.

In order to pair with the unit, press and hold the ►|| on the unit for 3 seconds.

- Up to 8 pairing history can be recorded with this unit. If connecting to a *Bluetooth* wireless technology device over 8 units, the oldest pairing history will be deleted.
- If the settings are reset to the factory setting, all pairing history will be deleted. In order to reset to factory setting, press and hold the ►|| on the unit for more than 8 seconds.

Listen to music on the unit from a *Bluetooth* capable device

1 Press **BLUETOOTH** on the remote control or **INPUT** repeatedly on the main unit to switch the source to **[BLUETOOTH]**.

The unit will start using the **BLUETOOTH** function, and connect with a *Bluetooth* capable device.

2 A *Bluetooth* connection will be created between the *Bluetooth* capable device and the unit.

Procedures for connecting to the unit should be performed from the *Bluetooth* capable device.

- Please refer to the user's manual for your *Bluetooth* capable device for details of the connection procedures.

3 Playback music from the *Bluetooth* capable device.

Note

- When *Bluetooth* capable device is not connected and no operations have been performed for more than 15 minutes, the unit will automatically power off.

Radio wave caution

This unit uses a 2.4 GHz radio wave frequency, which is a band used by other wireless systems (see list below). To prevent noise or interrupted communication, do not use this unit nearby such devices, or make sure these devices are switched off during use.

- Cordless phones
- Cordless facsimiles
- Microwave ovens
- Wireless LAN devices (IEEE802.11b/g)
- Wireless AV equipment
- Wireless controllers for game systems
- Microwave-based health aids
- Some baby monitors

Other, less common, equipment that may operate on the same frequency:

- Anti-theft systems
- Amateur radio stations (HAM)
- Warehouse logistic management systems
- Discrimination systems for train or emergency vehicles

Note

- In the event noise appears in your television image, there is the possibility that a *Bluetooth* wireless technology enabled device or this unit (including products supported by this unit) are causing signal interference with the antenna input connector of your television, video, satellite tuner, etc. In this event, increase the distance between the antenna input connector and the *Bluetooth* wireless technology enabled device or this unit (including products supported by this unit).
- If there is something obstructing the path between this unit (including devices supported by this unit) and the device equipped with *Bluetooth* wireless technology (such as a metal door, concrete wall, or insulation containing tinfoil), you may need to change the location of your system to prevent signal noise and interruptions.

Scope of operation

Use of this unit is limited to home use. (Transmission distances may be reduced depending on communication environment).

In the following locations, poor condition or inability to receive radio waves may cause the audio to be interrupted or stopped:

- In reinforced concrete buildings or steel framed or iron-framed buildings.
- Near large metallic furniture.
- In a crowd of people or near a building or obstacle.
- In a location exposed to the magnetic field, static electricity or radio wave interference from radio communication equipment using the same frequency band (2.4 GHz) as this unit, such as a 2.4 GHz wireless LAN device (IEEE802.11b/g) or microwave oven.

- If you live in a heavily populated residential area (apartment, townhouse, etc.) and if your neighbor's microwave is placed near your system, you may experience radio wave interference. If this occurs, move your unit to a different place. When the microwave is not in use, there will be no radio wave interference.

Radio wave reflections

The radio waves received by this unit include the radio wave coming directly from the device equipped with *Bluetooth* wireless technology (direct wave) and waves coming from various directions due to reflections by walls, furniture and building (reflected waves). The reflected waves (due to obstacles and reflecting objects) further produce a variety of reflected waves as well as variation in reception condition depending on locations. If the audio cannot be received properly due to this phenomenon, try moving the location of the device equipped with *Bluetooth* wireless technology a little. Also note that audio may be interrupted due to the reflected waves when a person crosses or approaches the space between this unit and the device equipped with *Bluetooth* wireless technology.

Precautions regarding connections to products supported by this unit

- Complete connections for all devices supported by this unit, including all audio cords and power cables before connecting them to this unit.
- After completing connections to this unit, check the audio and power cables to confirm that they not twisted together.
- When disconnecting this unit, confirm that you have sufficient working space in the surrounding area.
- When changing connections of audio or other cables for products supported by this unit, confirm that you have sufficient working space in the surrounding area.

Chapter 7:

Listening to the FM radio

Tuning to an FM radio station

 Note

- Make sure that you have connected and fully extended the FM antenna.

1 Press FM on the remote control or INPUT repeatedly on the main unit to switch the source to TUNER.

2 Press and hold ◀◀/▶▶ until the frequency starts to change.

- To tune to a station at a specific frequency, press ◀◀/▶▶ repeatedly until the desired frequency is displayed.

Programming radio stations

 Note

- You can program up to 30 preset radio stations.
- To overwrite a programmed radio station, store another one with its sequence number.

1 Tune to a radio station.

2 Press PROGRAM to activate programming.
[XX] (XX indicates the sequence number) blinks.

3 Press ↑/↓ to allocate a sequence number from 1 to 30 to this radio station, and then press PROGRAM to confirm.

The preset sequence number and the frequency of this radio station are displayed.

4 Repeat steps 1-3 to program more stations.

 Tip

- Press and holding **PROGRAM** will allow you to freely select any radio station. The selected station will be saved automatically.

Tuning to a preset radio station

- Press ↑/↓ to select the sequence number of that preset radio station.

Display RDS information

RDS (Radio Data System) is a service that allows FM stations to show additional information. If you tune to an RDS radio station, [RDS] and the station name are displayed.

1 Tune to an RDS radio station.

2 Press DISPLAY repeatedly to scroll through the available information:

- Station name
- Frequency
- Program type such as [NEWS] (news), [SPORT] (sport), [POP M] (pop music)...
- Text messages
- CT (Clock Time)

Chapter 8: Other features

Turn on automatically

You can set a time for automatic power on.

Note

- Make sure that you have set the clock before this setup.

1 In standby mode, press the CLOCK to display time and then press and hold SLEEP/TIMER.

[SOURCE] (time for auto power on) blinks.

2 Press |◀◀/▶▶| to select [SOURCE].

3 Press SLEEP/TIMER.

The hour digits blink.

4 Press |◀◀/▶▶| to set the hour.

5 Press SLEEP/TIMER again.

The minute digits blink.

6 Press |◀◀/▶▶| to set the minute.

7 Press SLEEP/TIMER again.

8 Press |◀◀/▶▶| to set the volume.

9 Press SLEEP/TIMER.

The clock time and [TIMER] are displayed.

- To deactivate the timer, display the time and then press **SLEEP/TIMER** again.
- The power cannot be turned on while the timer is being set. Finish setting the time, then turn on the power.

Setting the sleep timer

In the working mode, press **SLEEP/TIMER** repeatedly to select a preset period (15, 30, 45, 60, 90 or 120 minutes).

When the sleep timer is activated, [SLEEP] is displayed on the upper-right corner of the main display.

- To deactivate the sleep timer, press **SLEEP/TIMER** repeatedly until [SLEEPOFF] is displayed.

Routing audio from other devices

Through the AUDIO IN socket

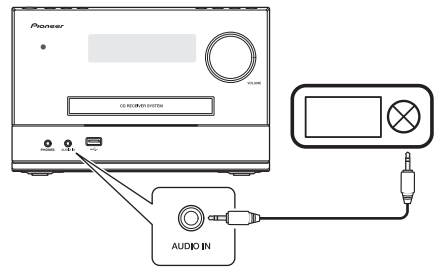

1 Connect a stereo mini-plug cable (commercially available) to

- the **AUDIO IN** socket on the front panel of the main unit, and
- the headphones socket on the external device (for example, an MP3 player).

2 Press AUDIO IN on the remote control or INPUT repeatedly on the main unit to switch the source to [AUDIO IN].

3 Play the external device.

USB 500 mA charge

The USB terminal on this unit has a 500 mA output. A USB device up to 500 mA can be connected and used/charged.

Setting and deactivating the DEMO mode

You can set it to DEMO mode where the display scrolls the words. When the power is off (standby mode) press and hold

- . This will set the DEMO mode. To deactivate, press ■ again.

Chapter 9:

Additional information

USB playability information

Compatible USB devices:

- USB flash memory (USB1.1/2.0 (Full Speed))
- USB flash players (USB1.1/2.0 (Full Speed))
- Memory cards (an additional card reader is required)

Supported formats:

- USB or memory file format FAT12, FAT16, FAT32 (sector size: 512 bytes)
- MP3 bitrates (data rates): 32 kbps to 320 kbps and variable bitrates
- WMA v9 or earlier
- Directory nesting up to 8 levels
- Number of albums/folders: maximum 99
- Number of tracks/files: maximum 999 (depending on file name length)
- ID3 tag v2.0 or later (Only English letters and numbers are supported.)
- File name in Unicode UTF8 (maximum length: 16 bytes)

Audio files cannot be played depending on the encoding software settings, USB device type, recording, other conditions.

Unsupported formats:

- Empty albums: an album that does not contain MP3/WMA files
- Unsupported file formats are skipped. For example, Word documents (.doc) or MP3 files with extension.dif are ignored and not played.
- AAC, WAV, PCM audio files
- DRM protected WMA files (.wav, .m4a, .m4p, .mp4, .aac)
- WMA files in Lossless format

Supported MP3 disc formats

- ISO9660, Joliet
- Maximum track/file number: 999 (depending on file name length)
- Maximum album number: 99
- Supported sampling frequencies: 32 kHz, 44.1 kHz, 48 kHz
- Supported bitrates: 32 kbps to 320 kbps, variable bitrates

Audio files cannot be played depending on the encoding software settings, USB device type, recording, other conditions.

RDS program types

NO TYPE	No RDS programme type
NEWS	News services
AFFAIRS	Politics and current affairs
INFO	Special information programs
SPORT	Sports
EDUCATE	Education and advanced training
DRAMA	Radio plays and literature
CULTURE	Culture, religion and society
SCIENCE	Science
VARIED	Entertainment programs
POP M	Pop music
ROCK M	Rock music
EASY M	Light music
LIGHT M	Light classical music
CLASSICS	Classical music
OTHER M	Special music programs
WEATHER	Weather
FINANCE	Finance
CHILDREN	Children's programs
SOCIAL	Social Affairs
RELIGION	Religion
PHONE IN	Phone In
TRAVEL	Travel
LEISURE	Leisure
JAZZ	Jazz Music
COUNTRY	Country Music
NATION M	National Music
OLDIES	Oldies Music
FOLK M	Folk Music
DOCUMENT	Documentary
TES	Alarm Test
ALARM	Alarm

Troubleshooting

⚠ WARNING

- Never remove the casing of this apparatus.

Incorrect operation is often mistaken for trouble or malfunction. If you think that there is something wrong with this component, check the points below. Sometimes the trouble may lie in another component. Inspect the other components and electrical appliances being used. If the trouble cannot be rectified even after checking the points below, ask your nearest Pioneer authorized service center or your dealer to carry out repair work.

- If the unit does not operate normally due to external effects such as static electricity, disconnect the power plug from the outlet and insert it again to return to normal operating conditions.

Problem	Solution
No power.	Make sure that the AC power cord is connected properly.
	Make sure that there is power at the AC outlet.
	With a power-saving feature, the system switches off automatically 15 minutes after the system stays inactive.
No sound or poor sound.	Adjust the volume.
	Make sure that the speakers are connected correctly.
No response from the system.	Reconnect the AC power plug, and then turn on the system again.
	With a power-saving feature, the system switches off automatically 15 minutes after the system stays inactive.
Remote control does not work.	Reduce the distance between the remote control and the main unit.
	Insert battery with its polarity (+/- signs) aligned as indicated.
	Replace the batteries.
	Aim the remote control directly at the sensor on the front panel of the main unit.
No disc is detected.	Insert a disc.
	Make sure that you place the disc with its label facing upwards.
	Wait until the moisture condensation at the lens has cleared.
	Replace or clean the disc.
USB storage device is not supported.	Make sure that the recordable disc is finalized and the format is supported.
	Is the USB storage device connected properly? Make sure that the device is firmly inserted.
Cannot play some files on the USB storage device.	Make sure that the USB storage device is compatible with the system.
	Make sure that the file format is supported.
Radio reception is poor.	Make sure that the file quantity does not exceed the maximum. (page 21)
	Increase the distance between the system and other electrical appliances.
Timer does not work.	Fully extend the antenna.
	Set the clock correctly.
Clock/timer setting is erased.	Switch on the timer.
	Power has been interrupted or the AC power cord has been disconnected.
	Reset the clock/timer.

When the Bluetooth wireless technology device is connected or operated

Problem	Solution
<p>The <i>Bluetooth</i> wireless technology device cannot be connected or operated. Sound from the <i>Bluetooth</i> wireless technology device is not emitted or the sound is interrupted.</p>	<p>Check that no object that emits electromagnetic waves in the 2.4 GHz band (microwave oven, wireless LAN device or <i>Bluetooth</i> wireless technology apparatus) is near the unit. If such an object is near the unit, set the unit far from it. Or, stop using the object emitting the electromagnetic waves.</p> <hr/> <p>Check that the <i>Bluetooth</i> wireless technology device is not too far from the unit and that obstructions are not set between the <i>Bluetooth</i> wireless technology device and the unit. Set the <i>Bluetooth</i> wireless technology device and the unit so that the distance between them is less than about 10 m* and no obstructions exist between them.</p> <p>* The distance given is to be used as a rough guide. The actual allowable distance between devices may vary depending on conditions in the surrounding environment.</p> <hr/> <p>The <i>Bluetooth</i> wireless technology device may not be set to the communication mode supporting the <i>Bluetooth</i> wireless technology. Check the setting of the <i>Bluetooth</i> wireless technology device.</p>

Cautions on use

When moving this unit

When moving this unit, be sure to first check that there is no disc loaded. Then press **STANDBY/ON**, wait until **[GOOD BYE]** disappears on main display to turn off, and then unplug the power cord. Damage may occur if the unit is transported or moved with a disc inserted, or when another device is connected to the USB terminal, or **AUDIO IN** mini-plug jack.

Place of installation

- Choose a stable place near the TV or stereo system being used with this unit.
- Do not place this unit on top of a TV or color monitor. Also, install it away from cassette decks and other devices easily affected by magnetic forces.

Avoid the following locations:

- Places exposed to direct sunlight
- Humid or poorly ventilated places
- Extremely hot places
- Places exposed to vibrations
- Places in which there is much dust or cigarette smoke
- Places exposed to soot, steam, or heat (kitchens, etc.)

Do not place objects on this unit

Do not place any objects on top of this unit.

Do not obstruct the ventilation holes.

Do not use this unit on shaggy rugs, beds, sofas, etc., or wrapped in cloth, etc. Doing so will prevent the heat from dispersing, leading to damage.

Do not expose to heat.

Do not place this unit on top of an amplifier or other components that generate heat. When rack mounting it, to avoid the heat given off by the amplifier or other audio components, place it on a shelf below the amplifier.

- Turn off the power of this unit when not using it.
- Depending on signal conditions, striped patterns may appear on a TV screen and noise may enter the sound of radio broadcasts when the power of this unit is on. If this happens, turn off the power of this unit.

Cleaning the product

- Unplug the power cord from the power outlet when cleaning this unit.
- Clean this unit using a soft cloth. For tough dirt, apply some neutral detergent diluted in 5 to 6 parts water to a soft cloth, wring out thoroughly, wipe off the dirt, and then wipe again with a soft, dry cloth.
- Alcohol, thinner, benzene, insecticides, etc., could cause the print or paint to peel off. Also, leaving rubber or vinyl products in contact with this unit for long periods of time could mar the cabinet.
- When using chemical-impregnated wipes, etc., read the cautions included with the wipes carefully.

Cleaning the lens

- The lens of this unit should not become dirty in normal use, but if for some reason it should malfunction due to dust or dirt, consult your nearest Pioneer authorized service center. Although lens cleaners for players are commercially available, we advise against using them since some may damage the lens.

Handling discs

Storing

- Always place discs in their cases and store them vertically, avoiding hot, humid places, places exposed to direct sunlight and extremely cold places.
- Be sure to read the cautions included with the disc.

Cleaning discs

- Discs may not play if there are fingerprints or dust on them. In this case, use a cleaning cloth, etc., to gently wipe the disc from the inside towards the outside. Do not use dirty cleaning cloths.



- Do not use benzene, thinner or other volatile chemicals. Also, do not use record spray or antistatic agents.
- For tough dirt, apply some water to a soft cloth, wring out thoroughly, wipe off the dirt, and then wipe off the moisture with a dry cloth.
- Do not use damaged (cracked or warped) discs.
- Do not let the signal surface of discs get scratched or dirty.

- Do not attach pieces of paper or stickers to discs. Doing so could warp discs, making it impossible to play them. Also, note that rental discs often have labels attached to them, and the glue of the label may have oozed out. Check that there is no glue around the edges of such labels before using rented discs.

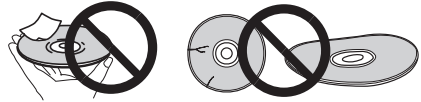

About specially shaped discs

Specially shaped discs (heart-shaped, hexagonal, etc.) cannot be played on this unit. Do not attempt to play such discs, as they could damage this unit.



Specifications

• Amplifier

Rated Output Power

X-PM12	30 W + 30 W, RMS, 1 kHz, 6 Ω, 10 % 38 W + 38 W (30 % THD, only AUDIO IN)
X-PM32	60 W + 60 W, RMS, 1 kHz, 6 Ω, 10 % 75 W + 75 W (30 % THD, only AUDIO IN)

• Disc

Disc diameter	12 cm, 8 cm
Support discs	CD-DA, CD-R, CD-RW, MP3-CD, WMA-CD
Frequency response	60 Hz to 16 kHz (44.1 kHz)

• Tuner (FM)

Tuning range	87.5 MHz to 108 MHz
--------------	---------------------

• Bluetooth

Version	Bluetooth Specification Ver. 4.0
Output	Bluetooth Specification Class 2
Estimated line-of-sight transmission distance*	About 10 m
Frequency range	2.401 GHz to 2.480 GHz ISM Band
Modulation	FH-SS (Frequency Hopping Spread Spectrum)
Supported Bluetooth profiles	A2DP, AVRCP
Supported Codec	SBC (Subband Codec)
Supported contents protection	SMSC-T
* The line-of-sight transmission distance is an estimate.	
Actual transmission distances supported may differ depending on surrounding conditions.	

• Speakers

Enclosure	Bass-Reflex Type
Configuration	2-way
Tweeter	.5 cm cone
Speakers	
X-PM12	
Tweeter	.5 cm cone
Woofer	.9 cm cone
Passive radiator	.12 cm cone
X-PM32	
Tweeter	.5 cm cone
Woofer	.9 cm cone x 2
Passive radiator	.12 cm cone
Impedance	6 Ω
Dimensions	
X-PM12	140 mm (W) x 290 mm (H) x 272 mm (D)
X-PM32	140 mm (W) x 290 mm (H) x 312 mm (D)
Weight	
X-PM12	2.36 kg
X-PM32	3.08 kg

• General information

AC power	220 V to 240 V, 50 Hz/60 Hz
Operation power consumption	
X-PM12	30 W
X-PM32	40 W
Standby power consumption	≤ 0.5 W
USB Direct	USB 1.1/2.0 (Full Speed)
USB 5V Power	≤ 500 mA
Dimensions	230 mm (W) x 150 mm (H) x 248 mm (D)
Weight	
X-PM12	2.12 kg
X-PM32	2.22 kg

Note

- The specifications and design of this product are subject to change without notice.
- Corporation and product names mentioned herein are trademarks or registered trademarks of the respective corporations.

© 2014 PIONEER HOME ELECTRONICS CORPORATION.
All rights reserved.

Declaration of Conformity with regard to the R&TTE Directive 1999/5/EC

Manufacturer:

PIONEER HOME ELECTRONICS CORPORATION

1-1, Shin-ogura, Saiwai-ku,
Kawasaki-shi, Kanagawa
212-0031, Japan

EU Representative's:

Pioneer Europe NV

Haven 1087, Keetberglaan 1,
9120 Melsele, Belgium
<http://www.pioneer.eu>



[*] X-PM12, X-PM32

English:

Hereby, Pioneer, declares that this [*] is in compliance with the essential requirements and other relevant provisions of Directive 1999/5/EC.

Suomi:

Pioneer vakuuttaa täten että [*] tyyppinen laite on direktiivin 1999/5/EY oleellisten vaatimusten ja sitä koskevien direktiivin muiden ehtojen mukainen.

Nederlands:

Hierbij verklaart Pioneer dat het toestel [*] in overeenstemming is met de essentiële eisen en de andere relevante bepalingen van richtlijn 1999/5/EG

Français:

Par la présente Pioneer déclare que l'appareil [*] est conforme aux exigences essentielles et aux autres dispositions pertinentes de la directive 1999/5/CE

Svenska:

Härmed intygar Pioneer att denna [*] står i överensstämmelse med de väsentliga egenskapskrav och övriga relevanta bestämmelser som framgår av direktiv 1999/5/EG.

Dansk:

Undertegnede Pioneer erklærer herved, at følgende udstyr [*] overholder de væsentlige krav og øvrige relevante krav i direktiv 1999/5/EF

Deutsch:

Hiermit erkläre Pioneer, dass sich dieses [*] in Übereinstimmung mit den grundlegenden Anforderungen und den anderen relevanten Vorschriften der Richtlinie 1999/5/EG befindet". (BMW i)

Ελληνικά:

ΜΕ ΤΗΝ ΠΑΡΟΥΣΑ Pioneer ΔΗΛΩΝΕΙ ΟΤΙ [*] ΣΥΜΜΟΡΦΩΝΕΤΑΙ ΠΡΟΣ ΤΙΣ ΟΥΣΙΩΔΕΙΣ ΑΠΑΙΤΗΣΕΙΣ ΚΑΙ ΤΙΣ ΛΟΙΠΕΣ ΣΧΕΤΙΚΕΣ ΔΙΑΤΑΞΕΙΣ ΤΗΣ ΟΔΗΓΙΑΣ 1999/5/EK

Italiano:

Con la presente Pioneer dichiara che questo [*] è conforme ai requisiti essenziali ed alle altre disposizioni pertinenti stabilite dalla direttiva 1999/5/CE.

Español:

Por medio de la presente Pioneer declara que el [*] cumple con los requisitos esenciales y cualesquiera otras disposiciones aplicables o exigibles de la Directiva 1999/5/CE

Português:

Pioneer declara que este [*] está conforme com os requisitos essenciais e outras disposições da Directiva 1999/5/CE.

Čeština:

Pioneer tímto prohlašuje, že tento [*] je ve shodě se základními požadavky a dalšími příslušnými ustanoveními směrnice 1999/5/ES

Eesti:

Käesolevaga kinnitab Pioneer seadme [*] vastavust direktiivi 1999/5/EÜ põhinõuetele ja nimetatud direktiivist tulenevatele teistele asjakohastele sätetele.

Magyar:

Alulírott, Pioneer nyilatkozom, hogy a [*] megfelel a vonatkozó alapvető követelményeknek és az 1999/5/EC irányelv egyéb előírásainak.

Latviešu valoda:

Ar šo Pioneer deklarē, ka [*] atbilst Direktīvas 1999/5/EK būtiskajām prasībām un citiem ar to saistītajiem noteikumiem.

Lietuvių kalba:

Šiuo Pioneer deklaruoja, kad šis [*] atitinka esminius reikalavimus ir kitas 1999/5/EB Direktyvos nuostatas.

Malti:

Hawnhekk, Pioneer jiddikjara li dan [*] jikkonforma mal-ftiġġijiet essenzjali u ma provvedimenti oħrajn relevanti li hemm fid-Dirrettiva 1999/5/EC

Slovenčina:

Pioneer týmto vyhlasuje, že [*] spĺňa základné požiadavky a všetky príslušné ustanovenia Smernice 1999/5/ES.

Slovenščina:

Pioneer izjavlja, da je ta [*] v skladu z bistvenimi zahtevami in ostalimi relevantnimi določili direktive 1999/5/ES.

Română:

Prin prezenta, Pioneer declara ca acest [*] este in conformitate cu cerintele esentiale si alte prevederi ale Directivei 1999/5/EU.

български:

С настоящето, Pioneer декларира, че този [*] отговаря на основните изисквания и други съответни постановления на Директива 1999/5/EC.

Polski:

Niniejszym Pioneer oświadcza, że [*] jest zgodny z zasadniczymi wymogami oraz pozostałymi stosownymi postanowieniami Dyrektywy 1999/5/EC

Norsk:

Pioneer erklærer herved at utstyret [*] er i samsvar med de grunnleggende krav og øvrige relevante krav i direktiv 1999/5/EF.

Íslenska:

Hér með lýsir Pioneer yfir því að [*] er í samræmi við grunnkröfur og aðrar kröfur, sem gerðar eru í tilskipun 1999/5/EC

Hrvatski:

Ovime tvrtka Pioneer izjavlja da je ovaj [*] u skladu osnovnim zahtjevima i ostalim odredbama Direktive 1999/5/EC.

<http://www.pioneer.co.uk>
<http://www.pioneer.eu>

© 2014 PIONEER HOME ELECTRONICS CORPORATION.
All rights reserved.

PIONEER HOME ELECTRONICS CORPORATION

1-1, Shin-ogura, Saiwai-ku, Kawasaki-shi, Kanagawa 212-0031, Japan

PIONEER ELECTRONICS (USA) INC.

P.O. BOX 1540, Long Beach, California 90801-1540, U.S.A. TEL: (800) 421-1404

PIONEER ELECTRONICS OF CANADA, INC.

340 Ferrier Street, Unit 2, Markham, Ontario L3R 2Z5, Canada TEL: 1-877-283-5901, 905-479-4411

PIONEER EUROPE NV

Haven 1087, Keetberglaan 1, B-9120 Melsele, Belgium TEL: 03/570.05.11

PIONEER ELECTRONICS ASIACENTRE PTE. LTD.

253 Alexandra Road, #04-01, Singapore 159936 TEL: 65-6472-7555

PIONEER ELECTRONICS AUSTRALIA PTY. LTD.

5 Arco Lane, Heatherton, Victoria, 3202, Australia, TEL: (03) 9586-6300

PIONEER ELECTRONICS DE MEXICO S.A. DE C.V.

Bldv.Manuel Avila Camacho 138 10 piso Col.Lomas de Chapultepec, Mexico, D.F. 11000 TEL: 55-9178-4270

K002_B3_En