

Desktop & Instrument Cases

6000 Series Venti Cases

ABS desk cases available with inclined recessed aluminium front panels.

- Moulded in high impact ABS
- Aluminium lid mounted by 4x M3 screws
- Polished finish for ease of cleaning
- PCB pillars in base
- Integral PCB slots in front and rear walls
- Ventilation slots in base

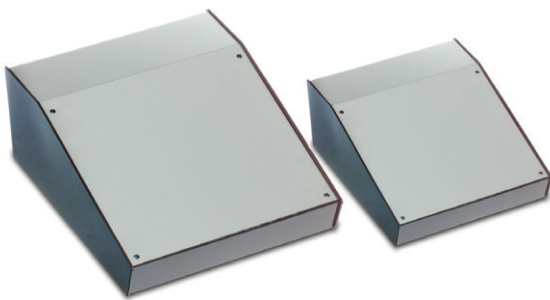

SPECIFICATION	
Materials	Base high impact ABS as standard, UL-94 VO ABS to order Panels 1mm thick aluminium
Operating temperature	Resistant to temperatures up to 85°C
Standard colours	Base grey & black as standard, white to order Aluminium panel grey
Standard unit includes	Base & aluminium panel 4x M3 machine screws 4x rubber feet

BLACK	GREY	LENGTH	WIDTH	HEIGHT
BIM6005-BLK/PG	BIM6005-GY/PG	143mm	105mm	55mm
BIM6006-BLK/PG	BIM6006-GY/PG	143mm	170mm	55mm
BIM6007-BLK/PG	BIM6007-GY/PG	214mm	170mm	82mm

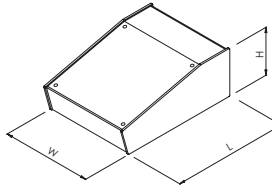

desktop &
instrument
cases

ASSEMBLY

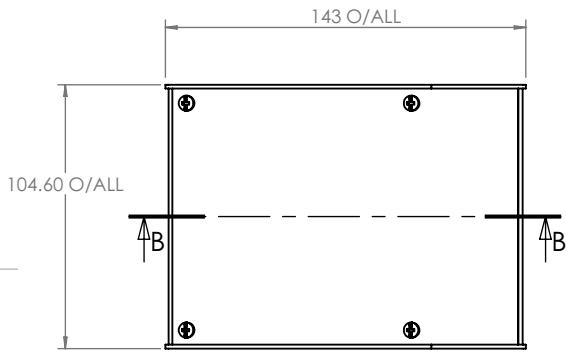
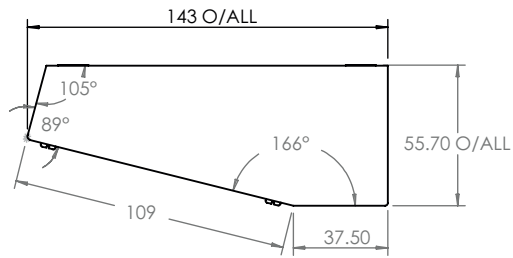

SECTION B-B

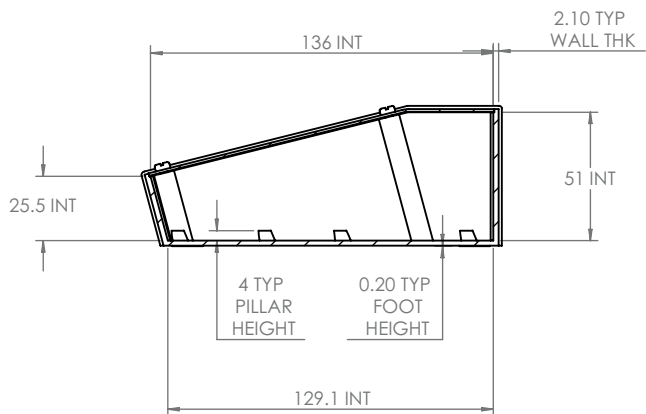

LID

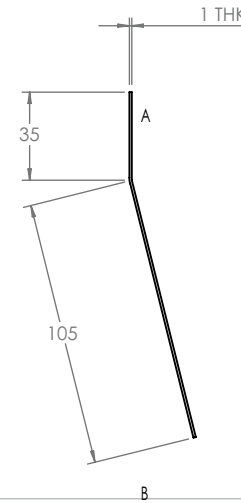
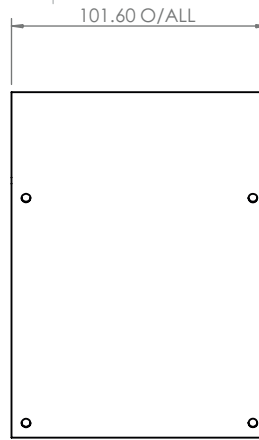

BASE

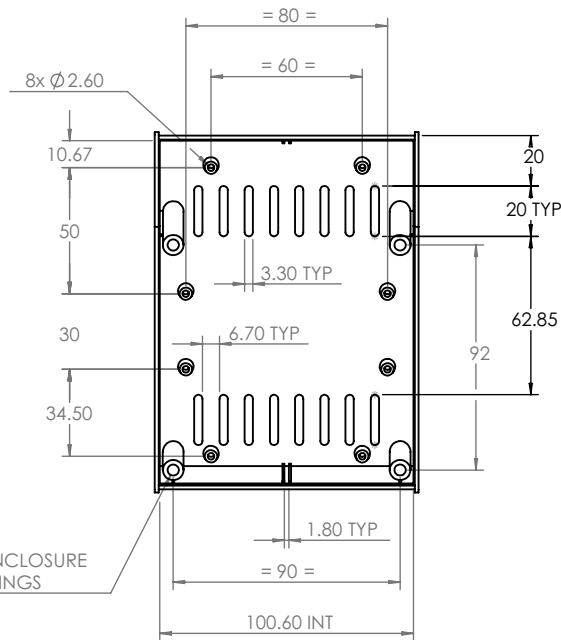

**ISO VIEW
1:4**

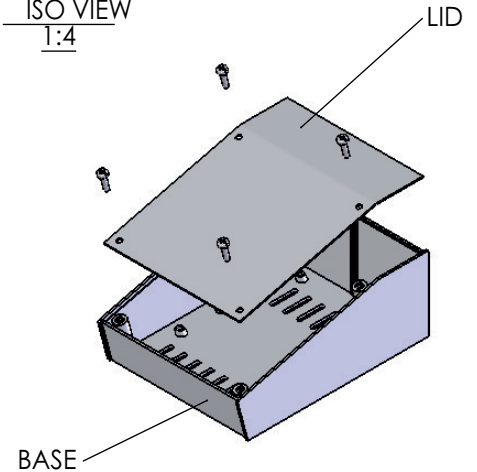

UNLESS OTHERWISE SPECIFIED:
DIMENSIONS ARE IN MILLIMETERS

FINISH:
SMOOTH

MATERIAL:
ABS & ALUMINIUM

PROJECTION:

DO NOT SCALE DRAWING

REVISION. 0

TITLE:
GNL ASSY DRG FOR 6000 SERIES

DWG NO.

6005

A4

	NAME	SIGNED	DATE
DRAWN	L SUBKHANKULOVA	LS	10/12/09
CHK'D	STUART HARDINGE	SJH	10/12/09

SCALE: 1:3

SHEET 1 OF 1

ASSEMBLY

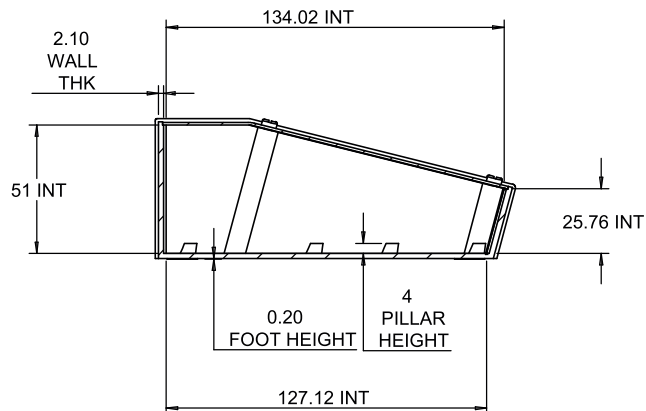
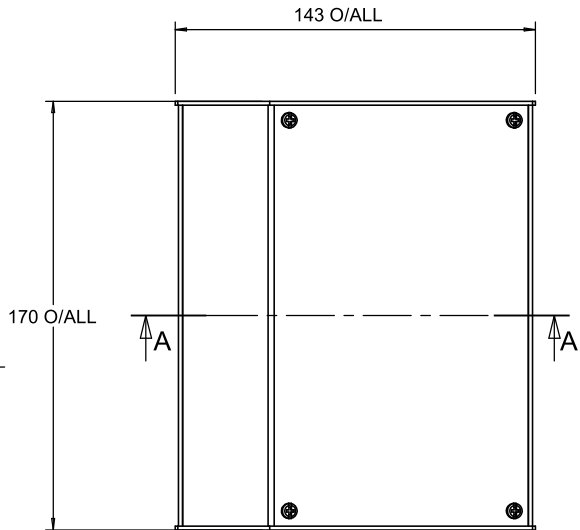
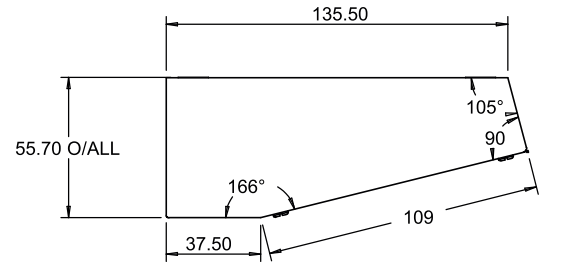

SECTION A-A

LID

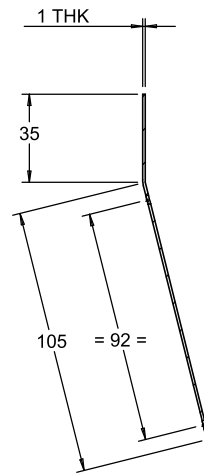
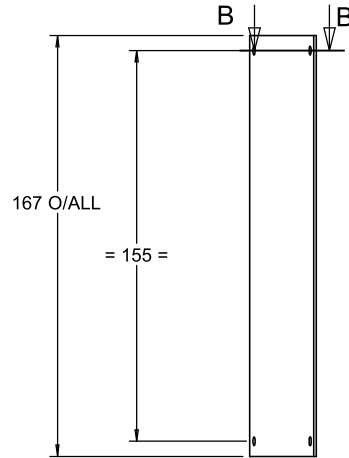

SECTION B-B

**ISO VIEW
1:5**

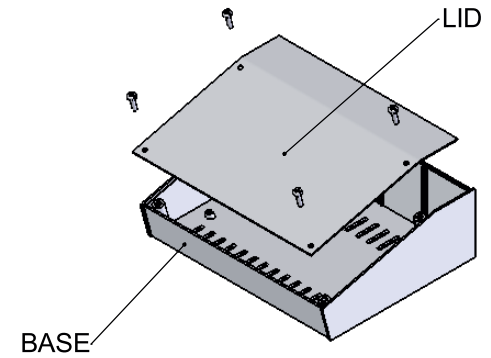

BASE

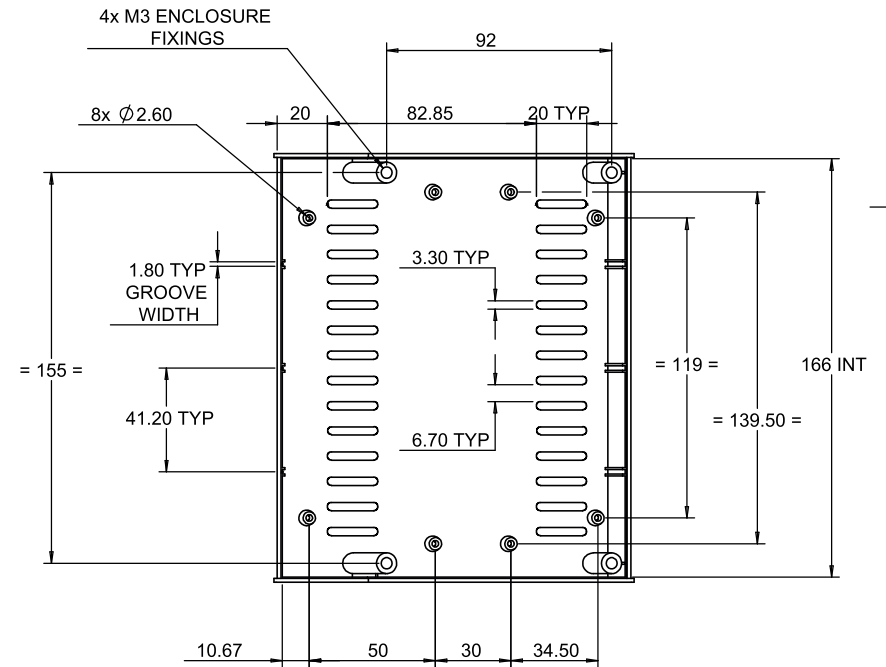

UNLESS OTHERWISE SPECIFIED:
DIMENSIONS ARE IN MILLIMETERS

FINISH:
SMOOTH

MATERIAL:
ABS & ALUMINIUM

PROJECTION:

DO NOT SCALE DRAWING

REVISION: 0

TITLE:
**GENERAL ASSEMBLY DRG FOR
6000 SERIES**

DRAWN	NAME	SIGNED	DATE
CHK'D	STUART HARDINGE	SJH	16/07/09

DWG NO. **6006**

A4

SCALE: 1:2

SHEET 1 OF 1

ASSEMBLY

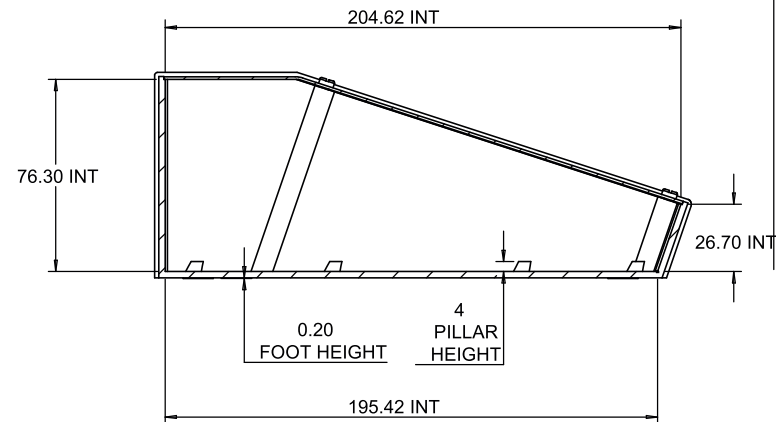
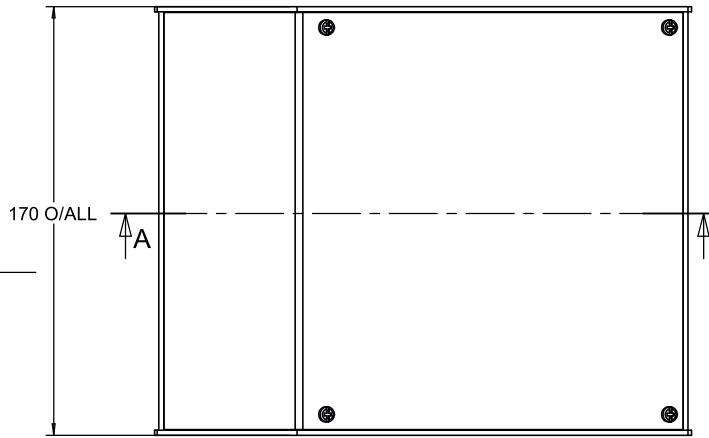
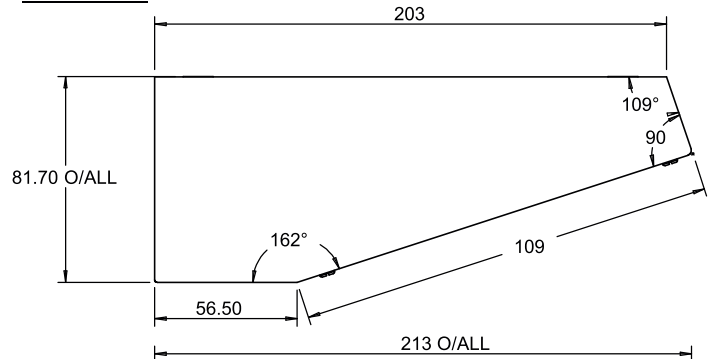

LID

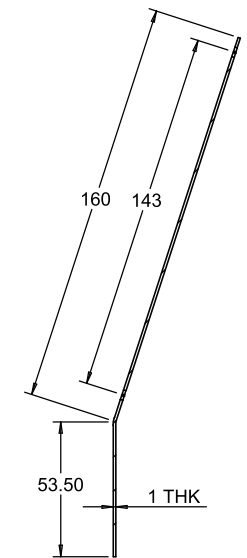
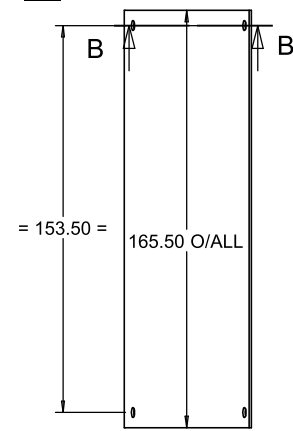

SECTION B-B

ISO VIEW
1:5

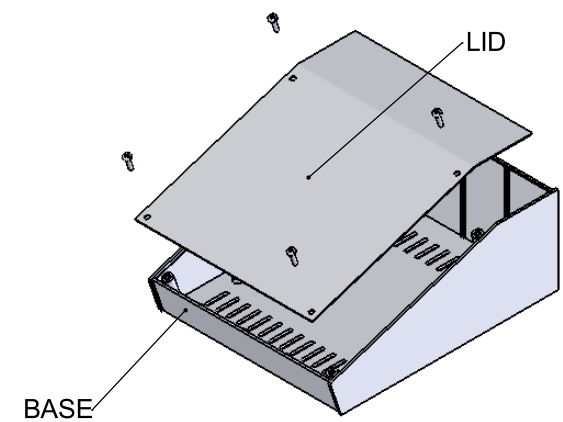

BASE

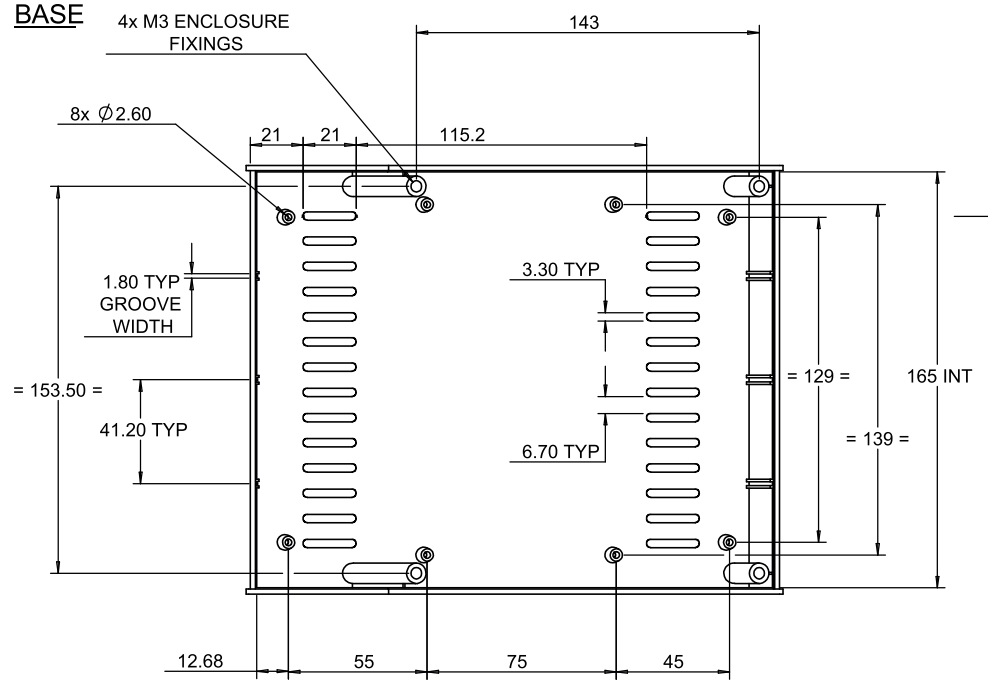

UNLESS OTHERWISE SPECIFIED:
DIMENSIONS ARE IN MILLIMETERS

DO NOT SCALE DRAWING

REVISION. 0

FINISH.
SMOOTH

TITLE:
**GENERAL ASSEMBLY DRG FOR
6000 SERIES**

	NAME	SIGNED	DATE
DRAWN	SUBKHANKULOVA	LS	16/07/09
CHK'D	STUART HARDINGE	SJH	16/07/09

MATERIAL.
ABS & ALUMINIUM

PROJECTION.

DWG NO.	6007	A4
SCALE. 1 : 3	SHEET 1 OF 1	