

Red Dot Lasermodule

DBI650-1-3-FA(12x40)-F3400

Order Number: 70113303

Main Parameters (*)	min	typ	max	Unit
Wavelength		650		nm
Optical Output Power		1		mW
Operating Voltage	2.7	3	3.3	V DC
Operating Current	10	21	30	mA
Operating Temperature	-20		50	°C
Storage Temperature	-40		80	°C

Optical Parameters

Beam Shape	Dot
Laser Class	2
Divergence	0.3mrad
Size of Laserdot	<1.25mm@3.4m
Operating Distance	3.4m
Optics	glass lens AR coated
Laser technology	Single Mode Diode
Focus	fixed (3400mm)

Technical Parameters

Lifetime	>5000h
RoHS	yes

Electrical Parameters

Potential of Housing	isolated
----------------------	----------

Mechanical Parameters

Size	Ø12x40mm
Material	aluminium
Cable length	100mm
Wire type	26AWG, 0,14mm ²
Output Aperture	5mm
Housing Color	black
Weight	10.5g
Stripping of wire	5mm

(*) Over the complete operating temperature range

Features





- Operating Voltage 3V DC
- Isolated housing
- Laser Class 2
- Fixed focus
- Compact size

Picture



Cable Colors

Ground		black	GND
Positive		red	2.7 - 3.3, typ 3V DC

Drawing

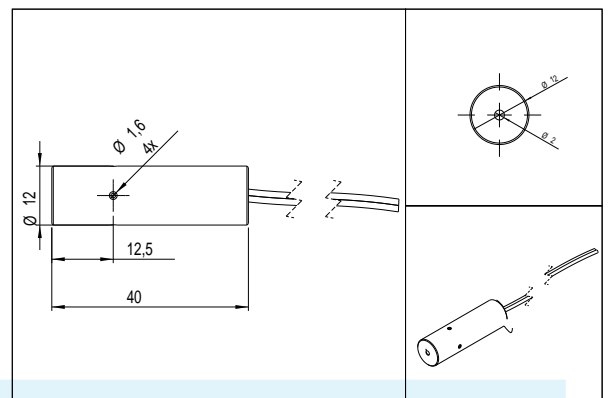

Safety Label

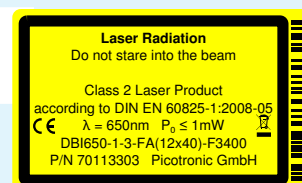

Revision

REV 1 | 11-JUL-2014