

KRUPS

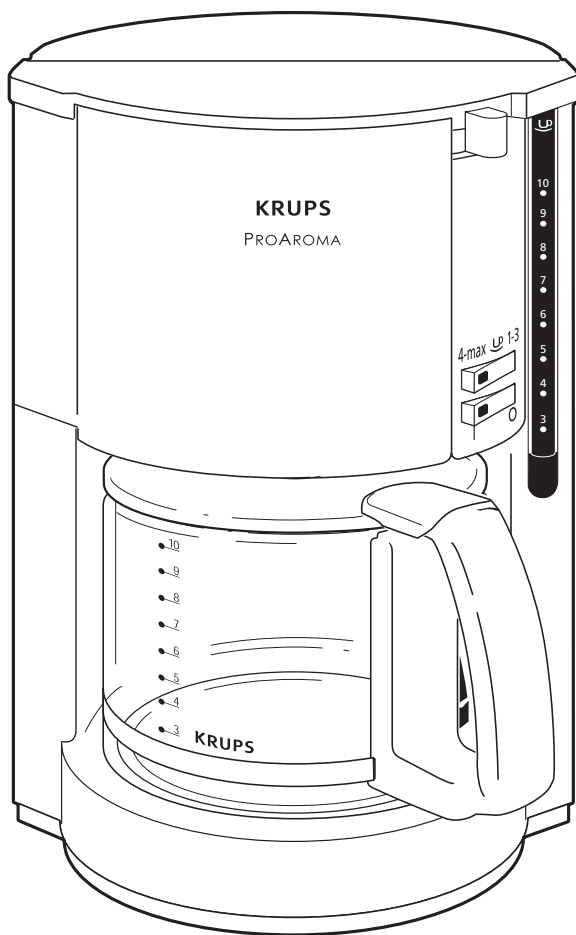

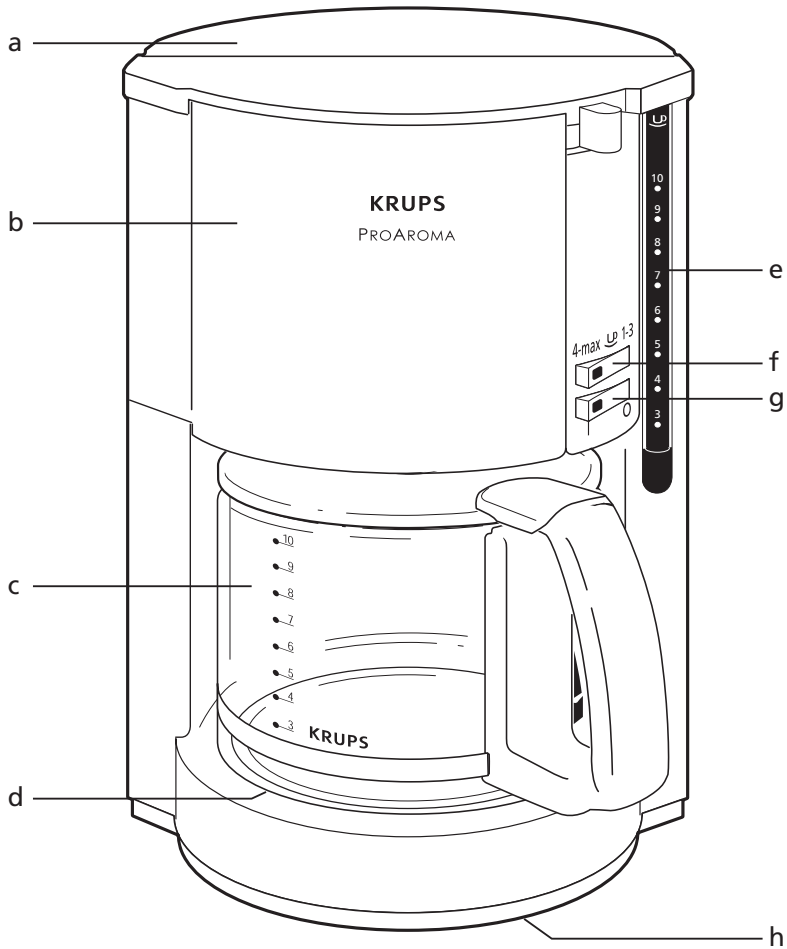

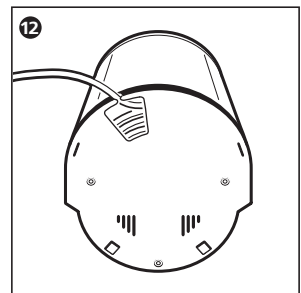
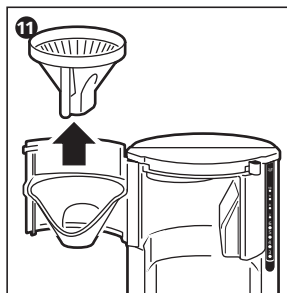
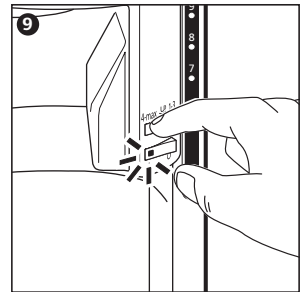
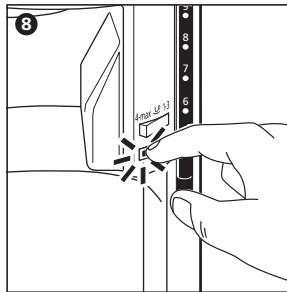
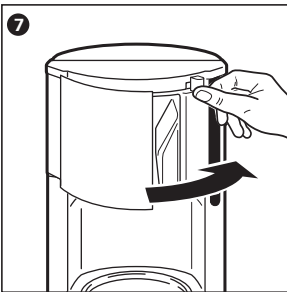
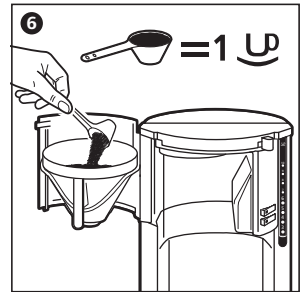
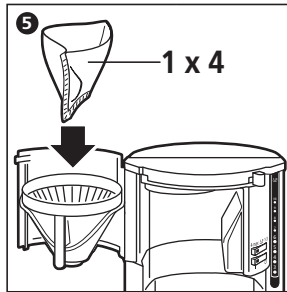
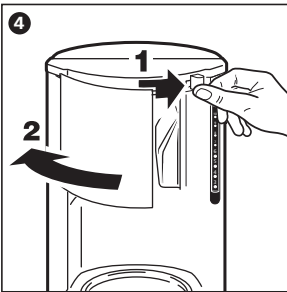
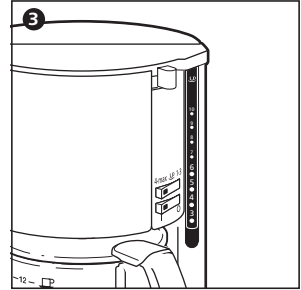
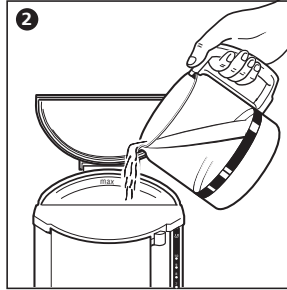
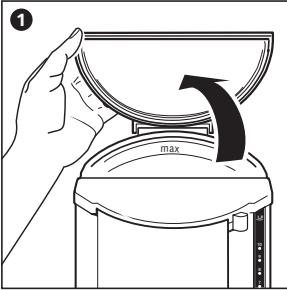

Safety recommendations



- Read the operating instructions carefully before the first use of your appliance – any use which is not in accordance with the operating instructions will release Krups from all responsibility.
- This appliance is not intended for use by persons (including children) with reduced physical, sensory or mental capacities, or lack of experience and knowledge, unless they have been given supervision or instruction concerning use of the appliance by a person responsible for their safety. Children should be supervised to ensure that they do not play with the appliance.
- Before connecting the appliance, check that the supply voltage of your installation is the same as that of the appliance and that the mains socket includes an earth connection.

Any connection error will invalidate your guarantee.

- Your appliance is intended for domestic use only and indoors.
- Disconnect your appliance during an extended absence and when you are cleaning it.
- Do not use your appliance if it is not working correctly or if it has been damaged. In this case, contact a Krups approved service centre.
- Any intervention other than cleaning and normal servicing by the customer must be carried out by a Krups approved service centre.
- If the power cord is damaged, do not use the appliance. In order to avoid all danger, you must have the power cord replaced by the manufacturer, its after-sales service or staff with similar qualifications.
- Do not put the appliance, the power cord or the plug in water or any other liquid.
- Do not allow the power cord to dangle.
- The power cable must never come close to or into contact with the hot parts of your appliance, near to a heat source, or on a sharp edge.
- For your safety, use only Krups accessories and spare parts which are suitable for your appliance.
- Do not disconnect the plug from the socket by pulling on the cord.
- Do not use the jug in a microwave oven, on an open flame or on electric cooker hotplates.
- Do not put water in the appliance if it is still hot.
- All the appliances are subject to very strict quality checks. Practical working tests are carried out on appliances selected at random and this accounts for any trace of previous use.
- This product has been designed for domestic use only. Any commercial use, inappropriate use or failure to comply with the instructions, the manufacturer accepts no responsibility and the guarantee will not apply.

Before first use

- Operate the coffee maker for the first time without coffee, and with a full tank of water to rinse the circuit.

Preparation of the coffee

- Follow the illustrations from **1 to 10**.
- Use only cold water and a No.4 filter paper.
- An anti-drip system allows you to remove the jug during the process. Replace it quickly to prevent overflowing.
- Do not exceed the maximum quantity of water.

Place the coffee grounds directly in the permanent filter. After use, throw out the used coffee, and rinse the filter with running water.

Your coffee maker is equipped with a «reinforced aroma» system for one to three cups (according to model):

This system allows you to prolong the flow time of the water if you want only 1,2 or 3 cups. **(9)**

By pressing the switch f, water will flow more slowly over the grounds which will give a better flavour and aroma to your coffee.

Your coffee maker is equipped with an automatic stop system (according to model):

- The appliance stops heating automatically after 2 hours.
- The appliance can be switched off at any time by moving the switch to the «0» position.

Pro Aroma lid:

After passage of the coffee, the last drop leaving the filter closes the opening in the jug lid.

Cleaning

- Unplug the appliance.
- Do not clean the appliance when hot.
- Clean with a damp cloth or sponge.
- Never put the appliance in water or under running water. **(11)**
- To remove the used grounds, remove filter holder from the coffee maker.
- The jug, the lid and the filter holder can be washed in the dishwasher.

Scale removal

- Descale your coffee maker every 40 cycles of use.
- You can use:
 - . either a sachet of descaler diluted in 2 large cups of water.
 - . or 2 large cups of white vinegar

Pour the mixture into the tank and start your coffee maker (without any coffee grounds). Allow the equivalent of one cupful to pour through into the jug, and then stop the coffee maker. Allow the remaining solution to work for one hour. Re-start your coffee maker to finish the flow, and then operate it 2 or 3 times with fresh water (and a full tank).

N.B.: Do not leave the sachet of descaler within the reach of children.

The guarantee does not cover coffee makers which are not working or which are working poorly due to failure to descale them.

Storing the cord

Any unused cord can be stored underneath the appliance. **(12)**

In the event of problems

- Check:
 - . the connection.
 - . that the switch or the selector (according to model) is in the «I» position.
- If the water flow time or the noise is excessive:
 - . descale your coffee maker

Your appliance still does not work? Please contact our Customer Relations Team first for expert help and advice:-

HELPLINE: 0845 602 1454 – UK

(01) 677 4003 - ROI

Or consult our website: www.krups.co.uk



Environment protection first !

- ① Your appliance contains valuable materials which can be recovered or recycled.
- ➡ Leave it at a local civic waste collection point.

En p. 6 - 7

0828 284

De/En/Fr/Nl/Dk/No/Sv/Su