

# Using Instructions

## Solar LED Light tube



These instructions relate **ONLY** to this product and contain important information for using the product for the first time. Please keep these instructions for later reference and should always accompany the product in the event of transference to a new user.

### 1. Introduction

Dear Customer, thank you for purchasing this product.  
With this product you purchased a state-of-the-art product.

**CE** The product complies with the requirements of the applicable European and national directives. The conformity has been verified; the manufacturer is in possession of the relevant declarations and documents.

In order to maintain this condition and to ensure safe operation, the user must observe this operating manual.

### 2. Safety instructions



**The guarantee and warranty claim becomes invalid if the product is damaged as a result of failure to observe these operating instructions. We are not liable for any resulting consequential damages!**  
**The same shall apply to property and personal damages caused by any improper handling and non-observance of the safety instructions.**

- Make sure that the product does not get into the hands of children, it is not a toy!
- Keep plastic foils and packaging material out of reach of children, there is a risk of suffocation.
- The accident-prevention regulations, established by the Employer's Liability Insurance Association for electrical equipment and facilities, must be adhered to in industrial facilities.

### 3. Intended Use and Function

The light tube is automatically switched on at darkness and switched out at morning light. The maximum duration of illumination amounts to approx. 10 hours with fully charged batteries. The solar module installed in the upper side of the housing charges the integrated battery.

2 toggle switches are installed at the bottom side of the solar module. One switch is used to switch the chain of lights on and off, the other switch is used in order to switch between permanent light and flashing light.

The light tube is suitable for outdoor use but must not be immersed into a pond.

**Note:** Please make sure that the solar module is installed directed to the south and that shadows are avoided. The product cannot be used if installed directed to the north. In winter, the solar module shall always be free of snow.

### 4. Assembly and Activation

1. Please carefully take all parts out of the package and unroll the light tube.
2. Wrap the light tube around shrub, bush, bar or similar. Make sure that the light tube is not permanently placed in water (e.g. pond). Rain or snow will not damage the light tube; it is suitable for outdoor use.
3. Switch the toggle switch on the bottom side of the housing in position "ON". The light tube is now switched on. The second switch is used to choose between the operating mode "permanent light" and "flashing light".
  - **Note:** The light tube is switched off in position "OFF" and the battery will not be charged.
4. The control unit may be plugged into the ground by means of a ground spike and screwed to the floor and/or wall by means of the mounting.
5. The solar light tube is now activated!

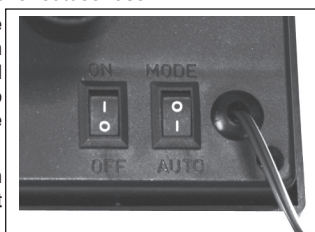

**Note:** Illumination time is generally expected to be less during the winter months. Should the light not be switched on on the first evening, please wait for a sunny day.

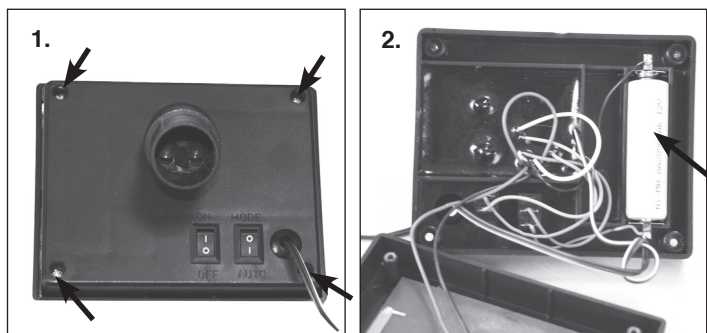

### 5. Replacing the Battery

The capacity of the battery pack will decrease after one to two years and the battery pack has to be replaced. Batteries are available in retail stores or from the manufacturer. Only allowed are batteries identical in construction.

1. Unscrew the 4 screws at the bottom side of the housing and take off the lid (illustration 1).
2. Remove the battery from the bracket.
3. Insert the new battery with correct polarity and close the housing in reverse order.

**Note:** Used batteries or accumulators must be disposed of in a non-polluting way and do not belong into the domestic waste. Your dealer is required by law to take back old batteries.

### 6. Malfunctions

#### The lamp is not switched on at darkness

- Is the light activated/switched on?
- A source of extraneous light (e.g. street lamp) simulates daylight on the solar module and prevents the activation. Place the lamp at a darker place.

#### The lamp is not switched on at darkness at all or only for a short time.

- Incorrect polarity when replacing the battery?
- Battery weak or defective? Replace the battery.

### 7. Technical Data

Solar module:	0.6 Wp
Battery:	NiMh 1.2 V/2000 mAh, Mignon (AA)
Type of protection:	IP 44
Protection class:	III
Illuminant:	50 light emitting diodes (LEDs)
Luminous color:	item.-Nr: 102157: 10000 K (cold white) item.-Nr: 102159: 2800 K (warmwhite)
Tube length:	7 m (5 m with LED's)
Tube length to the first LED:	approx. 2 m
Length between the LEDs:	approx. 10 cm
Duration of illumination:	max. 10 hours with fully charged battery pack

### Battery take-back

- Batteries must not be discarded into domestic waste.
- The consumer is legally required to return batteries after use, e.g. to public collecting centers or to battery distributors.
- Contaminant-containing batteries are labeled with the sign "crossed-out trashcan" and one of the chemical symbols. Used batteries should be disposed environmentally friendly and should not be discarded into domestic waste. Your dealer is legally required to take back old batteries.



NiMh

### Manufacturer/Importer:

esotec GmbH - Weberschlag 9 - D-92729 Weierhammer  
Tel.-Nr: +49 9605-92206-0 Fax.-Nr: +49 9605-92206-10  
e-mail: info@esotec.de Internet: www.esotec.de  
**Product Art.-Nr: 102157, 102159**  
WEEE: DE59284711

### Disposal:

Dear customer,  
please cooperate in avoiding waste. When you intend to dispose of the product in future, please consider that it contains valuable raw materials suited for recycling. Therefore, do not dispose of it with domestic waste but bring it to a collection point for the recycling of waste electrical and electronic equipment.



Thank you very much for your cooperation!