

REVISION RECORD				
REV	ECN	DESCRIPTION	DRFT	DATE

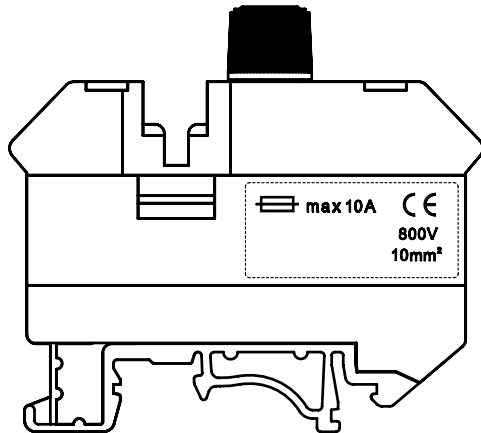

VIEW C

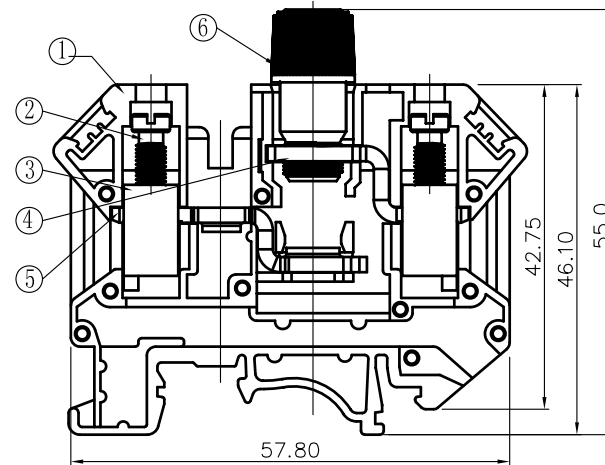
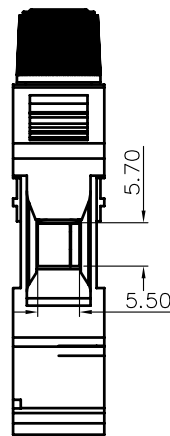
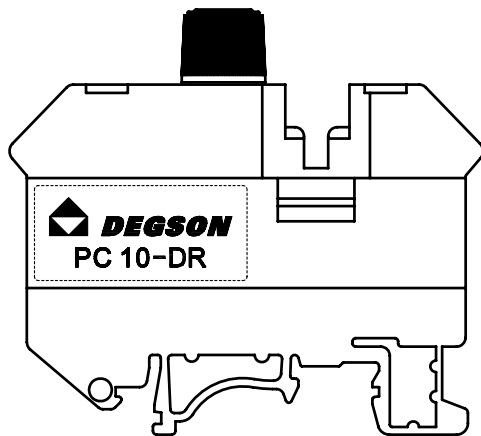
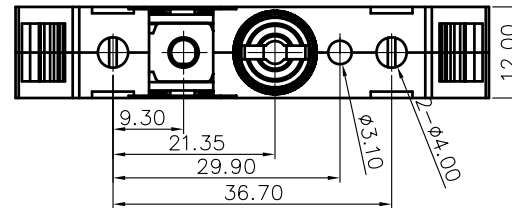

NOTES:

- DIMENSION SHALL BE INTERPRETED PER ASME Y14.5-2009.
- RATED VOLTAGE/CURRENT: UL1059 300V/10A IEC 800V/10A
- OPERATION TEMPERATURES: -40°C ~ +105°C
- WITHSTANDING VOLTAGE: AC3000V/1MIN
- INSULATION RESISTANCE: 5000MΩ/DC1000V
- WIRE RANGE: 14~6AWG, 10MM²
- TORQUE VALUE: M4, 12.24KGF.CM
- UNDIMENSIONED TOLERANCES:

Pitch range in mm		Nominal dimension range in mm				
to	over	to	over	to	over	
6	6 to 10	10 to 24	30 to 60	60 to 100	100 to 150	∅
	±0.10	±0.15	±0.25	±0.2	±0.3	±0.5
						±0.7
						±1.0

6	PC10-DR Fuse Housing	6091D0101A(H)	1		
5	PC10-DR Double hole current	6091B00020(H)	1	Copper	SnCe plated
4	PC10-DR Single hole current	6091B00010(H)	1	Copper	SnCe plated
3	PC10-PE-Brass Cage	X000001290(H)	2	Brass	Ni plated
2	PC 6-Screw	S000001490(H)	2	Brass	Ni plated

ITEM	NAME OF PART	NO. OF PART	Q'TY	MATERIAL	NOTES
1	PC10-DR Housing	6091A0Y01A(H)	1	PA66	UL94V-0

MM (INCH)		MATERIAL:			
TOLERANCES EXCEPT AS NOTED		FINISH:			
.X ±	.X' ±	PART NO.:	NAME: PC10-DR-01P-1Y-00A(H)		
.XX ±	.XX' ±	APPD:			
.XXX ±	.XXX' ±	CHKD:			
ANGLES ± 1'		DRFT: LIUM 03/13/08"	TITLE: ASSEMBLY DRAWING	REV	T3
THIRD ANGLE PROJECTION		DO NOT SCALE DRAWING	DRAWING NO.: PC10-DR-E01	SCALE	N/A
			SHEET	1/1	