

REVISION RECORD				
REV	ECN	DESCRIPTION	DRFT	DATE

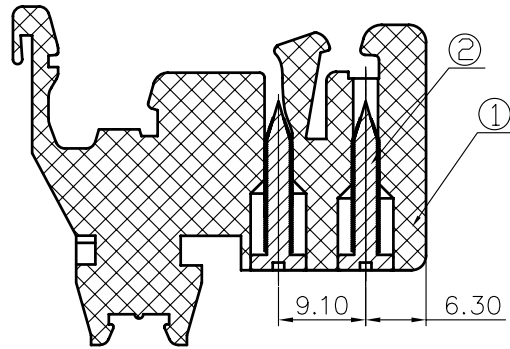

SEC A-A

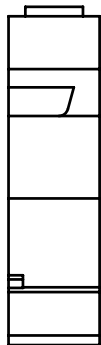
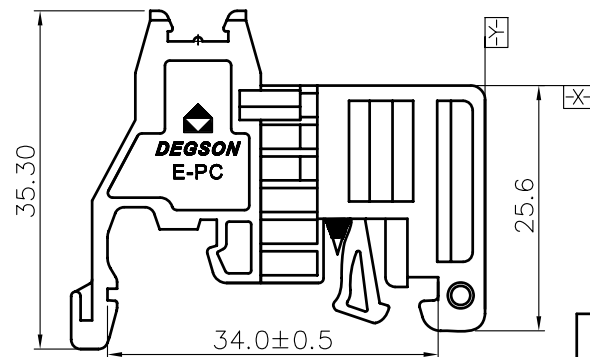
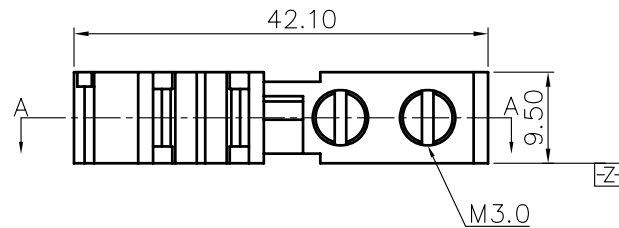

NOTES:

- 1.DIMENSION SHALL BE INTERPRETED PER ASME Y14.5-2009.
- 2.OPERATION TEMPERATURES: -40 °C~+105 °C
- 3.TORQUE VALUE: 5.1KGF.CM
- 4.UNDIMENSIONED TOLERANCES:

PITCH RANGE IN MM		NOMINAL DIMENSION RANGE IN MM				
TO	OVER	OVER	TO	OVER	OVER	-
6	6 TO 10	10 TO 24	30	30 TO 60	100 TO 150	
					OVER 150	∩
						∇
						±0.10 ±0.15 ±0.25 ±0.20 ±0.30 ±0.50 ±0.70 ±1.00 0.05/10

2	E-PC-SCREW	S000001900(H)	1	Steel	C ₃ ⁺ Zn
1	E-PC-HOUSING	600410Y01A(H)	1	PA66	UL94V-0
ITEM	NAME OF PART	NO. OF PART	Q"TY	MATERIAL	NOTES

MM (INCH)		MATERIAL:			
TOLERANCES EXCEPT AS NOTED		FINISH:			
.X ±	.X' ±	PART NO.:		NAME:	
.XX ±	.XX' ±	APPD: _____ CHKD: _____ DRFT: Lin 06/15/06"		E-PC-01P-1Y-00A(H)	
.XXX ±	.XXX' ±			TITLE: ASSEMBLY DRAWING	
ANGLES ± 1°		THIRD ANGLE PROJECTION		DRAWING NO.: E-PC-E01	
				DO NOT SCALE DRAWING	
				SCALE	N/A
				SHEET	1/1