

# Grease Gun (T6270)

## Filling and Operating Instructions

### Cartridge Loading (standard 14oz grease cartridge)

- Unscrew the grease gun barrel from the pump head.
- Fully pull back the plunger handle.
- Remove both end caps from the grease cartridge.
- Insert the grease cartridge into the barrel ensuring that the end with the smaller diameter hole will be facing the pump head.
- Screw the barrel back onto the pump head.
- Release the plunger by pressing down the release catch whilst pulling back the plunger handle.
- It is important that the plunger is correctly located in the end of the cartridge. To ensure that it is, push the plunger down whilst pressing down the release catch and then tap the end of the barrel on a hard surface.

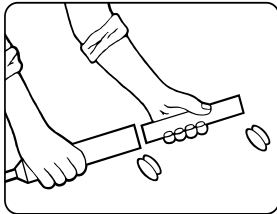

### Suction Filling (from bulk grease)

- Unscrew the grease gun barrel from the pump head.
- Insert the open end into the grease.
- Slowly pull back the plunger handle ensuring that the barrel remains immersed in the grease.
- Remove the excess grease and screw the barrel back on to the pump head.
- Release the plunger by pressing down the release catch whilst pulling back the plunger handle.
- Press down the plunger release catch to allow the plunger to compress the grease.
- Vent the gun of air by unscrewing the barrel (half turn only) from the pump head, don't forget to re-tighten afterwards.

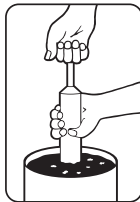

### Filling from Grease Gun Filler

- Fully pull back the plunger handle.
- Insert the filler nipple (located on the side of the pump head) into the filler connector.
- Release the plunger by pressing down the release catch whilst pulling back the plunger handle.
- Fill the gun as necessary.
- Press down the plunger release catch to allow the plunger to compress the grease.
- Vent the gun of air by unscrewing the barrel (half turn only) from the pump head, don't forget to re-tighten afterwards.

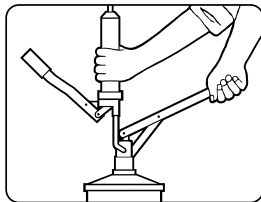

### Operating Instructions

- After filling the gun with grease, screw in the angled tube and nipple connector.
- Pump the handle a few times until grease is visible at the nipple connector.
- Push the connector onto the nipple ensuring that the jaws grip the nipple securely.
- Pump the handle until sufficient grease has been applied.

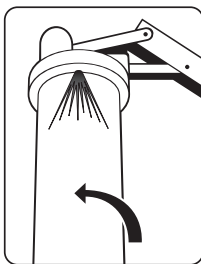

# Grease Gun (T6270)

## Filling and Operating Instructions

### Cartridge Loading (standard 14oz grease cartridge)

- Unscrew the grease gun barrel from the pump head.
- Fully pull back the plunger handle.
- Remove both end caps from the grease cartridge.
- Insert the grease cartridge into the barrel ensuring that the end with the smaller diameter hole will be facing the pump head.
- Screw the barrel back onto the pump head.
- Release the plunger by pressing down the release catch whilst pulling back the plunger handle.
- It is important that the plunger is correctly located in the end of the cartridge. To ensure that it is, push the plunger down whilst pressing down the release catch and then tap the end of the barrel on a hard surface.

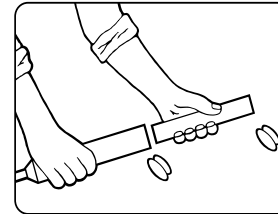

### Suction Filling (from bulk grease)

- Unscrew the grease gun barrel from the pump head.
- Insert the open end into the grease.
- Slowly pull back the plunger handle ensuring that the barrel remains immersed in the grease.
- Remove the excess grease and screw the barrel back on to the pump head.
- Release the plunger by pressing down the release catch whilst pulling back the plunger handle.
- Press down the plunger release catch to allow the plunger to compress the grease.
- Vent the gun of air by unscrewing the barrel (half turn only) from the pump head, don't forget to re-tighten afterwards.

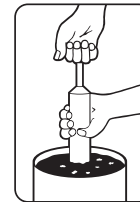

### Filling from Grease Gun Filler

- Fully pull back the plunger handle.
- Insert the filler nipple (located on the side of the pump head) into the filler connector.
- Release the plunger by pressing down the release catch whilst pulling back the plunger handle.
- Fill the gun as necessary.
- Press down the plunger release catch to allow the plunger to compress the grease.
- Vent the gun of air by unscrewing the barrel (half turn only) from the pump head, don't forget to re-tighten afterwards.

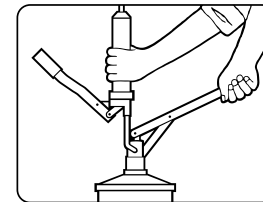

### Operating Instructions

- After filling the gun with grease, screw in the angled tube and nipple connector.
- Pump the handle a few times until grease is visible at the nipple connector.
- Push the connector onto the nipple ensuring that the jaws grip the nipple securely.
- Pump the handle until sufficient grease has been applied.

