

Kennzeichnung/marking:

Cat.5 SF/UTP 4x2xAWG26/7 PVC LI2Y(ST)CY IEC 60332-1 -40°C ~ +75°C **RJ** AWM STYLE 20276 30V 75°C E81280
 (sequential length in metres)

Kabelmantel / cable jacket: PVC grün / green RAL 6018

angespritzte Tülle / moulded strain relief: grün / green RAL 6018

vollgeschirmter Stecker A
fully screened plug A

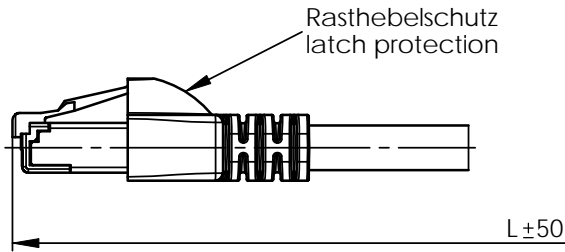

vollgeschirmter Stecker B
fully screened plug B

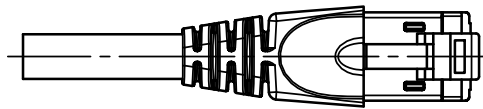
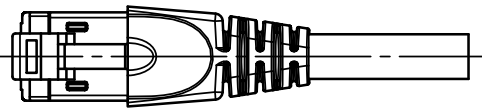
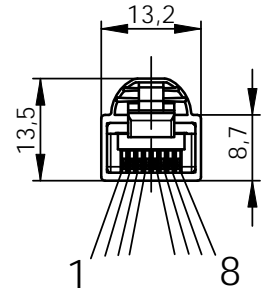
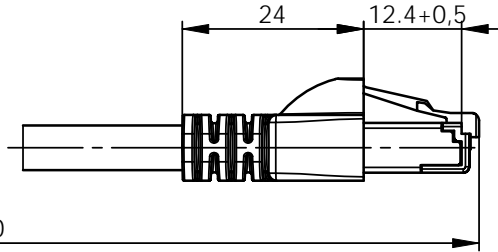

Schaltbild / Connection Diagram 1:1

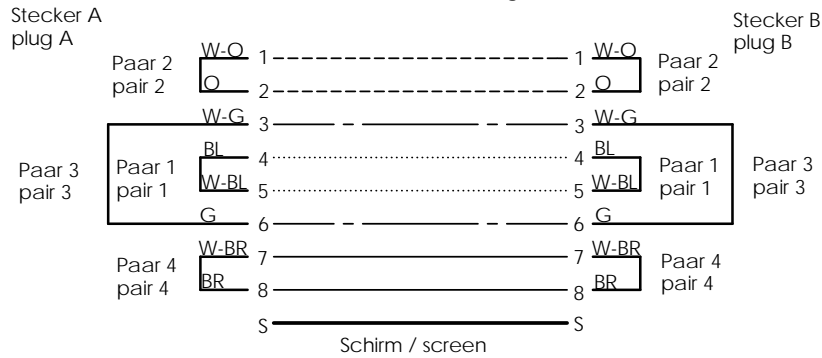

Norm / Specification
 DIN EN 60603-7-5
 IEC 61935-2 / Edition 2

Geprüft mit Fluke DSP 4300, DTX 1800, Software CLC-C5 und Patch Cord Interface
 Tested with Fluke DSP 4300, DTX 1800, software CLC-C5 and patch cord interface

c b a	2006	Datum/ date	Name/ name	Gewicht/ weight [g]	Oberfläche/ surface [mm ²]	Werkstoff/ material
	gez./ drawn	08.08.	BM			
	gepr./ appr.	11.08.06	SK			Oberfläche/ finish
	Norm/ stand.					
	Maßstab/ scale	Benennung/ title				 Telegärtner
	1:1	Modular Patch Cable SF/UTP Cat.5 PVC RJ45/IP20-RJ45/IP20				
	untol. Maße/ dim. without tolerances according to	Untert./ doc. type	Zeichnungsnr./ drawing no.			 Maße/ dimensions: mm
		K	L00000A0138			
And./ rev. index	Anderungsmittellung/ revision code	Datum/ date	Name/ name	Ersatz für/ replaces	Original : DIN A4 Blatt/ sheet 1 von/ of 2	

L (mm)	TG-Nr. / TG P/N	Kurzbezeichnung / short name	Meterangabe auf Knickschutztülle meter mark on	Verpackungseinheit pro Karton packing units per box
1000	L00000A0138	SF/UTP Cat.5 PVC IP20-IP20-1,0 m	1.0M	90 Stück / pieces
2000	L00001A0130	SF/UTP Cat.5 PVC IP20-IP20-2,0 m	2.0M	60 Stück / pieces
3000	L00002A0147	SF/UTP Cat.5 PVC IP20-IP20-3,0 m	3.0M	45 Stück / pieces
5000	L00003A0088	SF/UTP Cat.5 PVC IP20-IP20-5,0 m	5.0M	35 Stück / pieces

Verpackung / packing:
 Einzelverpackt in PE-Beutel mit Aufkleber
 single packing in PE bag with label

ohne Maßstab
without scale

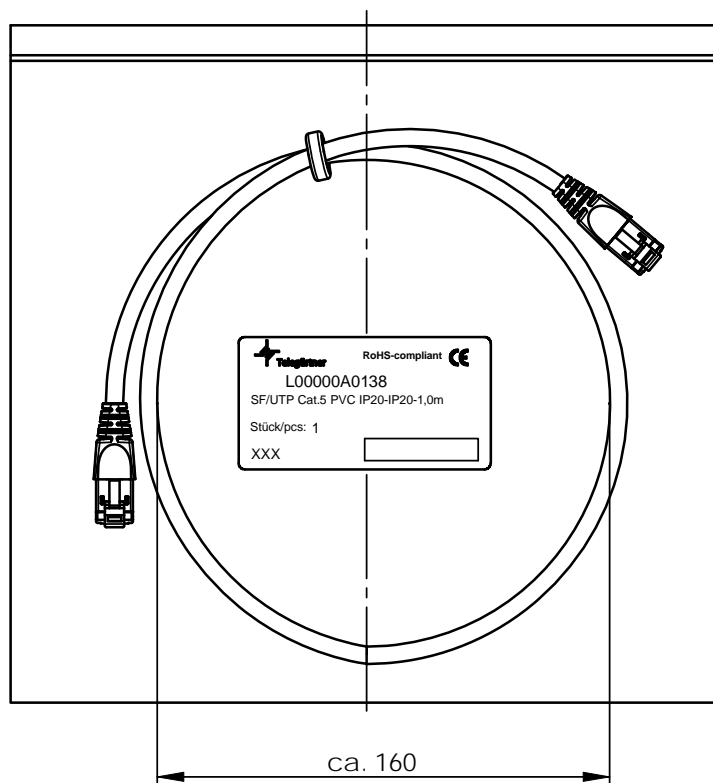

c b a	19282 19094 18387	16.10.07 22.08.07 11.12.06	BM BM BM	2006	Datum/ date	Name/ name	Gewicht/ weight [g]	Oberfläche/ surface [mm ²]	Werkstoff/ material										
				gez./ drawn	08.08.	BM													
				gepr./ appr.	11.08.06	SK			Oberfläche/ finish										
				Norm/ stand.															
Maßstab/ scale 1:1				Benennung/ title Modular Patch Cable SF/UTP Cat.5 PVC RJ45/IP20-RJ45/IP20															
untol. Maße/ dim. without tolerances according to				Unterl./doc. type K	Zeichnungsnr./ drawing no. L00000A0138				Telegärtner										
Ersatz für/ replaces								Maße/ dimensions: mm											
And./ rev. index				Anderungsmittellung/ revision code				Datum/ date				Name/ name				Original : DIN A4			
												Blatt/ sheet 2 von/ of 2							