

Tous droits strictement réservés. Toute réimpression ou communication sans autorisation écrite du propriétaire. Property of FCI. All rights reserved. No reproduction or communication without written permission of FCI.

FCI

All rights strictly reserved. Reproduction or issue to third parties in any form without written authority from the proprietor. Property of FCI. Copyright FCI.

REFERENCE SPECIFICATIONS

- DIN 41652
- MIL-DTL-24308

PHYSICAL CHARACTERISTICS

- INSULATOR MATERIAL :
- PBT COLOR BLACK-RAL 7001/STANDARD MATERIAL
- CONTACT MATERIAL : - PHOSPHOR BRONZE FOR STRAIGHT CONTACT AND RA SOCKET
- BRASS FOR RA PIN
- GROUNDING DEVICE MATERIAL : - BRASS FOR RIGHT ANGLE CONTACT

ELECTRICAL CHARACTERISTICS

- MAXIMUM RATING CURRENT: 5A AT 70°C
- NOMINAL CURRENT: 5A (STANDARD CONDITIONS)
- CONTACT RESISTANCE : straight terminations: <10mΩ
Right angled termination: <25mΩ
: <35mΩ for 50 way
- VOLTAGE PROOF : >1000 V.r.m.s.
- RATED VOLTAGE : 300 V.r.m.s.
- insulation resistance: >5000mΩ
- creepage and clearance distance: >1mm
- average wiping length: 2mm

MECHANICAL CHARACTERISTICS

- RETENTION AGAINST TORQUE: - Threaded insert: 0.7 N.m minimum
- Female screw lock: 0.5 N.m minimum
- INSERTION AND WITH DRAWAL FORCE: <n x 3.40 N (n number of cts)
- GAUGE RETENTION FORCE : >0.20 N (gauge PM)
- THICKNESS GAUGE = Ø0.99±0.005 / SURFACE ROUGHNESS:
• Ra=0.10µ mini- 0.25µ maxi
- CONTACT RETENTION IN INSULATOR : mini 16N for straight contact
mini 20N for right angled contact
- VIBRATIONS: 10-2000Hz / 1.5 mm - 20g / 3 x 2 HRS
- INTERRUPTION <1µs (NOT APPLICABLE FOR PL3)
- SHOCK: ACC. HALF SINE 50g- 11m.s-6x3 SHOCKS
- INTERRUPTION <1µs
- HARPOON INSERTION FORCE: <60N

PERFORMANCE LEVELS

MECHANICAL ENDURANCE ONLY		
P/N: DXXXXXCXXXXXX		PERFORMANCE LEVELS
4	200 OPERATIONS	PL3
6	400 OPERATIONS	PL1

MECHANICAL ENDURANCE AND INDUSTRIAL ATMOSPHERE TEST (1)		
P/N: DXXXXXCXXXXXX		PERFORMANCE LEVELS
4	salt spray: 24 hours	PL3
6	250 op + test (1 or 2)-10 days + 250 op	PL1

1) INDUSTRIAL ATMOSPHERE TEST: 3 GASES available for contacts and grounding device

IN ACCORDANCE WITH IEC-68-2-60-TTD - TEST ke - MTH C OR IEC 512-6 TEST IIg

MIXED GASES: H2S=10 PPB±5.10-9vol/vol +N2O=200±50.10-9 vol/vol + CL2=10±5.10-9vol/vol

TEMPERATURE = 30±1°C / RELATIVE HUMIDITY= 70±3°C

(2) INDUSTRIAL ATMOSPHERE TEST: 4 GASES available for contacts active area only

BELCORE TEST : MIXED GASES: H2S=10 PPB±5 vol/vol +N2O=200ppb±50 vol/vol + CL2=10ppb±3vol/vol + S2O=100ppb±30vol/vol
TEMPERATURE = 30±1°C / RELATIVE HUMIDITY= 70±2°C

ENVIRONMENTAL CHARACTERISTICS

- CLIMATIC CATEGORY: 55/125/56
- TEMPERATURE RANGE -55°C TO +125°C
- DAMP HEAT STEADY STATE 56 DAYS

RIGHT ANGLED

STRAIGHT

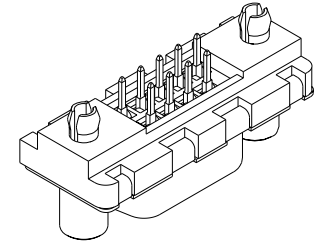
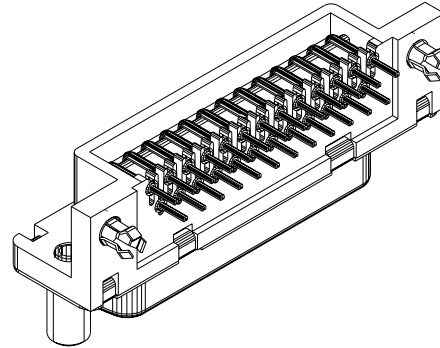

PLATING TIN LEAD VERSION

- CONTACT:
 - GOLD OVER NICKEL ON MATING SURFACES
 - TIN LEAD OVER NICKEL ON TERMINATION PARTS
- SHELL AND ACCESSORIES TIN LEAD OVER COPPER

PLATING TIN VERSION

NOTE RoHS INFORMATION

- The "LF" products meet European union Directives and other country regulations as described in GS-22-008
- The housing will withstand exposure to 260°C peak temperature for 3.5 seconds in a wave solder application with a 1.6 mm minimum thickcircuit board. See application notes/procedures if they are available.
- Termination plating spec: 1.27µm Nickel mini, 2.5 to 7.5 µm Sn (pure matte)
- Shell plating: 2 to 4 µm Cu + 3 to 10 µm Sn (pure bright)
- Accessories: Sn pure bright
- Packaging spec: see GS-14-920

FCI www.fciconnect.com		surface <input checked="" type="checkbox"/>	tolerance	projection	
Dr JOUBERT	30/11/00	Product family		size A3	Scale 1:1
Eng		Spec ref		ECN LS05-0039	
Chr		Material	SEE NOTES		
Appr LEGARE	30/11/00				
DELTA D SOLDER CTS CONNECTORS			dwg no C01-8646-0000	Rev. C	
GENERAL CHARACTERISTICS					
catalog no	CUSTOMER COPY		sheet 1 of 1		

l	tr	ecn no	dr	date
B	-	SJO	07/08/02	
E	ES05-0039	EMA	26/01/05	
-	-	-	-	
-	-	-	-	
-	-	-	-	
-	-	-	-	
-	-	-	-	

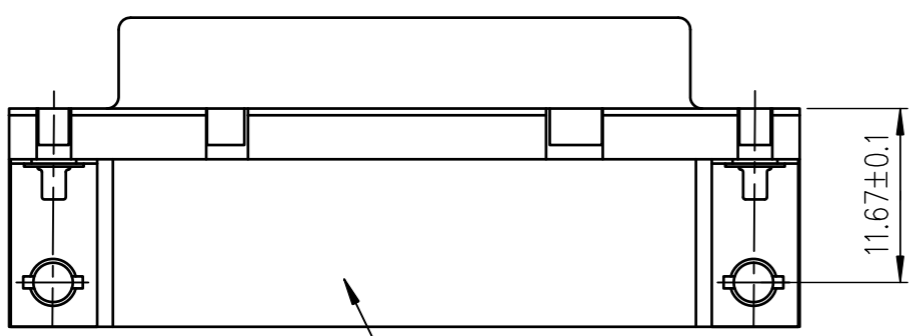
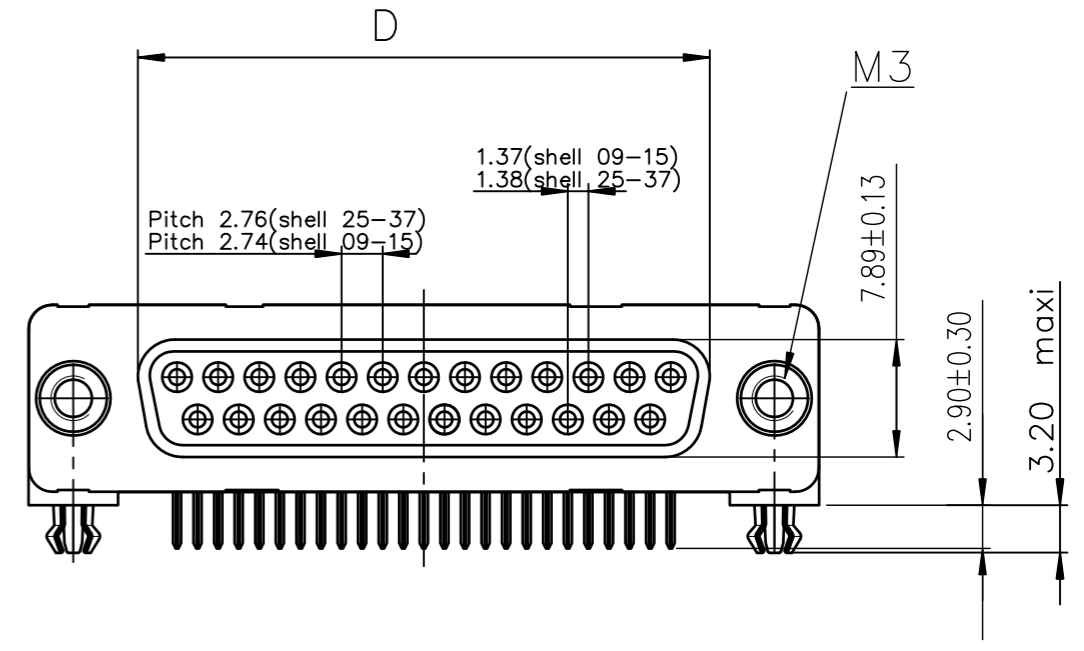
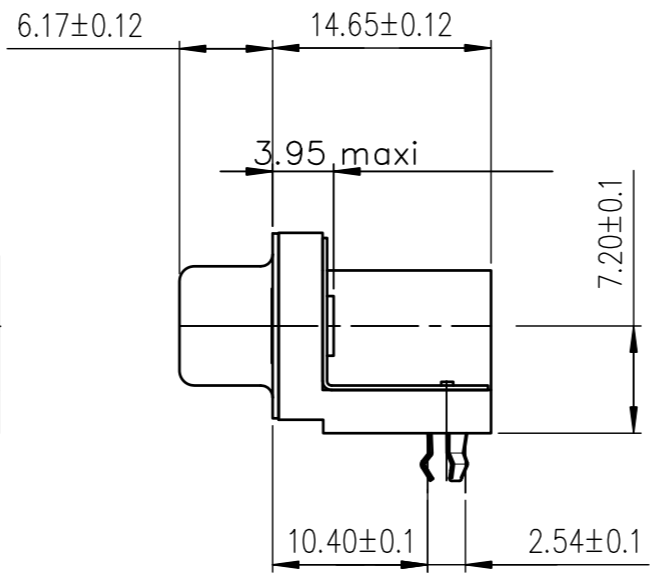
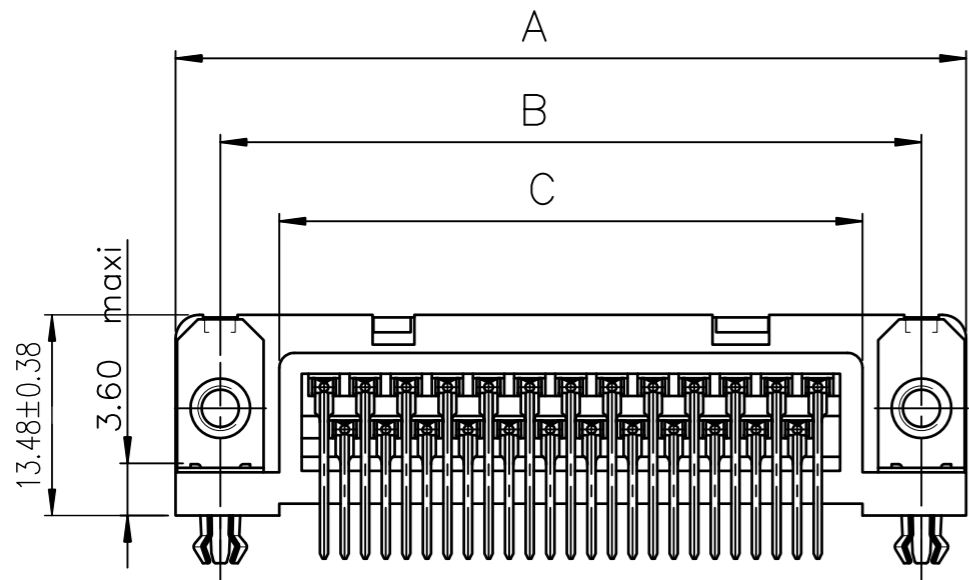

Part Number & Date Code Printing
 PC card drilling dimensions(after plating)
 (thickness 1.60±0.20mm)

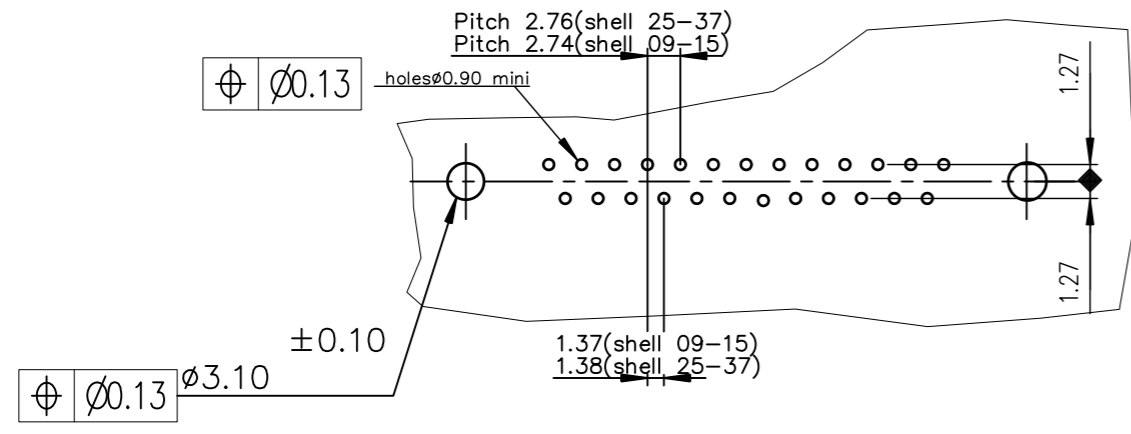

Pull Parts						
SHELL	A±0.38	B±0.12	C±0.10	D±0.25	PART NUMBER	LEAD FREE P/N
09	30.81	24.99	16.96	16.21	D09S13A*GL00	D09S13A*GL00LF
15	39.14	33.32	25.18	24.54	D15S13A*GL00	D15S13A*GL00LF
25	53.03	47.04	39.12	38.25	D25S13A*GL00	D25S13A*GL00LF
37	69.32	63.50	55.68	54.71	D37S13A*GL00	D37S13A*GL00LF

4-200 MATING CYCLES
 6-500 MATING CYCLES

GENERAL CHARACTERISTICS : SEE DRAWING C01-8646-0000

mat'l. code SEE.NOTES				surface ISO 1302 ✓		tolerance ISO 406 ISO 1101		projection MM		product family D-SUB		
ltr ecn no dr date				tolerances unless otherwise specified		angles linear		scale 1:1		title SOCKET CONNECT.DELTA D RIGHT ANGLE WITH NUT,HARPON and metal plate.		
G	105-0124	JS	2005/07/27	0.X ±0.1		0.XX ±0.1		FCJ		dwg no sheet 1 of 1 size		
H	106-0074	SK	2006/06/08	0.XXX±0.1						C01-8646-0165 A3		
J	ELXI-I-15060	AB	2013/06/25	0.XX±2°						type CUSTOMER Drawing		
K	ELX-I-18948	AB	2014/09/29	dr	JOHN.SLEEBA	1994/10/14						
				enr	ALIAS.BABU	2014/09/29						
				chr	MITHUN.PAUL	2014/09/29						
				appd	BIJU.K.PAUL	2014/09/29						
sheet index	revision	K										
	sheet	1										