

# Sensor/actuator box - SACB- 6/3-L-C-M8 - 1503425

Please be informed that the data shown in this PDF Document is generated from our Online Catalog. Please find the complete data in the user's documentation. Our General Terms of Use for Downloads are valid (<http://download.phoenixcontact.com>)



Sensor/actuator box, Application: Standard, Connection method: M8 socket Metal, Number of slots: 6, Number of positions: 3, Coding: A - standard, Slot assignment: single, Status indication: Yes, pnp; Master cable connection: Pluggable screw connection 180°, Shielding: No

## Your advantages

- Safety in the field, thanks to molded housing and high degree of protection
- Flexible, distributed bundling of signals in one master cable
- Convenient: increased machine availability thanks to quick and easy diagnostics
- Flexible: distributor box with connector hood for on-site assembly

## Key commercial data

<b>package_quantity</b>	1
<b>GTIN</b>	4017918976415

## Technical data

### General

<b>Rated voltage</b>	24 V DC
<b>Max. operating voltage <math>U_{max}</math></b>	30 V DC
<b>Current carrying capacity per I/O signal</b>	2 A
<b>Current carrying capacity per slot</b>	2 A
<b>Total rated current</b>	8 A
<b>Number of positions</b>	3
<b>Number of slots</b>	6
<b>Flammability rating according to UL 94</b>	V0
<b>Sensor/actuator connection system</b>	M8 socket

### Ambient conditions

<b>Degree of protection</b>	IP65
<b>Degree of protection</b>	IP67
<b>Ambient temperature (operation)</b>	-30 °C ... 80 °C

### Local diagnostics function

<b>Local diagnostics</b>	Supply voltage Green LED
<b>Local diagnostics</b>	Status display I/O Yellow LED

### Master cable data/connection data

<b>Connection method</b>	Pluggable screw connection
--------------------------	----------------------------

## Sensor/actuator box - SACB- 6/3-L-C-M8 - 1503425

### Technical data

#### Master cable data/connection data

Conductor cross section min. (signal)	0.14 mm <sup>2</sup>
Conductor cross section max. (signal)	1.5 mm <sup>2</sup>
Conductor cross section AWG min. (signal)	26
Conductor cross section AWG max. (signal)	16
Stripping length (signal)	7 mm
Conductor cross section min. (energy)	0.14 mm <sup>2</sup>
Conductor cross section max. (energy)	1.5 mm <sup>2</sup>
Conductor cross section AWG min. (energy)	26
Conductor cross section AWG max. (energy)	16
External cable diameter min.	7 mm
External cable diameter max.	12 mm
Stripping length	60 mm (Master cable)
Tightening torque, cover screw	1 Nm
Tightening torque, union nut	2.5 Nm
Tightening torque slot sensor/actuator cable	0.2 Nm

#### Insulation material

Housing material	PBT
Material of the moulding mass	PUR
Contact material	CuSn
Contact surface material	Ni/Au
Contact carrier material	PA
Material of contact, master cable side	CU alloy
Material of contact surface, master cable side	Gold-plated
Material of the contact carrier on the master cable side	PA 66 V0
Material of threaded sleeve	Cu alloy
Material of threaded sleeve surface	Nickel-plated
O-ring material	NBR

#### Pin assignment

Slot/position = Wire color or connection	1 / 4 (A) = 1 / 4
Slot/position = Wire color or connection	2 / 4 (A) = 2 / 4
Slot/position = Wire color or connection	3 / 4 (A) = 3 / 4
Slot/position = Wire color or connection	4 / 4 (A) = 4 / 4
Slot/position = Wire color or connection	5 / 4 (A) = 5 / 4
Slot/position = Wire color or connection	6 / 4 (A) = 6 / 4
Slot/position = Wire color or connection	1-6 / 1 (+ 24 V) = U <sub>N</sub>
Slot/position = Wire color or connection	1-6 / 3 (0 V) = 0 V

#### Standards and Regulations

Standard designation	M8 connector
Standards/regulations	IEC 61076-2-104
Connection in acc. with standard	CUL

# Sensor/actuator box - SACB- 6/3-L-C-M8 - 1503425

## Technical data

### Standards and Regulations

Flammability rating according to UL 94	V0
--	----

## Classifications

### eCl@ss

eCl@ss 4.0	27140815
eCl@ss 4.1	27140815
eCl@ss 5.0	27143423
eCl@ss 5.1	27143423
eCl@ss 6.0	27143423
eCl@ss 7.0	27449001
eCl@ss 8.0	27279219
eCl@ss 9.0	27440108

### ETIM

ETIM 2.0	EC000200
ETIM 3.0	EC001856
ETIM 4.0	EC002585
ETIM 5.0	EC002585

### UNSPSC

UNSPSC 6.01	31261501
UNSPSC 7.0901	31261501
UNSPSC 11	31261501
UNSPSC 12.01	31261501
UNSPSC 13.2	31261501

## Approvals

UL Recognized / cUL Recognized / EAC / cULus Recognized /

### Approval details

UL Recognized s 	
Nominal voltage UN	24 V
Nominal current IN	
mm <sup>2</sup> /AWG/kcmil	

# Sensor/actuator box - SACB- 6/3-L-C-M8 - 1503425

## Approvals

<b>cUL Recognized</b>	
Nominal voltage UN	24 V
Nominal current IN	
mm <sup>2</sup> /AWG/kcmil	

<b>EAC</b>
------------

<b>cULus Recognized</b>
-------------------------

## Accessories

### Connector hood without master cable

SACB-C-H180- 6/3-M8 - 1521216



---

### Cable by the meter

SACB- 6X0,34/2X0,75-50 PUR - 1517589



---

### Terminal marking

ZBF10:UNBEDRUCKT - 0809997



## Sensor/actuator box - SACB- 6/3-L-C-M8 - 1503425

### Accessories

#### Labeled terminal marker

ZBF10 CUS - 0825031



---

#### Protective cap

PROT-M8 - 1682540



---

#### Torque tool

TSD 02 SAC - 1208487



TSD-M 1,2NM - 1212224



TSD 25 SAC - 1212315



## Sensor/actuator box - SACB- 6/3-L-C-M8 - 1503425

### Accessories

TSD-M 3NM - 1212225



---

### Screwdriver tools

SAC BIT M8-D10 - 1208461



SACC BIT M8-D12 - 1208474



SZK PZ2 VDE - 1206463



SAC BIT HOOD-W 24 - 1212486



# Sensor/actuator box - SACB- 6/3-L-C-M8 - 1503425

## Accessories

TSD-M SAC-BIT ADAPTER - 1212600



SF-BIT-PZ 2-50 - 1212592



## Drawings

### Dimensional drawing

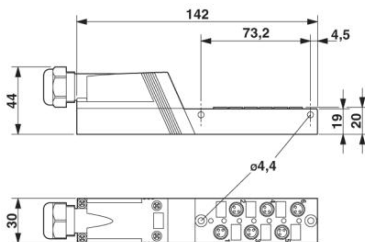

### Circuit diagram

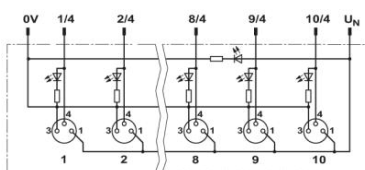

## Sensor/actuator box - SACB- 6/3-L-C-M8 - 1503425

Schematic diagram

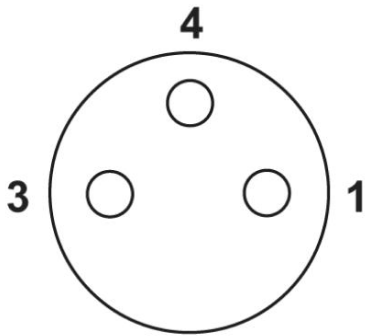

M8 slot, socket, 3-pos.

Schematic diagram

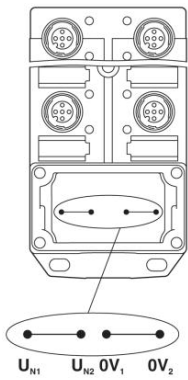

Potential UN1 and UN2 bridged

Schematic diagram

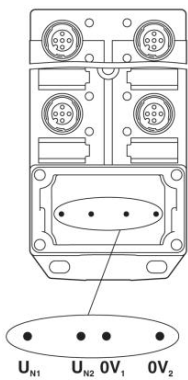

Electrically isolated

Phoenix Contact 2016 © - all rights reserved  
<http://www.phoenixcontact.com>