

# FURM35000A



Security Tech Germany

## Smartvest Wireless Smoke/Heat Detector



User Manual **GB**

**CE**<sub>16</sub>

0359

0359-CPR-00493

EN 14604:2005/AC:2008

Version 1.3

FURM35000A#1115

# Contents

---

<b>Introduction.....</b>	<b>4</b>
<b>Safety information .....</b>	<b>6</b>
<b>Scope of delivery .....</b>	<b>9</b>
<b>Technical data.....</b>	<b>9</b>
<b>Functional principle and features .....</b>	<b>10</b>
<b>Behaviour in case of alarm .....</b>	<b>11</b>
<b>Selecting location .....</b>	<b>11</b>
<b>Installation and start-up .....</b>	<b>13</b>
<b>Displays and functions.....</b>	<b>15</b>
<b>Care and maintenance.....</b>	<b>24</b>
<b>Warranty.....</b>	<b>27</b>
<b>Disposal .....</b>	<b>28</b>
<b>Declaration of conformity.....</b>	<b>29</b>

## Contents

---

Declaration of performance.....	29
---------------------------------	----

# Introduction

---

## Introduction

### Information on user manual

Dear Customer,

Thank you for choosing our product and putting your trust in us. You've made a good choice.

This smoke alarm device (hereinafter referred to as “detector” or “device”) has been developed with great care and manufactured to assist you in swiftly detecting the danger of a fire. Please read this user manual in its entirety and follow all instructions to ensure optimal handling of the device.

This booklet is the installation and maintenance guide.

### Intended use

Only use the device for the purpose for which it was built and designed. Any other use is considered unintended!

This device may only be used for the following purpose:

- Fire and smoke detection in private households

This smoke alarm device features a heat warning function. It is not, however, a heat detector as specified by EN 54 or other standards required by law for fire detection systems.

# Introduction

---

## Limitation of liability

Your rights are limited to the repair or replacement of this product in its as-delivered condition. ABUS Security-Center does not assume liability for any special, incidental or consequential damages, including but not limited to accrued loss of profit or earnings, loss or recovery of data, costs for replacement equipment, downtimes, property damages or claims of third parties resulting from, among others, contractual, legal or tort recovery claims created by the warranty, irrespective of other limited warranty stipulations or those implied by law or in the event that the limited warranty is invalid, the extent of liability of ABUS Security-Center is limited to the purchase price of this product.

We reserve the right to make changes to this manual without prior notice.





© ABUS Security-Center GmbH & Co. KG, 03/2016

# Safety information

## Safety information

### Explanation of symbols

The following symbols are used in this manual and on the device:

Symbol	Signal word	Meaning
	<b>Caution</b>	Indicates a risk of injury or health hazards.
	<b>Caution</b>	Indicates a risk of injury or health hazards caused by electrical voltage.
	<b>Important</b>	Indicates possible damage to the device/accessories.
	<b>Note</b>	Indicates important information.

# Safety information

## Information on the battery

The device is powered by two 1.5 V AA replaceable batteries.



- High direct heat may damage the batteries. For this reason, you should not place the device on heat sources (such as radiators) or in direct sunlight.
- The batteries cannot be recharged.
- Batteries should only be removed in order to be changed, otherwise the device cannot warn you of a serious incident.
- To ensure a long lifespan and safe operation, we recommend using the following high-quality batteries: “Gold Peak Group GP15A” or “Energizer E91”.
- After replacing the batteries, you must always check that the device is functioning correctly.

# Safety information

---

## Packaging



- Keep packaging material and small parts away from children. There is a risk of suffocation.
- Remove all packaging material before using the device.

## Functioning of the device

To ensure that the device functions correctly, please note the following points:



- Do not cover the device.
- Do not paint over the device or cover it with wallpaper.
- Do not, on any account, open or repair the device. Failure to observe this instruction will invalidate the warranty.
- Do not use the device if it has been dropped or damaged in any other way.



# Functional principle and features

## Scope of delivery

- ABUS smoke alarm device including batteries
- User manual
- Installation material

## Technical data

• Power supply	2 x 1.5 V alkaline batteries (replaceable)
• Smoke detection	Photoelectric reflection
• Heat detection	54°C–70°C
• Power consumption	<4 µA (standby)    <40 mA (alarm)
• Operating temperature	0 to 40°C
• Humidity	10% to 93% (non-condensing)
• Sound pressure	> 85 dB (A)@3 m
• Alarm muting	< 10 minutes
• Detection range	Max. 40 m <sup>2</sup> within a room
• Installation location	Ceiling (only in interior spaces)
• Radio frequency	868.3 MHz

## Scope of delivery | Technical data

### Functional principle and features

- The smoke alarm device does not detect gas, steam, fire or flames.
- People with impaired hearing may not be able to hear the alarm. Alarms with additional optical signalling are available for such cases.
- Particularly high electromagnetic radiation could impair the function of the detector. For this reason, do not install the detector near magnets or devices which produce electromagnetic radiation.
- The smoke alarm device operates in accordance with the optical principle (photoelectric reflection) and features a measurement chamber in which infiltrating smoke particles are measured.
- If the alarm threshold is exceeded, a loud acoustic alarm sounds. The smoke alarm device also has a heat detector that triggers an alarm if a threshold value is exceeded.
- The alarm is switched off as soon as the measurement chamber is free of smoke again and/or the temperature has fallen back to a normal level.

# Behaviour in case of alarm | Selecting location

## Behaviour in case of alarm



- (1) Alert all occupants.
- (2) Help children as well as disabled, elderly and sick people.
- (3) Close all windows and doors behind you.
- (4) Leave the house immediately.
- (5) Do not use lifts.
- (6) Alert the fire service: Tel. 112.

## Selecting location

Abb. 2

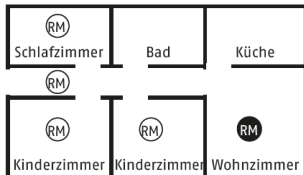
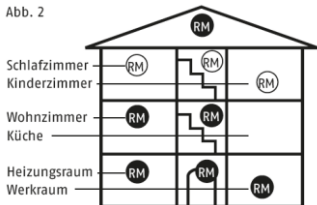

## Selecting location

---

Smoke alarm devices are to be used as the bare minimum (RM) equipment in all bedrooms, children's rooms and hallways which act as escape routes, and are to be installed in each case in the middle of the room, on the ceiling only (do not install on a wall) (Fig. 2). Select the highest installation location with a minimum distance of 50 cm to surrounding walls, furniture and lamps. Configuration is optimal (RM) when devices are located in all other rooms as well as staircases. In washrooms (bathrooms, lavatories etc.), a smoke alarm device is generally not necessary because the risk of fire is low.

Please note the graphics in this manual and the detailed information available in the EN14676 standard "Smoke alarm devices for use in residential buildings, apartments and rooms with similar purposes – Installation, use and maintenance".

### **Where smoke alarm devices should not be installed**



- Outside (use only in closed rooms)
- In rooms in which the alarm could be triggered by disturbance variables (steam, condensation, "normal" smoke, vapour, dust, dirt or grease)
- Next to an air duct or similar ventilation opening (draughts)
- In areas in which the temperature can fall below 0°C or rise to over 40°C
- On unstable surfaces with designs that render them unsuitable for installation with screw anchors

# Installation and start-up

## Installation and start-up

Take the following steps in the specified order to install the detector on the ceiling:

1. Loosen the smoke alarm device from the housing base by turning it anticlockwise.
2. Insert the batteries, ensuring that the polarity is correct.
3. Mark drill holes through the housing base.
4. Drill the necessary holes and attach the screw anchors, then screw on the detector base.

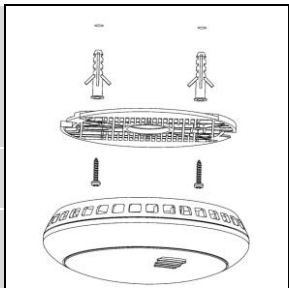

When marking out the drill holes, make sure there are no electrical wires or cables, pipes or other important components behind the mounting location.

## Installation and start-up

5. Mount the smoke alarm device on the detector base by turning it clockwise.

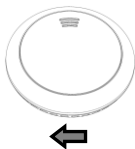

Failure to follow the instructions for the selection of a location and installation may result in risk of injury, e.g. from smoke alarm devices falling down.

# Displays and functions

---

## Displays and functions

### Normal state

In the normal state, the red control LED under the housing cover flashes once every 40 seconds and signals that the detector is ready for operation.

## Displays and functions

### Testing the device electronics

Regularly check the functionality of the smoke alarm device by pressing the Test button. The warning tone signals and the red "ALARM" LED flashes.

This does not indicate that smoke is present in the air in the room; it is a confirmation that the smoke alarm device is functioning properly.

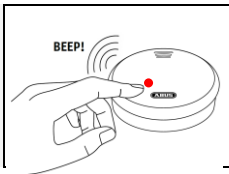

Test the functionality of the detector after installation without fail. A regular test is also recommended.



Keep the device at arm's length to protect your hearing.



To carry out a test, hold the Test button down for just 3-5 seconds.

Holding the Test button down for 15 seconds will reset the smoke detector to the factory default settings. This will cause it to lose its connection with Smartvest and other smoke alarm devices.

### Weak batteries



## Displays and functions

---

If the detector's battery charge falls below a certain value, the detector signals this with an acoustic warning tone (every 40 seconds). If this warning signal sounds, the detector batteries must be immediately replaced with new batteries. Pressing the Test button mutes the fault signal for 8 hours.



From the time of the first battery warning signal, the detector is still operable and completely functional for at least 30 more days.

### Self-test with automatic error message

The smoke alarm device periodically runs a self-test.

If the trigger sensitivity of the detector falls below the required minimum threshold (e.g. as a result of excess contamination of the smoke measurement chamber), the detector beeps once every 40 seconds. Pressing the Test button mutes the fault signal for 8 hours.



If the error message does not clear after the detector has been cleaned, the detector must be replaced immediately (see "Care and maintenance" chapter).

# Displays and functions

---

## Alarm state: Smoke

If smoke is detected, a loud, pulsing alarm tone sounds and the red LED flashes at the same time at short intervals. In this case, proceed as described in the “Behaviour in case of alarm” chapter.

Alarm tone 0.5 s – pause 0.5 s – alarm tone 0.5 s – pause 0.5 s – alarm tone 0.5 s – pause 1.5 s

## Alarm state: Heat

If heat is detected, a loud, pulsing alarm tone sounds and the red LED flashes at the same time at short intervals. In this case, proceed as described in the “Behaviour in case of alarm” chapter.

Alarm tone 0.2 s – pause 0.1 s

## Alarm state triggered by remote notification

If another detector informs the detector of an alarm, a loud, pulsing alarm tone sounds and the red LED flashes at the same time at short intervals.

Alarm tone – alarm tone – pause 1.2 s

## Displays and functions

---

At the same time, the detector receiving notification of the alarm checks to see how long the other detector has been sending the remote notification.

The pulsing alarm tone will stop sounding 60 seconds after the detector which triggered the alarm is muted.

To reduce this time, the pulsing alarm tone can be stopped after just 30 seconds by pressing the Test button (for 1 second).

### Test alarm triggered by remote notification

Carry out the test as described in the “Testing the device electronics” chapter.

If additional wireless smoke/heat detectors are connected to Smartvest, they will be notified of the test at this point and confirm the test for 60 seconds.

A loud, pulsing alarm tone sounds and the red LED flashes at the same time at short intervals.

You can mute the detectors receiving the notification at an earlier point by pressing the Test button (for 1 second) 30 seconds after starting the test.

## Displays and functions

### Alarm muting function (hush mode)

If the detector is in the alarm state, the acoustic alarm can be deactivated for 8 minutes by pressing the Test button.

If the muting function is active, the red LED flashes every 8 seconds.

If smoke is still detected in the smoke measurement chamber after the 8-minute muting period, the acoustic alarm will sound again.

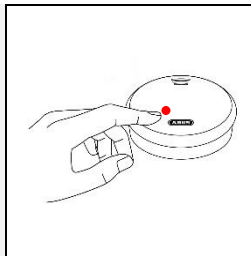

## Displays and functions

### Connecting the detector to the Smartvest alarm panel



The wireless Smartvest smoke/heat detector can be connected to a Smartvest alarm panel. To do this, follow the instructions in the Smartvest app. The teach-in process must first be initiated in the app. The batteries are then inserted in the detector and the connection is established between the detector and the alarm panel.

Once the detector has been connected to the Smartvest alarm panel, the detector will notify all other wireless Smartvest smoke/heat detectors within range that are connected to the same Smartvest alarm panel, and the alarm panel itself, in the event of an alarm. The alarm panel will then react in accordance with the alarm settings and will activate sirens or send notifications, for example.

## Displays and functions

### Connecting the detector to identical detectors



The wireless Smartvest smoke/heat detector can also be connected to other wireless Smartvest smoke/heat detectors without a Smartvest alarm panel. To do this, follow these steps:

1. Define one detector as the central detector.
2. Insert the batteries into the central detector and wait 3 seconds.
3. Press and hold the Test button on the central detector for more than 10 seconds until the LED starts flashing quickly. Now release the Test button.
4. Insert the batteries into the detector that is to be connected to the central detector and wait a few seconds – the connection will be established automatically.
5. Test whether the detectors have been successfully connected to one another: To do so, press the Test button on one of the detectors and hold it until it triggers an alarm tone at least three times. The connected detectors now signal the remote notification alarm state.

## Displays and functions

---

6. Press the Test button for 15 seconds to reset the smoke detector to the factory default settings and to end the connection to the other smoke alarm devices.

# Care and maintenance

---

## Care and maintenance

### What should you do in the event of a false alarm?

Possible reasons for a false alarm are: Welding and cutting work, soldering and other high-temperature work, sawing and grinding, dust from construction work or cleaning, extreme electromagnetic effects, and temperature fluctuations which lead to condensation of the humidity in the detector.



- If work which could cause false alarms is being carried out near the detector, the detector should be covered or removed temporarily. After this work is completed, however, it is essential to restore and test the original functionality.

## Cleaning

According to German application standard DIN 14676, the functionality of every installed smoke alarm device must be regularly tested and ensured with maintenance and repair work.

This consists of an inspection at least once every  $12 \pm 3$  months including maintenance and function checks of the warning signals.

The measures and results must be documented accordingly.



## Care and maintenance

---



- Dusty detectors must be cleaned. You can clean dust from the air vents of the detector using a vacuum cleaner or compressed air.
- If necessary, you can remove the dust with a brush.
- You can clean the surface using a cloth slightly dampened in soapy water.
- Do not allow water to enter the inside of the device. Do not clean the device in a dishwasher.
- Do not use sharp, pointed, abrasive or corrosive cleaning materials, chemicals or hard brushes.

### Maintenance



- The electronic components of every smoke alarm device are subject to ageing processes. In addition, the insect protection grid and smoke measurement chamber will inevitably become soiled over time.
- In order to guarantee the full functionality of the smoke alarm devices, they must be exchanged 10 years after installation at the latest.

## Care and maintenance

---

### Changing the battery



- Turn the detector anticlockwise and remove it from the mount.
- Remove the old batteries.
- Insert two new batteries, ensuring that the polarity is correct.
- Test the smoke alarm device. To do so, press and hold the Test button for > 5 seconds; the detector repeats the pattern: 3 alarm tones, 1.5-second pause.
- Turn the detector clockwise onto the mount.

# Warranty

## Warranty



- ABUS products are designed and manufactured with the greatest care and tested according to the applicable regulations.
- The warranty only covers defects caused by material or manufacturing errors at the time of sale. If there are demonstrable material or manufacturing errors, the smoke alarm device will be repaired or replaced at the warrantor's discretion.
- In such cases, the warranty ends when the original warranty period of 2 years expires. All further claims are expressly rejected.
- The warranty does not cover the batteries supplied.
- ABUS will not be held liable for defects and damage caused by external influences (e.g. transport, use of force, operating errors), inappropriate use, normal wear and tear or failure to observe the instructions in this manual.



- In the event of a warranty claim, the original receipt with the date of purchase and a short written description of the

## Warranty | Disposal

---

problem must be supplied along with the smoke alarm device in question.

- If you discover a defect on your smoke alarm device which existed at the time of purchase, contact your dealer directly within the first two years.

## Disposal



Dispose of the device in accordance with EC Directive 2002/96/EC – WEEE (Waste Electrical and Electronic Equipment). If you have any questions, please contact the municipal authority responsible for disposal. You can get information on collection points for waste equipment from your local authority, from local waste disposal companies or your dealer, for example.

# Declaration of conformity | Declaration of performance

---

## Declaration of conformity

ABUS Security-Center GmbH & Co. KG, Linker Kreuthweg 5, 86444 Affing, Germany, hereby declares that the FURM35000A device is in compliance with the essential requirements and the relevant provisions of in the following directives:

93/68/EEC The CE Marking Directive

1999/5/EC R&TTE Directive

2011/65/EU Restriction of Hazardous Substances (RoHS) Directive

2012/19/EU Waste from Electrical and Electronic Equipment (WEEE) Directive

The declaration of conformity can be obtained from the following address:

ABUS Security-Center GmbH & Co. KG, Linker Kreuthweg 5, 86444 Affing, GERMANY

## Declaration of performance

This smoke alarm device is tested and certified as a building product in accordance with regulation EU 305/2011. Production is monitored by regular and independent inspections for continued compliance with legal and standard specifications.

Declaration of performance **FURM35000A#1115** can be found here:  
[www.abus.com/ger/Service/Leistungserklaerungen](http://www.abus.com/ger/Service/Leistungserklaerungen)