

1 . Electrical Characteristics

Oscillation Frequency (KHz)	4.1 ± 0.5
Operating Voltage (Vdc)	3 ~ 15
Rated Voltage (Vdc)	12
Current Consumption (mA/max.)	10 at Rated Voltage
Sound Pressure Level (dB/min.)	83 at 10cm at Rated Voltage
Tone/Pulse Rate	Constant
Operating Temperature (°C)	-20 ~ +70
Storage Temperature (°C)	-30 ~ +80
Wave soldering conditions	245±5°C for 3±0.5 seconds.
Manual soldering conditions	350±20°C / within 5sec

2 . Voltage/ Current / Sound Pressure

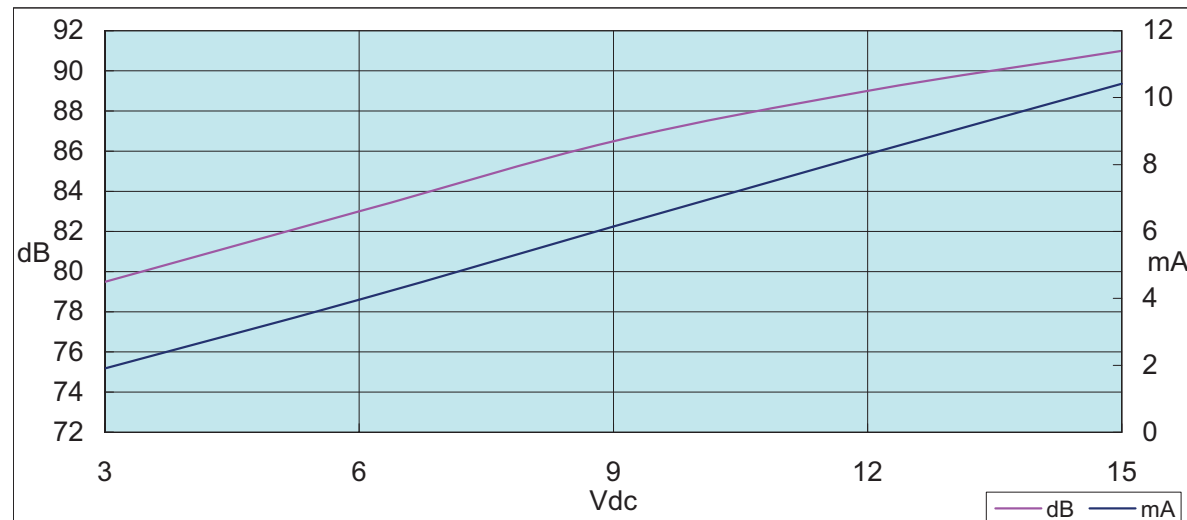

3 . Dimensions and Material

3-1 Shape

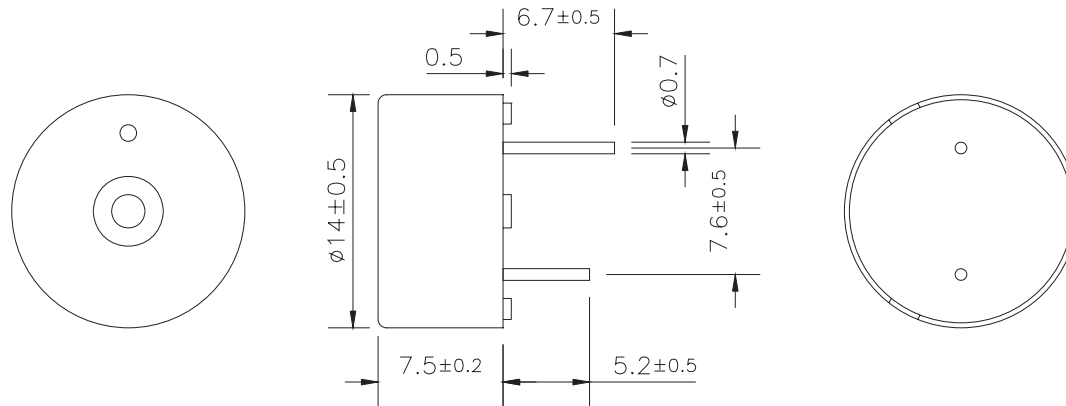

Unit : mm

]

3-2 Material

Housing	ABS 777D UL94HB plastic resin (Color : Black)
Leading Pin	Tin Plated Brass
Weight (Gram)	0.8

4. TESTING METHOD

- **Standard Measurement conditions**

Temperature: 25 ± 2 °C Humidity: 45-60%

- **Acoustic Characteristics**

The oscillation frequency, current consumption and sound pressure are measured by the measuring instruments shown below.

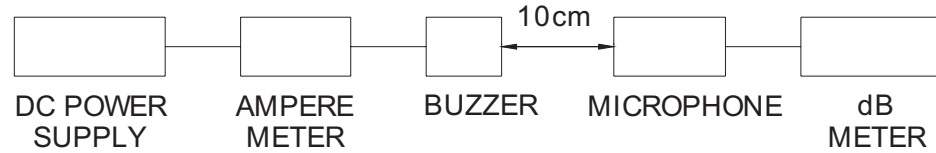

In the measuring test, buzzer is placed as follows:

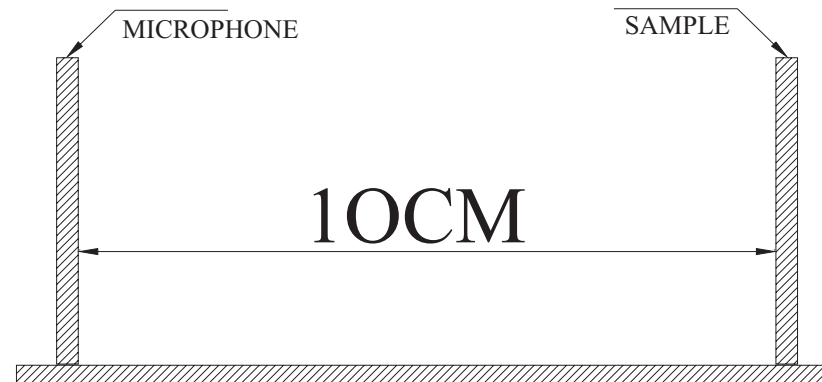

5. RELIABILITY

ITEMS	METHOD OF TEST AND MEASUREMENTS	PERFORMANCE
Coldness withstanding	After 98 hours of being exposed to -30 °C environment, should be returned to normal environment for 2 hours, then re-proceed to test.	No abnormality shall exist
Hotness withstanding	After 98 hours of being exposed to +80 °C environment, should be returned to normal environment for 2 hours, then re-proceed to test.	No abnormality shall exist
Humidity withstanding	After 98 hours of being exposed to 40 °C 95%RH environment in actual operation, should be returned to normal environment for 2 hours, then re-proceed to test.	No abnormality shall exist
Durability	Testing after 1,000 hours actual continuous operation.(at standard measurement conditions)	No abnormality shall exist
Drop withstanding	A natural drop from 75cm high down to the ground.	No abnormality shall exist
Vibration withstanding	Vibration of 2,000 cycles per minute, 2mm amplitude, applied in X, Y and Z directions for 30 minutes each.	No abnormality shall exist

6. PACKAGE METHOD

- <1> One inner box consists of 1200pcs.
- <2> 10 inner boxes are packed in a carton box. (L*W*H=510*330*300mm)
 (12000pcs of PK-12N40PAQ are packed in a carton box.)
- < 3 > RoHS Mark

