

Drawing No. : 1012454
 created: SBR 23/11/2016 18:01:00

Page 1 / 1

Typ : GMA10304035054

RoHS Compliant

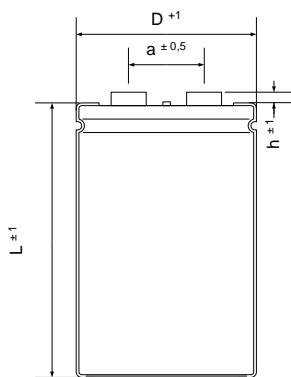

$\varnothing D$: 35 mm
 L : 54 mm
 a : 13 mm
 h : 6 mm

Terminals : M5

Max. torque:
 Terminals: M5: 2,0 Nm, M6: 2,5 Nm

Electrical Parameters

Rated Capacitance (C_R) @ 100 Hz / 20 °C	10000 μF	
Tolerance	-10/ +30 %	
Rated Voltage (U_R)	40 V	
Surge Voltage (U_S) max. 5 x 1 min / h	46 V	
Reverse Voltage (U_U) max. 1 s	2 V	
Leakage Current (I_L) @ U_R / 5 min / 20 °C	2400 μA	
ESR typ. @ 100 Hz / 20°C	45 m Ω	
Tan δ typ. @ 100 Hz / 20°C	28 %	
Z max. @ 10 kHz / 20°C	36 m Ω	
ESL typ.	20 nH	
Rated Ripple Current (I_R) @ 100 Hz / 85 °C	3,6 A	
Useful life @ I_R , U_R , 85 °C	8000 h	
IEC Climatic category / Standards	40/085/56	IEC 60384-4
Applications		