

Drawing No. : 1012804
 created: SBR 23/11/2016 18:26:00

Page 1 / 1

Typ : GMA47304050080

RoHS Compliant

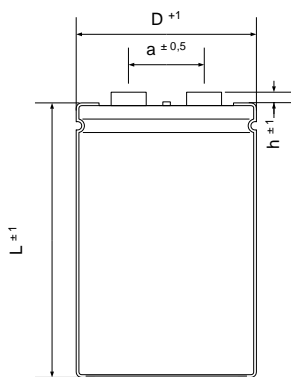

∅ D : 50 mm
 L : 80 mm
 a : 22 mm
 h : 5 mm

Terminals : M5

Max. torque:
 Terminals: M5: 2,0 Nm, M6: 2,5 Nm

Electrical Parameters

Rated Capacitance (C _R) @ 100 Hz / 20 °C	47000 μF	
Tolerance	-10/ +30 %	
Rated Voltage (U _R)	40 V	
Surge Voltage (U _S) max. 5 x 1 min / h	46 V	
Reverse Voltage (U _U) max. 1 s	2 V	
Leakage Current (I _L) @ U _R / 5 min / 20 °C	11280 μA	
ESR typ. @ 100 Hz / 20°C	15 mΩ	
Tan δ typ. @ 100 Hz / 20°C	44 %	
Z max. @ 10 kHz / 20°C	12 mΩ	
ESL typ.	20 nH	
Rated Ripple Current (I _R) @ 100 Hz / 85 °C	7,9 A	
Useful life @ I _R , U _R , 85 °C	8000 h	
IEC Climatic category / Standards	40/085/56	IEC 60384-4
Applications		