

Typ : GMA33306350100

RoHS Compliant

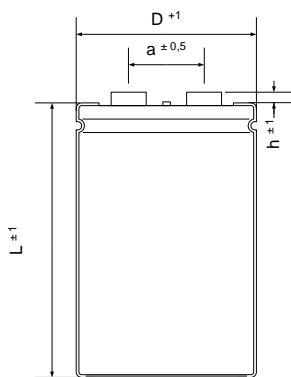

$\varnothing D$: 50 mm
 L : 100 mm
 a : 22 mm
 h : 5 mm

Terminals : M5

Max. torque:
 Terminals: M5: 2,0 Nm, M6: 2,5 Nm

Electrical Parameters

Rated Capacitance (C_R) @ 100 Hz / 20 °C	33000 μF	
Tolerance	-10/ +30 %	
Rated Voltage (U_R)	63 V	
Surge Voltage (U_S) max. 5 x 1 min / h	72 V	
Reverse Voltage (U_U) max. 1 s	2 V	
Leakage Current (I_L) @ U_R / 5 min / 20 °C	12474 μA	
ESR typ. @ 100 Hz / 20°C	18 m Ω	
Tan δ typ. @ 100 Hz / 20°C	37 %	
Z max. @ 10 kHz / 20°C	14 m Ω	
ESL typ.	20 nH	
Rated Ripple Current (I_R) @ 100 Hz / 85 °C	8,1 A	
Useful life @ I_R , U_R , 85 °C	8000 h	
IEC Climatic category / Standards	40/085/56	IEC 60384-4
Applications		