

Typ : GMB15240050100

RoHS Compliant

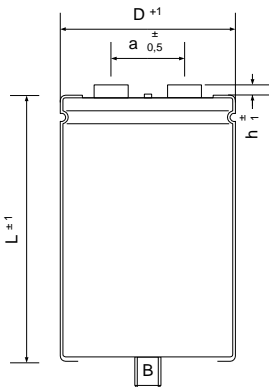

∅ D :	50 mm
L :	100 mm
a :	22 mm
h :	5 mm
B :	M 12 x 16
Terminals :	M 5

Max. torque:
 Terminals: M5: 2,0 Nm, M6: 2,5 Nm
 Stud: M8: 4,0 Nm, M12: 10,0 Nm

Electrical Parameters

Rated Capacitance (C_R) @ 100 Hz / 20 °C	1500 μ F	
Tolerance	-10 / +30 %	
Rated Voltage (U_R)	400 V	
Surge Voltage (U_S) max. 5 x 1 min / h	440 V	
Reverse Voltage (U_U) max. 1 s	2 V	
Leakage Current (I_L) @ U_R / 5 min / 20 °C	3600 μ A	
ESR typ. @ 100 Hz / 20°C	74 m Ω	
Tan δ typ. @ 100 Hz / 20°C	7 %	
Z max. @ 10 kHz / 20°C	59 m Ω	
ESL typ.	20 nH	
Rated Ripple Current (I_R) @ 100 Hz / 85 °C	3,8 A	
Useful life @ I_R , U_R , 85 °C	8000 h	
IEC Climatic category / Standards	40/085/56	IEC 60384-4
Applications		