

**Typ : GMB47216050100**

**RoHS Compliant**

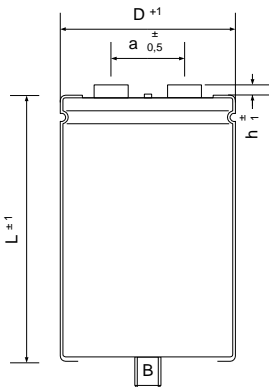

∅ D :	50 mm
L :	100 mm
a :	22 mm
h :	5 mm
B :	M12 x 16
Terminals :	M5

Max. torque:  
 Terminals: M5: 2,0 Nm, M6: 2,5 Nm  
 Stud: M8: 4,0 Nm, M12: 10,0 Nm

**Electrical Parameters**

Rated Capacitance ( $C_R$ ) @ 100 Hz / 20 °C	<b>4700</b> $\mu\text{F}$	
Tolerance	<b>-10/ +30</b> %	
Rated Voltage ( $U_R$ )	<b>160</b> V	
Surge Voltage ( $U_S$ ) max. 5 x 1 min / h	<b>184</b> V	
Reverse Voltage ( $U_U$ ) max. 1 s	<b>2</b> V	
Leakage Current ( $I_L$ ) @ $U_R$ / 5 min / 20 °C	<b>4512</b> $\mu\text{A}$	
ESR typ. @ 100 Hz / 20°C	<b>41</b> m $\Omega$	
Tan $\delta$ typ. @ 100 Hz / 20°C	<b>12</b> %	
Z max. @ 10 kHz / 20°C	<b>33</b> m $\Omega$	
ESL typ.	<b>20</b> nH	
Rated Ripple Current ( $I_R$ ) @ 100 Hz / 85 °C	<b>6,8</b> A	
Useful life @ $I_R$ , $U_R$ , 85 °C	<b>8000</b> h	
IEC Climatic category / Standards	<b>40/085/56</b>	<b>IEC 60384-4</b>
Applications		