

Drawing No. : 1013324  
 created: SBR 25/11/2016 10:15:00

Page 1 / 1

**Typ : GMB68210040070**

**RoHS Compliant**

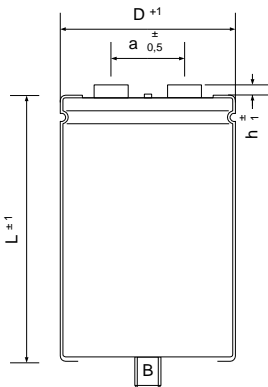

$\varnothing$  D : 40 mm  
 L : 70 mm  
 a : 18 mm  
 h : 5 mm  
 B : M12 x 16  
 Terminals : M5

Max. torque:  
 Terminals: M5: 2,0 Nm, M6: 2,5 Nm  
 Stud: M8: 4,0 Nm, M12: 10,0 Nm

**Electrical Parameters**

|  |                      |                    |
|--|----------------------|--------------------|
| Rated Capacitance ( $C_R$ )<br>@ 100 Hz / 20 °C      | <b>6800</b> $\mu$ F  |                    |
| Tolerance  | <b>-10/ +30</b> %    |                    |
| Rated Voltage ( $U_R$ )                              | <b>100</b> V         |                    |
| Surge Voltage ( $U_S$ )<br>max. 5 x 1 min / h        | <b>115</b> V         |                    |
| Reverse Voltage ( $U_U$ )<br>max. 1 s                | <b>2</b> V           |                    |
| Leakage Current ( $I_L$ )<br>@ $U_R$ / 5 min / 20 °C | <b>4080</b> $\mu$ A  |                    |
| ESR typ.<br>@ 100 Hz / 20°C                          | <b>23</b> m $\Omega$ |                    |
| Tan $\delta$ typ.<br>@ 100 Hz / 20°C                 | <b>10</b> %          |                    |
| Z max.<br>@ 10 kHz / 20°C                            | <b>19</b> m $\Omega$ |                    |
| ESL typ.   | <b>20</b> nH         |                    |
| Rated Ripple Current ( $I_R$ )<br>@ 100 Hz / 85 °C   | <b>6,7</b> A         |                    |
| Useful life<br>@ $I_R$ , $U_R$ , 85 °C               | <b>8000</b> h        |                    |
| IEC Climatic category / Standards                    | <b>40/085/56</b>     | <b>IEC 60384-4</b> |
| Applications   |                      |                    |