

Drawing No. : 1012291  
 created: SBR 23/11/2016 17:20:00

Page 1 / 1

**Typ : GHB22216050080**

**RoHS Compliant**

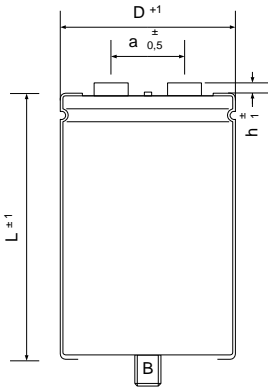

$\varnothing$  D : 50 mm  
 L : 80 mm  
 a : 22 mm  
 h : 5 mm  
 B : M12 x 16  
 Terminals : M5

Max. torque:  
 Terminals: M5: 2,0 Nm, M6: 2,5 Nm  
 Stud: M8: 4,0 Nm, M12: 10,0 Nm

**Electrical Parameters**

Rated Capacitance ( $C_R$ ) @ 100 Hz / 20 °C	<b>2200</b> $\mu$ F	
Tolerance	<b>-10/ +30</b> %	
Rated Voltage ( $U_R$ )	<b>160</b> V	
Surge Voltage ( $U_S$ ) max. 5 x 1 min / h	<b>184</b> V	
Reverse Voltage ( $U_U$ ) max. 1 s	<b>2</b> V	
Leakage Current ( $I_L$ ) @ $U_R$ / 5 min / 20 °C	<b>2112</b> $\mu$ A	
ESR typ. @ 100 Hz / 20°C	<b>72</b> m $\Omega$	
Tan $\delta$ typ. @ 100 Hz / 20°C	<b>10</b> %	
Z max. @ 10 kHz / 20°C	<b>58</b> m $\Omega$	
ESL typ.	<b>20</b> nH	
Rated Ripple Current ( $I_R$ ) @ 100 Hz / 105 °C	<b>4,6</b> A	
Useful life @ $I_R$ , $U_R$ , 105 °C	<b>8000</b> h	
IEC Climatic category / Standards	<b>40/105/56</b>	<b>IEC 60384-4</b>
Applications		