

**Typ : GHB47206335080**

**RoHS Compliant**

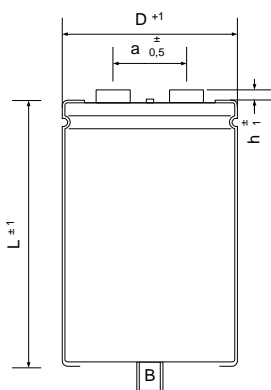

|             |         |
|-------------|---------|
| ∅ D :       | 35 mm   |
| L :         | 80 mm   |
| a :         | 13 mm   |
| h :         | 6 mm    |
| B :         | M8 x 12 |
| Terminals : | M5      |

Max. torque:  
 Terminals: M5: 2,0 Nm, M6: 2,5 Nm  
 Stud: M8: 4,0 Nm, M12: 10,0 Nm

**Electrical Parameters**

|  |                      |                    |
|--|----------------------|--------------------|
| Rated Capacitance ( $C_R$ )<br>@ 100 Hz / 20 °C      | <b>4700</b> $\mu$ F  |                    |
| Tolerance  | <b>-10/ +30</b> %    |                    |
| Rated Voltage ( $U_R$ )                              | <b>63</b> V          |                    |
| Surge Voltage ( $U_S$ )<br>max. 5 x 1 min / h        | <b>72</b> V          |                    |
| Reverse Voltage ( $U_U$ )<br>max. 1 s                | <b>2</b> V           |                    |
| Leakage Current ( $I_L$ )<br>@ $U_R$ / 5 min / 20 °C | <b>1776</b> $\mu$ A  |                    |
| ESR typ.<br>@ 100 Hz / 20°C                          | <b>34</b> m $\Omega$ |                    |
| Tan $\delta$ typ.<br>@ 100 Hz / 20°C                 | <b>10</b> %          |                    |
| Z max.<br>@ 10 kHz / 20°C                            | <b>27</b> m $\Omega$ |                    |
| ESL typ.   | <b>20</b> nH         |                    |
| Rated Ripple Current ( $I_R$ )<br>@ 100 Hz / 105 °C  | <b>5,6</b> A         |                    |
| Useful life<br>@ $I_R, U_R, 105$ °C                  | <b>8000</b> h        |                    |
| IEC Climatic category / Standards                    | <b>40/105/56</b>     | <b>IEC 60384-4</b> |
| Applications   |                      |                    |