

Typ : SZ10145035054

RoHS Compliant

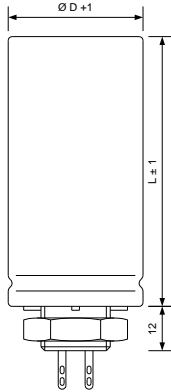

$\varnothing D$: 35 mm
 L : 54 mm

mounting : M18 x 1,5

insulation : PVC
 2500 Vac

Terminals : solder lugs

Electrical Parameters

Rated Capacitance (C_R) @ 100 Hz / 20 °C	100 + 100 μ F	
Tolerance	-10/ +30 %	
Rated Voltage (U_R)	450 V	
Surge Voltage (U_S) max. 5 x 1 min / h	495 V	
Reverse Voltage (U_U) max. 1 s	2 V	
Leakage Current (I_L) @ U_R / 5 min / 20 °C	270 μ A	
ESR typ. @ 100 Hz / 20°C	1592 m Ω	
Tan δ typ. @ 100 Hz / 20°C	10 %	
Z max. @ 10 kHz / 20°C	1237 m Ω	
ESL typ.	30 nH	
Rated Ripple Current (I_R) @ 100 Hz / 85 °C	0,6 A	
Useful life @ $I_R, U_R, 85$ °C	3000 h	
IEC Climatic category / Standards	40/085/56	IEC 60384-4
Applications		