

order number: J02010A0650

waterproof mounting

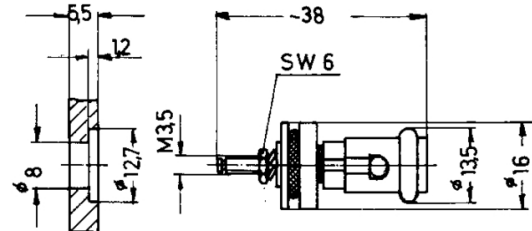

Technical Attributes	
Remarks	waterproof mounting
Nato-No.	5940-00-194-7739; 5940-12-159-7114

Product description

The binding posts KL 58 and KL 65 are quick connection clamping posts mainly used in radio equipments and their accessories.

Mechanical Characteristics	
Depress force KL 58	min. 15 N
Depress force KL 65	min. 15 N
Conductor to be clamped	Ø max. 2.5 mm
Material: contacts	CuZn38Pb1
Material: contact finish	Ni
Material: insulators KL 58	PA
Material: insulators KL 65	PA

Climatic Characteristics	
Tested / classified in accordance with DIN IEC 60068-1	55/070/04

Electrical Characteristics	
Insulation resistance	≥ 100 MΩ

Voltage proof	500 Veff / 50 Hz
Working current KL 58	max. 10 A
Working current KL 65	max. 10 A