

Waterproof Speaker, dia. 87 mm

MODEL: YD87-1-8F60M-G

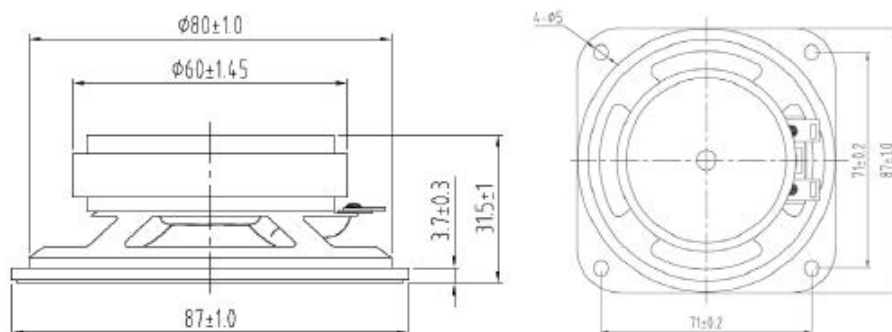

ITEMS	SPECIFICATIONS
1. DIMENSIONS	87 x 87 mm
2. IMPEDANCE	$8 \pm 15\%$ ohm (1 khz 1.0V)
3. INPUT	RATED 10 W , MAX. 15 W
4. LOWEST RESONANT FREQUENCY	430Hz $\pm 20\%$ (1.0 V)
5. SOUND PRESSURE LEVEL	90 ± 3 dB/w (1 w , 1 m) AVERAGE
	AT 0.8 ; 1.0 ; 1.2 ; 1.5 KHz
6. EFFECTIVE FREQUENCY RANGE	FO ~ 7 KHz
7 MAX. INPUT POWER	15 W MUST BE NORMAL AT A WHITE NOISE FOR ONE MIN.
8. OPERATION	10 W
9. DISTORTION FACTOR	< 5% MAX (AT 1.0KHz 0.25W 0.5M)
10. BUZZ & RATTLE TEST	8.94 V FO ~ 7KHz
11. VAS	LITERS
12. POLARITY	WHEN A POSITIVE DC CURRENT IS APPLIED TO THE TERMINAL MARKED +, THE DIAPHRAGM SHALL MOVE FORWARD
13. MAGNET	$\phi 60 \times 10$ mm
14. WEIGHT	Approx. 240g
15. DROP TEST	DROP THE SPEAKER CONTAINED IN NORMAL BOX ONTO A BROAD 5MM THICK 18 TIMES FROM A HEIGHT OF 1 M
16. LOAD TEST	At (10 W) WHITE NOISE IS APPLIED BOX ONTO THE SPEAKER MUST MEET ITEM 10 AFTER TEST
17. HIGH TEMPERATURE TEST	+70°C $\pm 3^\circ$ C 50% R.H. (96 Hr) AND LEFT (1 Hr) IN A ROOM. THE SPEAKER MUST MEET ITEM 4. & 9. AFTER TEST.
18. HUMIDITY TEST	+40°C $\pm 3^\circ$ C 90% R.H. (96 Hr) AND LEFT (1 Hr) IN A ROOM. THE SPEAKER MUST MEET ITEM 4. & 9. AFTER TEST.
19. Operation Temperature	-10 ~ 60°C

Unit: mm

This is a publication by Conrad Electronic SE, Klaus-Conrad-Str. 1, D-92240 Hirschau (www.conrad.com).

All rights including translation reserved. Reproduction by any method, e.g. photocopy, microfilming, or the capture in electronic data processing systems require the prior written approval by the editor. Reprinting, also in part, is prohibited. This publication represents the technical status at the time of printing.

© Copyright 2017 by Conrad Electronic SE.