

Non-insulated Cable Ferrules 0.75mm² x 6 mm, Tinned Copper 100 PCS

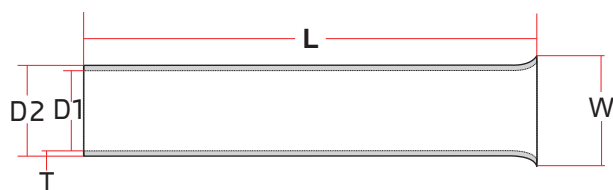

Technical Data:

Material: Copper
 Plating: Tin
 Max. voltage rating: 300V
 Max. temperature rating: 105°C

Wire Guide	Cross Section	Dimension (mm)					Quantity
		L	øD1	øD2	W	T	
20 AWG	0.75 mm ²	6.0±1.0	1.2 ±0.2	1.5 ±0.2	1.9 ±0.2	0.15 ±0.02	100 pcs