

Datasheet

Item no. 1572265



V1_07042018_en

Powered by RICH BAY

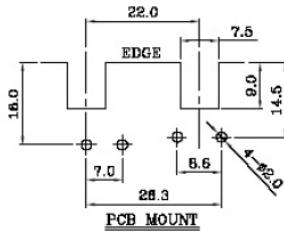
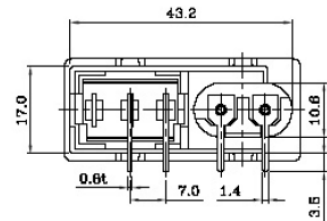
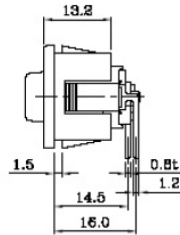
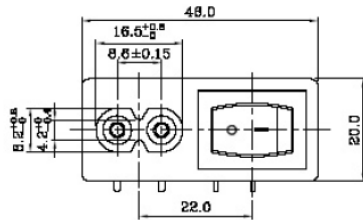
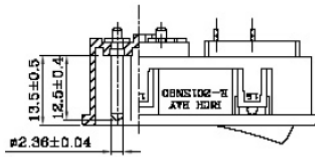
IEC C8 Socket



SPECIFICATION:
 1. Insulation Resistance: Over 100MW at 500V DC.
 2. Dielectric Strength: 2000V AC 1 Minute.
 3. Material: Thermoplastic P4V-2-V-D.

Rating: AC 2.5A 250V	
Mark	Safety Regulation
	VDE
	ENEC
	CULUS

DRAWING: C:\DG\NEW-R\T\201SN90\R-201SN90 (14) 15. DWG

DRAWN BY	APPROVED BY	UNIT	UNIT QTY	SCALE	TOLERANCE	PRODUCT NO.	R-201SN90 (14) 15	REV
		mm	1	1:1	X.XX±0.1 XX.XX±0.2 XXX.XX±0.3			
					DESCRIPTION	NEW NO.		C