

## Specification

1. Rating : 5A 12VDC
2. Withstanding voltage  
AC 500V , 60Hz for 1 minute
3. Insulation resistance(initial)  
100M ohm(min.) at 500 V DC
4. Contact resistance(initial)  
30m ohm max.at AC 100mA(max)1KHZ
5. Insertion & Extraction force  
Initial : 0.3 to 3.0 Kgs  
After life test : 0.2 to 3.0 Kgs
6. Life test(20–30 cycle/minute)  
5,000 cycles unloading

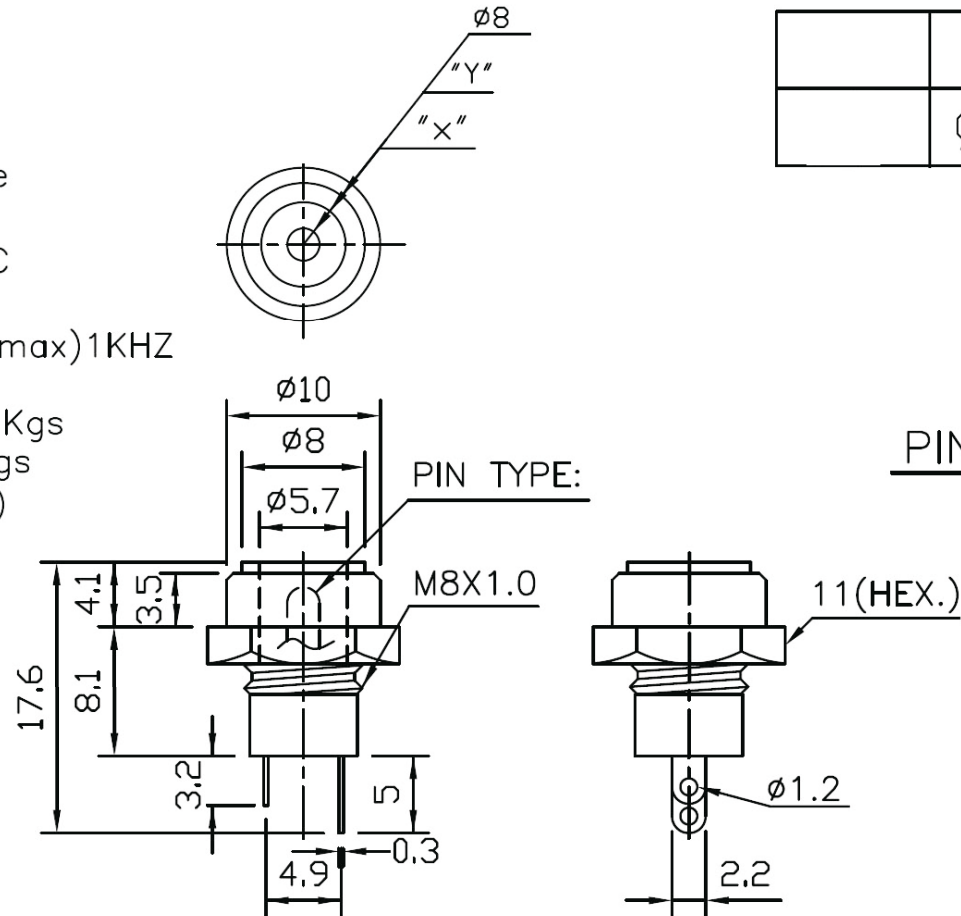
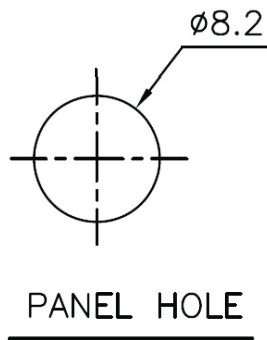

	"X"	"Y"
	$\phi 2.5$	$\phi 5.5$

PIN TYPE