

1. Material:

Contacts: Phosphor Bronze  
 Insulator: PBT+30%G.F UL 94V-0 Black  
 Shell: Brass

2. Mechanical:

Mating Force: 45N max.  
 Withdrawal Force: 7N min.  
 Durability: 500 cycles min.

3. Electrical:

⑥ Current-max[amps] 1.0A  
 voltage-max[volts] 30V  
 Withstanding Voltage 750V AC  
 Contact Resistance[ohms] 30 milliohms max  
 Insulation Resistance[ohms] 1000 Megohms min

4. Plating:

Contacts: Full Gold Flash

5. Environmental

Temperature Range -25°C~ +85°C

⑦ 6. Packing: Tray

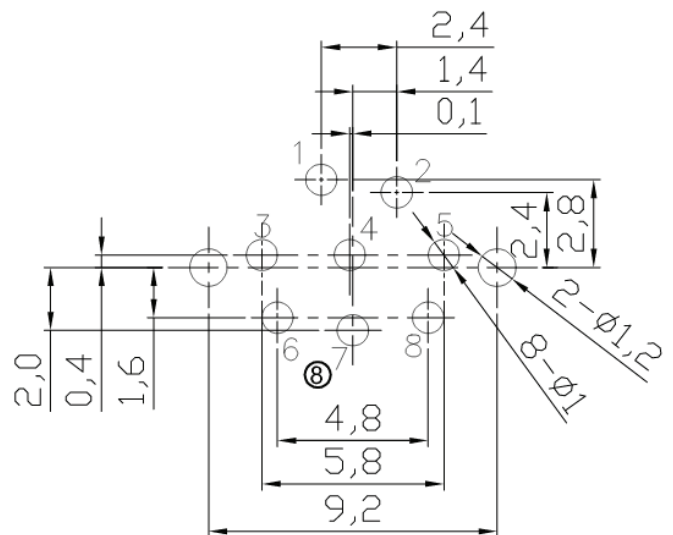

Recommended PCB Layout ⑦  
 Top View Tolerance(±0,05)

**RoHS compliant**

Unit: mm