

Datasheet

Item no. 1586416

V1_0617_02_EN

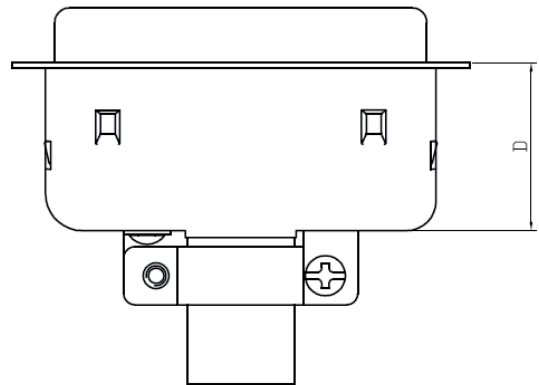
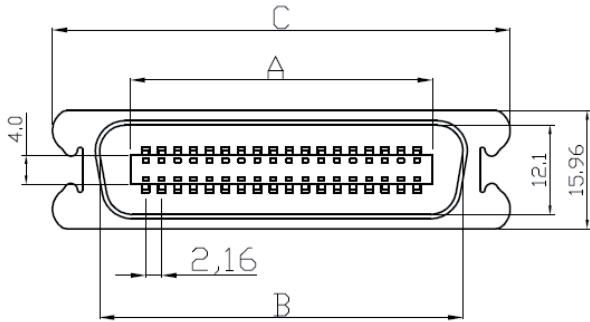

Dimensions

Positions	A	B	C	D
14	17.32	25.50	38.08	21.40

Product Specification

Material

Insulator :Glass-Filled Thermoplastic PBT,UL94V-0 rated, Blue

Contact :Brass , Gold flash selective gold

Shell :Steel, 100u" Tin Over 50u" min Nickel.

Electrical

Contact Resistance :20 milliohms Max at 1 AMP DC.

Insulation Resistance :1000 magohms at 500 VDC

Dielectric Withstanding Voltage :1000 VAC/rms 60Hz for 1 minute

Current Rating :5 AMP

Volatge Rating :250 VAC/rms 60Hz

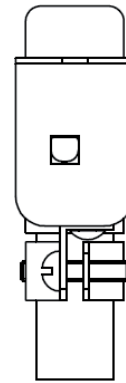

RoHS compliant