

# Datasheet

Item no. 1586423

V1\_0617\_02\_EN

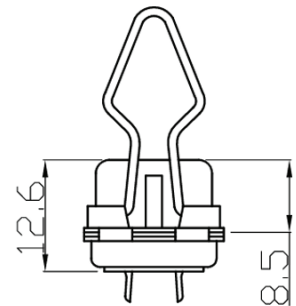
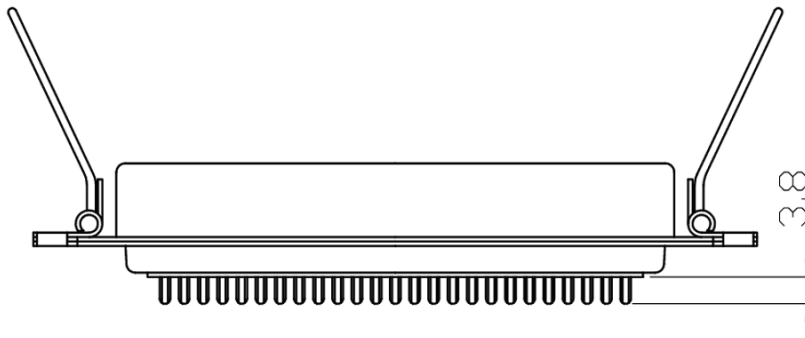
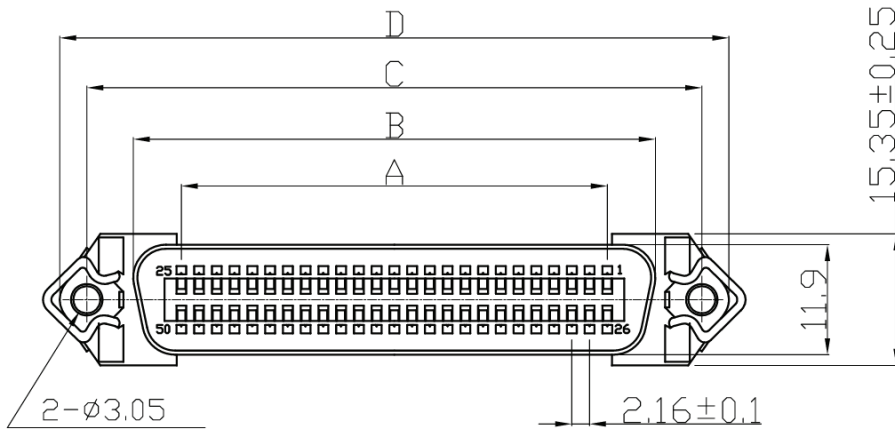

## Dimensions

Positions	A	B	C	D
50	51.84	64.1	74.9	83.0

## Material & finish

SHELL: Steel Zinc plated

PIN CONTACT: Brass Gold flash selective gold plated

INSULATOR: PBT & Glass-fibre reinforced UL 94V-0 Blue

NUMBER OF CONTACT: 14, 24, 36, 50

CURRENT RATING: 5 Amp

DIELECTRIC STRENGTH: 1000V for one minute

INSULATOR RESISTANCE: 1000M Min. (at 500V DC)

TEMPERATURE: -55°C to +105°C

RoHS compliant