

# Datasheet

Item no. 1587905

V1\_0817\_01\_en

## Banana Plug, Blue

Rating	10A
Insulation Resistance	DC 500V 100M ohm Min.
Dielectric Strength	AC 1500V 1 minute
Operation Temperature	-20°C~80°C
Colour	Red, Black (Blue, Yellow, Green)
Operation Voltage	35V DC/AC MAX.

### FEATURES:

1. Material:  
Plug: nickel plated heat treated beryllium copper.  
Handle: nylon.
2. Fits  $\varnothing 4\text{mm}$  banana plug or O.D.less. than  $\varnothing 4\text{mm}$  wire by screw.
3. Sliding sleeve for plug.
4. Fits  $\varnothing 4\text{mm}$  standard banana socket.

### NOTICES:

1. The normal tolerance is  $\pm 0.3$  unless otherwise specified.

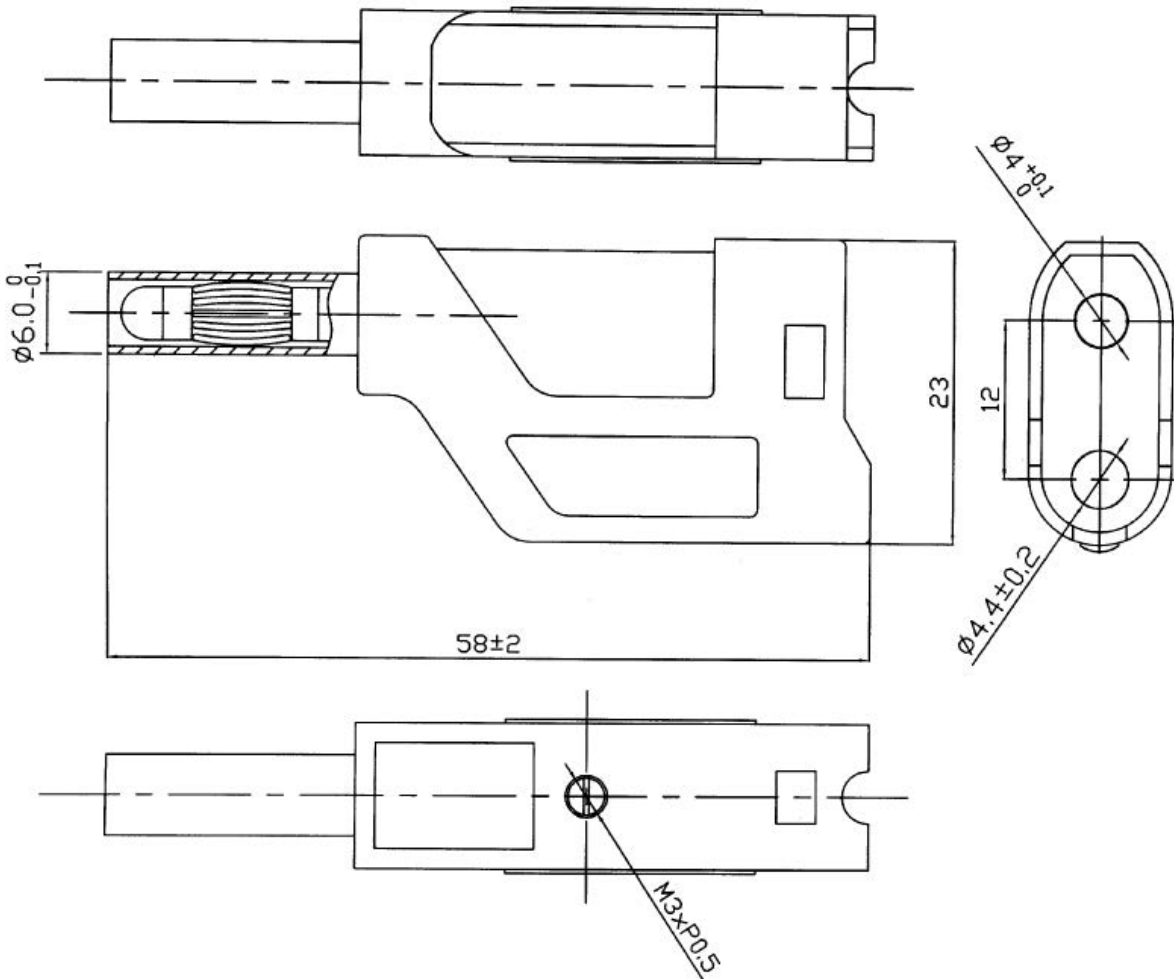

Unit mm

This is a publication by Conrad Electronic SE, Klaus-Conrad-Str. 1, D-92240 Hirschau (www.conrad.com).

All rights including translation reserved. Reproduction by any method, e.g. photocopy, microfilming, or the capture in electronic data processing systems require the prior written approval by the editor. Reprinting, also in part, is prohibited. This publication represents the technical status at the time of printing.

© Copyright 2017 by Conrad Electronic SE.