

In line fuse holder, wire: 12AGW

Rating	30A 12-24V DC	Micro Blade Fuse Dim		Circuit Diagram	
Insulation Resistance	DC 500V 100MΩ Min.				
Dielectric Strength	AC 1000V 1 minute				
Operation Temperature	-20° C~+85° C				
Fuse Specifications	For Micro Blade Fuses Used Only				

Material:
 Body : Black,PVC(T105°C).
 Red LED indicates when fuse is broken.
 Waterproof: IPX6
 None plarity limited.

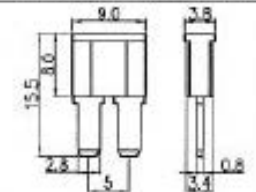
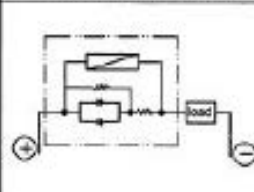
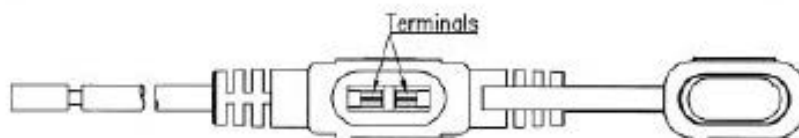
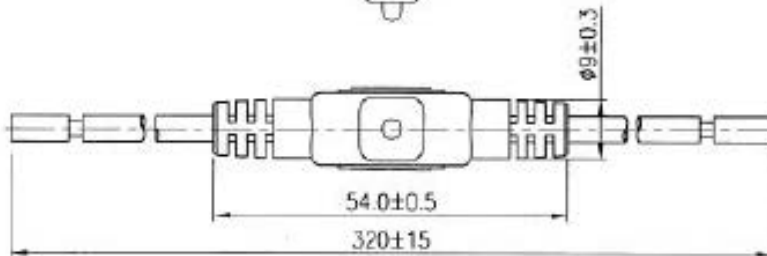
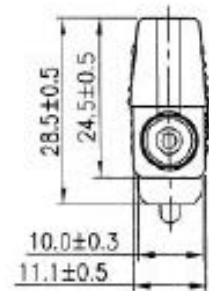
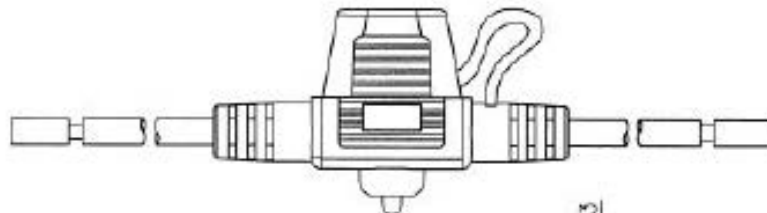
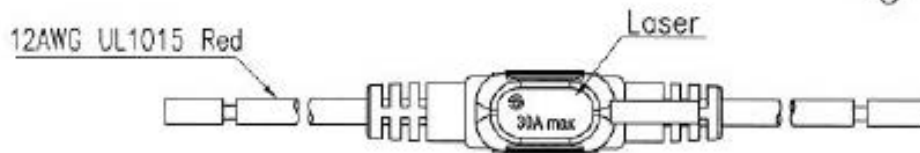
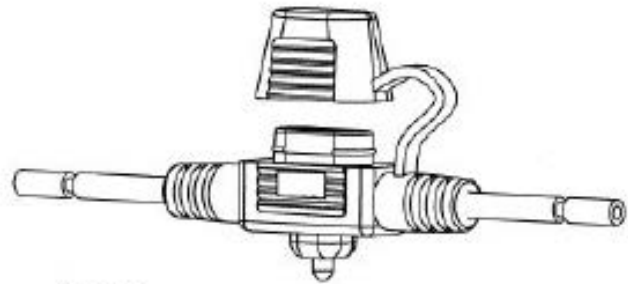

Unit: mm