

# Datasheet

Item no. 1589124, 1589005, 1589285, 1589277, 1589126, 1589278, 1589282, 1589279, 1589283, 1589125, 1589127, 1589280, 1589284, 1589281, 1589006

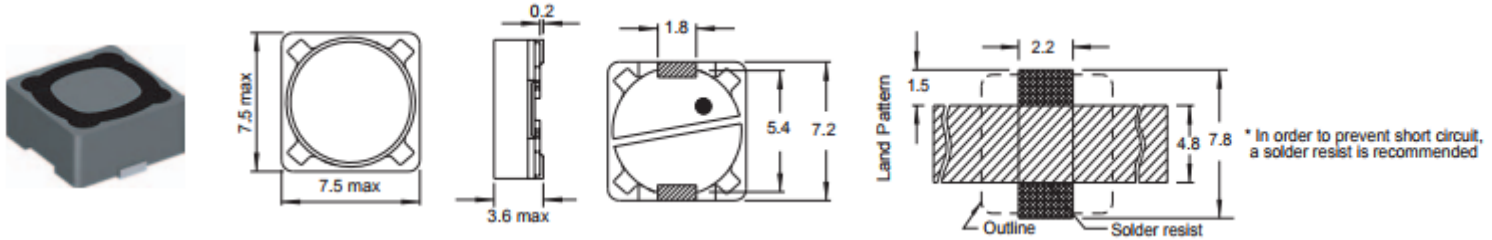

Part No	Inductance L (μH)	f <sub>L</sub> (kHz)	Tol ± (%)	DCR max (mΩ)	Rated DC Current I <sub>SAT</sub> (A)
TC-PIS2812-100M203	10	1	20	72	1.68
TC-PIS2812-101M203	100	1	20	790	0.5
TC-PIS2812-102M203	1000	1	20	9440	0.16
TC-PIS2812-150M203	15	1	20	130	1.33
TC-PIS2812-151M203	150	1	20	1270	0.43
TC-PIS2812-220M203	22	1	20	190	1.07
TC-PIS2812-221M203	220	1	20	1650	0.35
TC-PIS2812-270M203	27	1	20	210	0.96
TC-PIS2812-271M203	270	1	20	2310	0.32
TC-PIS2812-330M203	33	1	20	240	0.91
TC-PIS2812-331M203	330	1	20	2620	0.28
TC-PIS2812-470M203	47	1	20	360	0.76
TC-PIS2812-471M203	470	1	20	4180	0.24
TC-PIS2812-680M203	68	1	20	520	0.61
TC-PIS2812-681M203	680	1	20	5730	0.19

Material: Ferrite

Typical L vs Frequency(f)

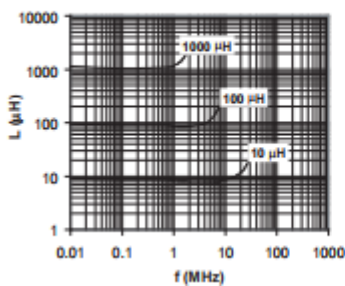

Typical L vs Current

