



IXARC Absolute Rotary Encoder

OCD-DPC1B-1416-B060-H3P



Interface

Interface	Profibus DP
Profile	DPV0, DPV1 and DPV2 Class 2 (EN50170 + EN50254)
Diagnostics	Memory
Programming Functions	Resolution, gearing factor (physical resolution) , velocity scaling + filter, preset (zero point), counting direction, limit switches , node number, teach-in, diagnosis
Manual Functions	Address selector switch 0-99 and terminal resistor (with connection cap)
Features	Round Axis
Transmission Rate	≤12 Mbaud
Interface Cycle Time	≥ 1 ms

Outputs

Output Driver	Profibus Data Interface, galvanically isolated via opto-couplers
---------------	--

Electrical Data

Supply Voltage	10 - 30 VDC
Current Consumption	≤ 115 mA @ 10 V DC, ≤ 50 mA @ 30 V DC
Power Consumption	≤ 1.5 W
Start-Up Time	< 1 s

Data Sheet

Printed at 27-09-2017 15:09

POSITAL

FRABA



Reverse Polarity Protection	Yes
Short Circuit Protection	Yes
EMC: Emitted Interference	DIN EN 61000-6-4
EMC: Noise Immunity	DIN EN 61000-6-2
MTTF	13.5 years @ 40 °C

Sensor

Technology	Optical
Resolution Singleturn	16 bit
Resolution Multiturn	14 bit
Multiturn Technology	Mechanical Gearing (no Battery)
Accuracy (INL)	$\pm 0.0220^\circ$ (14 - 16 bit), $\pm 0.0439^\circ$ (≤ 13 bit)
Code	Binary

Environmental Specifications

Protection Class (Shaft)	IP65
Protection Class (Housing)	IP65
Operating Temperature	-40 °C (-40 °F) - +85 °C (+185 °F)
Storage Temperature	-40 °C (-40 °F) - +85 °C (+185 °F)
Humidity	98% RH, no condensation

Mechanical Data

Connection Cap Material	Aluminum
Housing Material	Steel
Housing Coating	Wet coating (RAL 9006 White Aluminium) + Cathodic corrosion protection (>720 h salt spray resistance)
Flange Type	Blind Hollow, \varnothing 58 mm (B)
Flange Material	Aluminum
Shaft Type	Blind Hollow, Depth = 30 mm
Shaft Diameter	\varnothing 6 mm (0.24")
Shaft Material	Stainless Steel V2A (1.4305, 303)
Rotor Inertia	$\leq 30 \text{ gcm}^2$ [$\leq 0.17 \text{ oz-in}^2$]
Friction Torque	$\leq 3 \text{ Ncm}$ @ 20 °C (4.2 oz-in @ 68 °F)
Max. Permissible Mechanical Speed	$\leq 12000 \text{ 1/min}$
Shock Resistance	$\leq 100 \text{ g}$ (half sine 6 ms, EN 60068-2-27)
Permanent Shock Resistance	$\leq 10 \text{ g}$ (half sine 16 ms, EN 60068-2-29)

Data Sheet

Printed at 27-09-2017 15:09

POSITAL

FRABA



Vibration Resistance	≤ 10 g (10 Hz - 1000 Hz, EN 60068-2-6)
Length	99 mm (3.90")
Weight	510 g (1.12 lb)

Electrical Connection

Connection Orientation	Radial
Connection Type	3 x Cable Gland
Connection Cap Type	Removable for easy replacing encoder without new installation of cable, Rotary switches with visible node number, No active components, Terminal resistor switch cut the outgoing bus too, Big spring clips

Certification

Approval	CE + cULus listed, Industrial Control Equipment
Product Life Cycle	Established

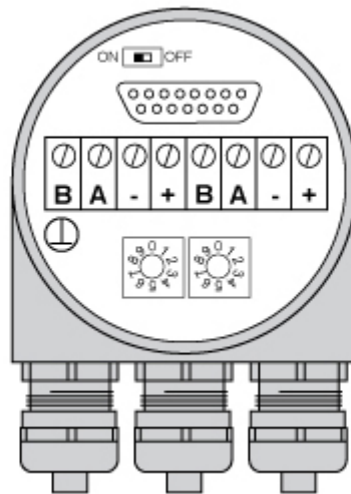

Connection Plan

SIGNAL	PIN NUMBER
Bus line B (Bus in)	B
Bus line A (Bus in)	A
GND	-
Power Supply	+
Bus line B (Bus out)	B
Bus line A (Bus out)	A
GND	-
Power Supply	+

Data Sheet

Printed at 27-09-2017 15:09



Connector-View on Encoder

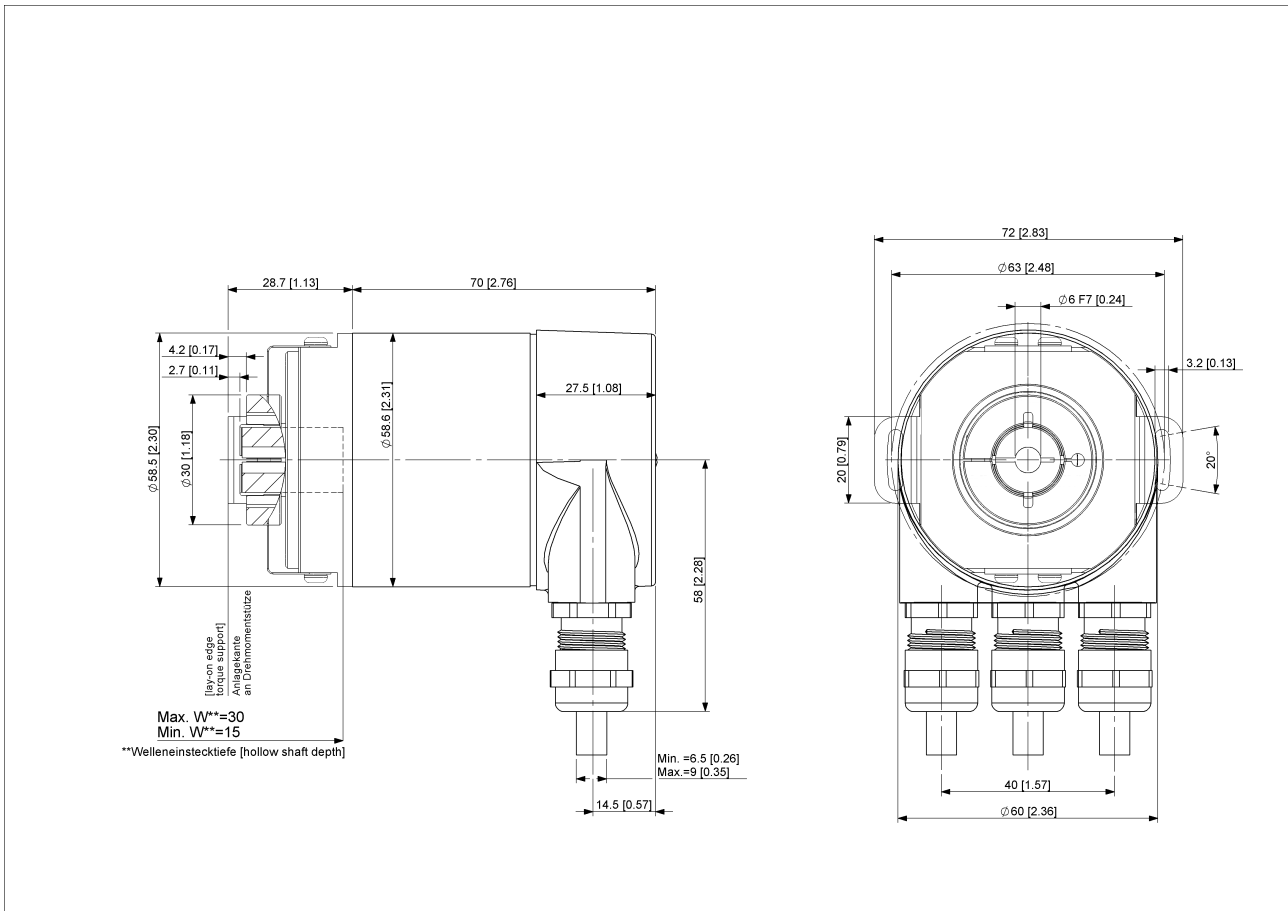

[2D Drawing](#)

Accessories

Clamping Ring B15

Contact



POSITAL
Contact Us

POSITAL

FRABA



The picture and drawing are for general presentation purposes only. Please refer to the "Download" section for detailed technical drawings. All dimension in [inch] mm. © FRABA B.V., All rights reserved. We do not assume responsibility for technical inaccuracies or omissions. Specifications are subject to change without notice.