



IXARC Absolute Rotary Encoder

OCD-PPA1G-0016-SB90-PAT



Interface

| | |
|------------------|---|
| Interface | Bit Parallel |
| Manual Functions | Counting direction via cable or connector |

Outputs

| | |
|---------------|-----------|
| Output Driver | Push-Pull |
|---------------|-----------|

Electrical Data

| | |
|-----------------------------|--|
| Supply Voltage | 10 - 30 VDC |
| Current Consumption | $\leq 400 \text{ mA @ } 10 \text{ V DC}, \leq 180 \text{ mA @ } 24 \text{ V DC}$ |
| Power Consumption | $\leq 1.5 \text{ W}$ |
| Start-Up Time | $< 250 \text{ ms}$ |
| Settling Time | 80 ms |
| Reverse Polarity Protection | Yes |
| Short Circuit Protection | Yes |
| EMC: Emitted Interference | DIN EN 61000-6-4 |
| EMC: Noise Immunity | DIN EN 61000-6-2 |
| MTTF | 22.3 years @ 40 °C |

Sensor

| | |
|-----------------------|---------|
| Technology | Optical |
| Resolution Singleturn | 16 bit |

POSITAL

FRABA



| | |
|------------------------|--|
| Accuracy (INL) | ±0.0220° (14 - 16 bit), ±0.0439° (≤13 bit) |
| Sense Signal (Default) | Clockwise shaft movement (front view on shaft) |
| Code | Gray |

Environmental Specifications

| | |
|----------------------------|------------------------------------|
| Protection Class (Shaft) | IP65 |
| Protection Class (Housing) | IP65 |
| Operating Temperature | -40 °C (-40 °F) - +85 °C (+185 °F) |
| Humidity | 98% RH, no condensation |

Mechanical Data

| | |
|--|--|
| Housing Material | Steel |
| Housing Coating | Cathodic corrosion protection (>720 hrs salt spray resistance) |
| Flange Type | Synchro, ø 58 mm (S) |
| Flange Material | Aluminum |
| Shaft Type | Solid, Single Flat, Length = 20 mm |
| Shaft Diameter | ø 10 mm (0.39") |
| Shaft Material | Stainless Steel V2A (1.4305, 303) |
| Max. Shaft Load | Axial 40 N, Radial 110 N |
| Minimum Mechanical Lifetime (10 ⁸ revolutions with Fa/Fr) | 420 (20 N / 40 N), 145 (40 N / 60 N), 100 (40 N / 80 N), 55 (40 N / 110 N) |
| Rotor Inertia | ≤ 30 gcm ² [≤ 0.17 oz-in ²] |
| Friction Torque | ≤ 3 Ncm @ 20 °C (4.2 oz-in @ 68 °F) |
| Max. Permissible Mechanical Speed | ≤ 12000 1/min |
| Shock Resistance | ≤ 100 g (half sine 6 ms, EN 60068-2-27) |
| Permanent Shock Resistance | ≤ 10 g (half sine 16 ms, EN 60068-2-29) |
| Vibration Resistance | ≤ 10 g (10 Hz - 1000 Hz, EN 60068-2-6) |
| Length | 45,7 mm (1.80") |
| Weight | 300 g (0.66 lb) |

Electrical Connection

| | |
|------------------------|-------------------|
| Connection Orientation | Axial |
| Connector | M27, Male, 26 pin |

Certification

| | |
|----------|---|
| Approval | CE + cULus listed, Industrial Control Equipment |
|----------|---|



Connection Plan

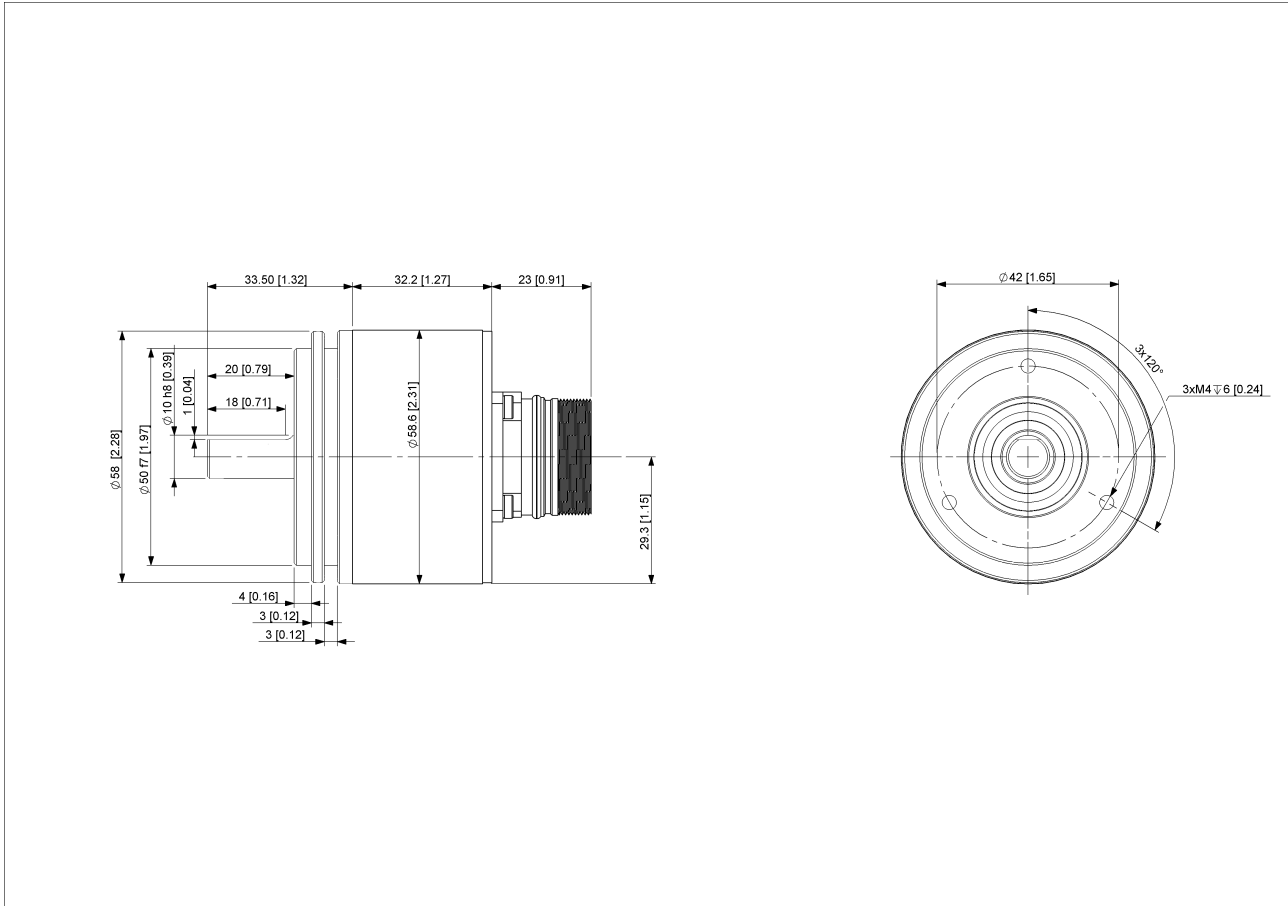

[2D Drawing](#)

Accessories

Connectors & Cables

10m PVC Cable, 26pin, f

5m PVC Cable, 26pin, f

20m PVC Cable, 26pin, f

15m PVC Cable, 26pin, f

2m PVC Cable, 26pin, f

M27, 26pin, Female

[More](#)

Clamp Disc w/ Eccentric Hole-4pcs

Clamp Disc w/ Centred Hole-4pcs

[Data Sheet](#)

Printed at 27-09-2017 16:09



Coupling Disc Type-10-12
Coupling Bellow Type-10-10
Coupling Bellow Type-06-10
Coupling Bellow Type-08-10
Coupling Bellow Type-10-12
Coupling Bellow Type-10-(1/4")
Coupling Bellow Type-10-(3/8")
Coupling Jaw Type-08-10
Coupling Jaw Type-10-12
Coupling Jaw Type-10-(1/4")
Coupling Jaw Type-10-(3/8")
Coupling Jaw Type-10-10
Coupling Disc Type-06-10
Coupling Disc Type-10-10
More

Mounting Bracket for Synchro Flange w/ fixtures

Contact



POSITAL
Contact Us

The picture and drawing are for general presentation purposes only. Please refer to the "Download" section for detailed technical drawings. All dimension in [inch] mm. © FRABA B.V., All rights reserved. We do not assume responsibility for technical inaccuracies or omissions. Specifications are subject to change without notice.