

circuit breaker VL400 UL; type JG (cat no. NJX3B250) non-interchangeable frame, with circuit breaker approval acc. to UL 489 standard breaking capacity 3-pole, NEMA rating 35kA/480V, (molded case circuit breaker) Electronic Trip Unit TM, LI TA=40°C In=< 250A, rated current II=1250...2500A short-circuit protection IR=250A Electronic Trip Unit for line protection without connection accessories without auxiliary release without auxiliary/alarm switch

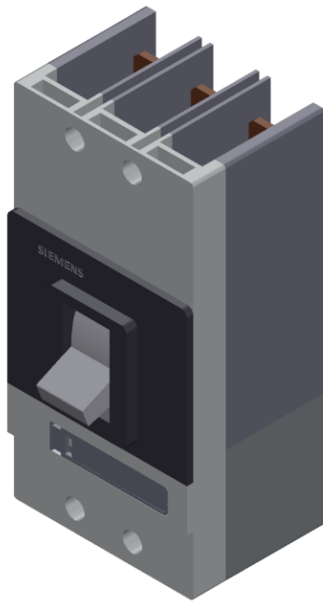

Model	
Type of the driving mechanism / motor drive	No
Design of the overcurrent release	TM
General technical data	
Number of poles	3
Size of the circuit-breaker	3VL4 UL
Electrical endurance (switching cycles) / typical	10 000

Usage category	A
Performance class for circuit breaker	N
Mechanical service life (switching cycles) / typical	20 000
Reference code / acc. to DIN 40719 extended according to IEC 204-2 / acc. to IEC 750	Q
Operating frequency / maximum	120 1/s

Voltage

Rated operational voltage U_e / max.	690 V
Insulation voltage	
• rated value	800 V
• at AC / rated value	800 V
Surge voltage resistance / rated value	8 kV
Operating voltage	
• rated value / maximum	690 V
• for main current circuit / at AC / at 50 Hz / acc. to UL 489 / maximum	600 V
• for main current circuit / at AC / at 50 Hz / maximum	690 V
• for main current circuit / at AC / at 60 Hz / acc. to UL 489 / maximum	600 V
• for main current circuit / at AC / at 60 Hz / maximum	690 V

Protection class

Protection class IP	IP20
Protective function of the overcurrent release	LI

Current

Operating current / at 45 °C / rated value	232.5 A
Continuous current / rated value	250 A
Derating temperature / for the rated value of the continuous current	50 °C
• acc. to UL 489	40 °C
Adjustable pick-up value current	
• of the current-dependent overload release / Full-scale value	250 A
• of instantaneous short-circuit trip unit / initial value	1 250 A
• of instantaneous short-circuit trip unit / Full-scale value	2 500 A

Main circuit

Operating frequency	
• 1 / rated value	50 Hz
• 2 / rated value	60 Hz

Operating current	
<ul style="list-style-type: none"> • at 40 °C / rated value 	250 A
<ul style="list-style-type: none"> • at 50 °C / rated value 	232.5 A
<ul style="list-style-type: none"> • at 55 °C / rated value 	215 A
<ul style="list-style-type: none"> • at 60 °C / rated value 	215 A

Auxiliary circuit	
Number of CO contacts / for auxiliary contacts	0
Number of NC contacts / for auxiliary contacts	0
Number of NO contacts / for auxiliary contacts	0

Suitability	
Suitability for use	system protection

Adjustable parameters	
Adjustable pick-up value current / of the current-dependent overload release / initial value	250 A

Product details	
Product component	
<ul style="list-style-type: none"> • Trip indicator 	No
<ul style="list-style-type: none"> • Auxiliary switch 	No
<ul style="list-style-type: none"> • Voltage trigger 	No
<ul style="list-style-type: none"> • undervoltage release 	No
<ul style="list-style-type: none"> • undervoltage release with leading contact 	No
Product extension / optional / motor drive	Yes

Product function	
Product function	
<ul style="list-style-type: none"> • of thermal overload trip unit 	fixed
<ul style="list-style-type: none"> • Ground fault protection 	No
<ul style="list-style-type: none"> • for neutral conductors / Short-circuit and overload proof 	No
<ul style="list-style-type: none"> • Overload protection 	Yes

Short circuit	
Operational short-circuit current breaking capacity (Ics)	
<ul style="list-style-type: none"> • at 240 V / rated value 	65 kA
<ul style="list-style-type: none"> • at 415 V / rated value 	45 kA
<ul style="list-style-type: none"> • at 690 V / rated value 	6 kA
Maximum short-circuit current breaking capacity (Icu)	
<ul style="list-style-type: none"> • at 240 V / rated value 	65 kA
<ul style="list-style-type: none"> • at 415 V / rated value 	45 kA
<ul style="list-style-type: none"> • at 480 V / acc. to NEMA / rated value 	35 kA
<ul style="list-style-type: none"> • at 600 V / acc. to NEMA / rated value 	25 kA

• at 690 V / rated value

12 kA

Connections

Arrangement of electrical connectors / for main current circuit	front side
Type of electrical connection / for main current circuit	without connection accessoires

Mechanical Design

Height	279.5 mm
Width	139.5 mm
Depth	163.5 mm
Mounting type	fixed mounting
<ul style="list-style-type: none"> during operation during storage 	0 ... 70 °C -40 ... +80 °C

Certificates

Certificate of suitability	UL standard switching capacity (N), non-interchangeable
Reference code	Q
<ul style="list-style-type: none"> acc. to DIN EN 61346-2 	

General Product Approval

EMC

Declaration of Conformity



CCC



CSA

[Miscellaneous](#)



UL



C-Tick



EG-Konf.

Test Certificates

Shipping Approval

other

[Special Test Certificate](#)



RMRS

[Confirmation](#)

[Environmental Conformations](#)

[Miscellaneous](#)

[Manufacturer Declaration](#)

Further information

Information- and Downloadcenter (Catalogs, Brochures,...)

<http://www.siemens.com/lowvoltage/catalogs>

Industry Mall (Online ordering system)

<https://mall.industry.siemens.com/mall/en/en/Catalog/product?mlfb=3VL4125-1KN30-0AA0>

Service&Support (Manuals, Certificates, Characteristics, FAQs,...)

<https://support.industry.siemens.com/cs/ww/en/ps/3VL4125-1KN30-0AA0>

Image database (product images, 2D dimension drawings, 3D models, device circuit diagrams, ...)

http://www.automation.siemens.com/bilddb/cax_en.aspx?mlfb=3VL4125-1KN30-0AA0

CAX-Online-Generator

<http://www.siemens.com/cax>

Tender specifications

<http://www.siemens.com/specifications>

