

!!! Phased-out product !!! The preferred successor is 3RQ2000-2BW00. Coupling relays in industrial enclosure 2 change-over contacts Combination voltage 24 V and 110-120 V AC/DC Spring-type terminal



Figure similar

Product brand name	SIRIUS
Product designation	Coupling relay in industrial enclosure
Product type designation	3RS18

General technical data	
Protection class IP	IP20
Switching behavior	monostable
Reference code acc. to DIN 40719 extended according to IEC 204-2 acc. to IEC 750	K
Reference code acc. to DIN EN 81346-2	K
Reference code acc. to DIN EN 61346-2	K
Control supply voltage 1 at AC	
• at 50 Hz rated value	24 V
• at 50 Hz	110 ... 120 V
• at 60 Hz rated value	24 V
• at 60 Hz	110 ... 120 V
Control supply voltage 1	
• at DC rated value	24 V

Design of the relay operating mechanism	poled
Product component Plug-in socket	No

#### Auxiliary circuit

Number of NC contacts for auxiliary contacts	0
Number of NO contacts for auxiliary contacts	0
Number of CO contacts	
• for auxiliary contacts	2

#### Main circuit

Type of voltage	AC/DC
-----------------	-------

#### Outputs

Ampacity of the output relay at AC-15	
• at 250 V at 50/60 Hz	3 A
Ampacity of the output relay at DC-13	
• at 24 V	1 A
• at 125 V	0.2 A

#### Connections/ Terminals

Type of electrical connection	spring-loaded terminals
-------------------------------	-------------------------

#### Installation/ mounting/ dimensions

Mounting type	screw and snap-on mounting onto 35 mm standard mounting rail
Height	94 mm
Width	22.5 mm
Depth	91 mm

#### Certificates/ approvals

General Product Approval	Declaration of Conformity	Test Certificates
--------------------------	---------------------------	-------------------



[Miscellaneous](#)

[Type Test Certificates/Test Report](#)

Test Certificates	other
-------------------	-------

[Miscellaneous](#)

[Confirmation](#)

#### Further information

Information- and Downloadcenter (Catalogs, Brochures,...)  
[www.siemens.com/sirius/catalogs](http://www.siemens.com/sirius/catalogs)

**Industry Mall (Online ordering system)**

<https://mall.industry.siemens.com/mall/en/en/Catalog/product?mlfb=3RS1800-2BQ00>

**Cax online generator**

<http://support.automation.siemens.com/WW/CAXorder/default.aspx?lang=en&mlfb=3RS1800-2BQ00>

**Service&Support (Manuals, Certificates, Characteristics, FAQs,...)**

<https://support.industry.siemens.com/cs/ww/en/ps/3RS1800-2BQ00>

**Image database (product images, 2D dimension drawings, 3D models, device circuit diagrams, EPLAN macros, ...)**

[http://www.automation.siemens.com/bilddb/cax\\_de.aspx?mlfb=3RS1800-2BQ00&lang=en](http://www.automation.siemens.com/bilddb/cax_de.aspx?mlfb=3RS1800-2BQ00&lang=en)

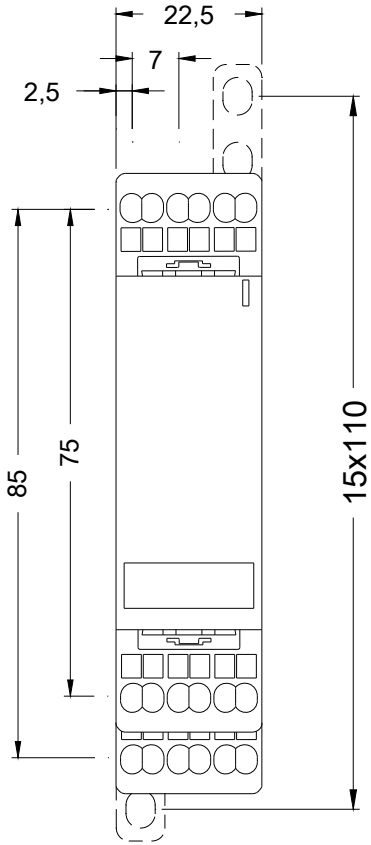

last modified:

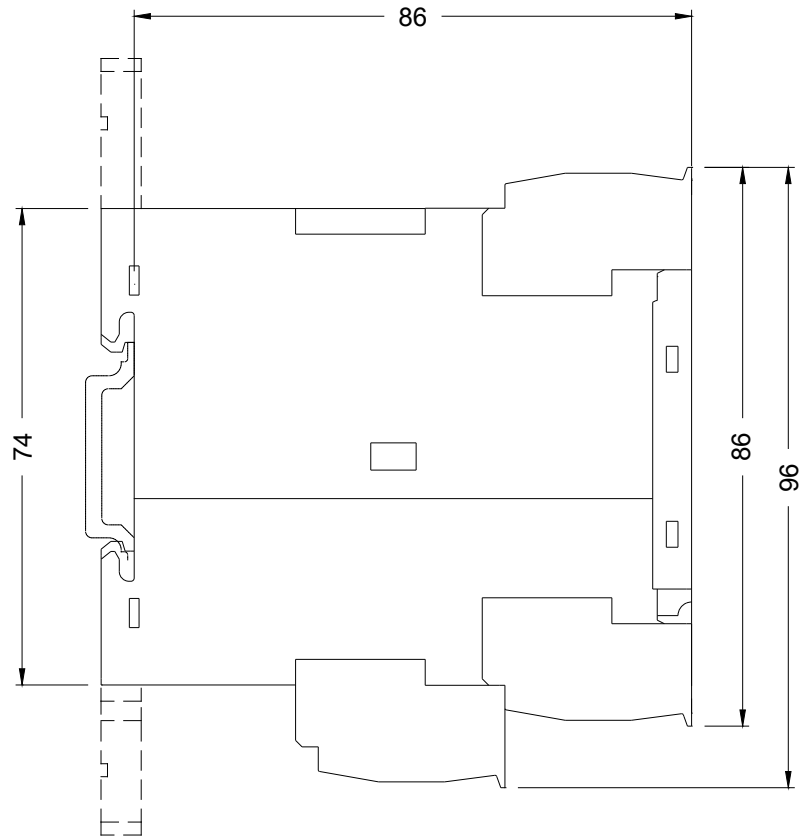

09/04/2019